

Homeowners Guide

用户手册

VEIL INTELLIGENT TOILET WH

维亚智能坐便器挂墙版

K-30085T-0,K30085T-XP-0

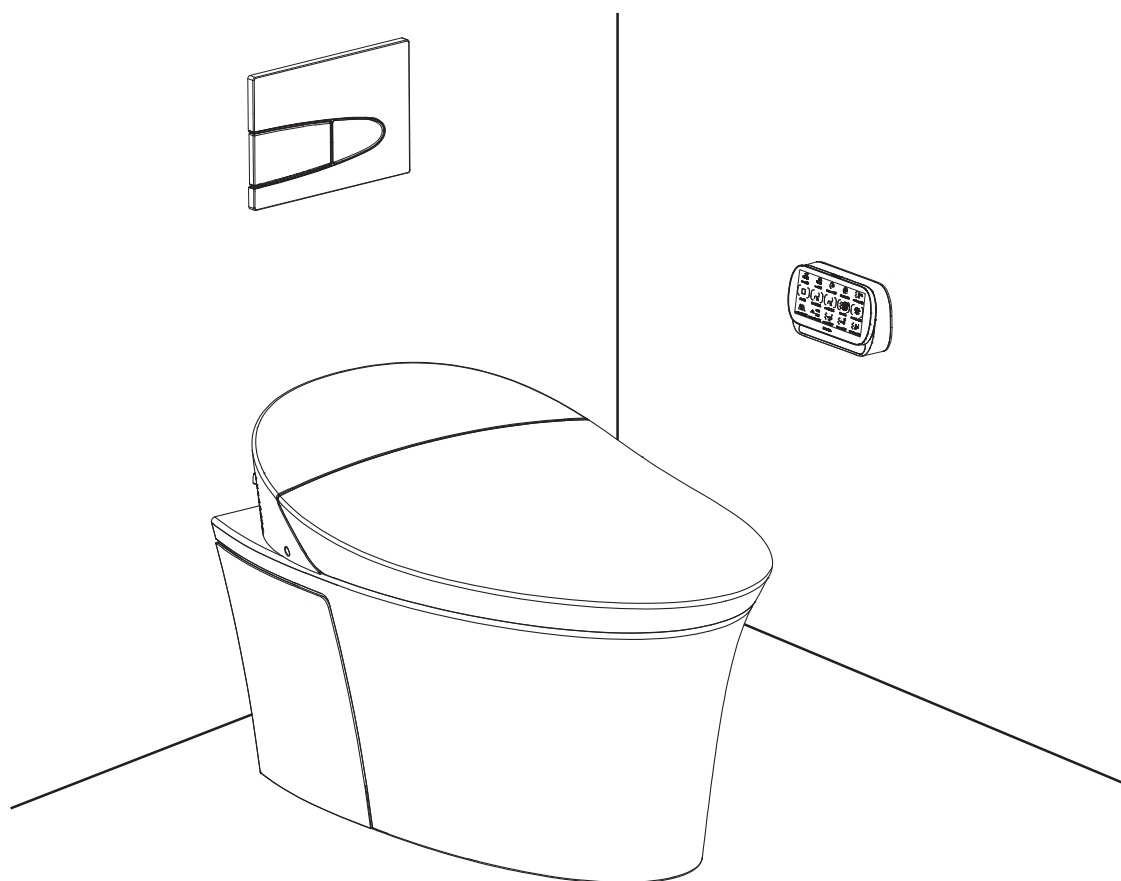

科勒（中国）投资有限公司

中国上海市静安区江场三路158号 邮编：200436

制造商：上海科勒电子科技有限公司

中国上海市宝山区丰翔路1955号 邮编：200444

English page 2-22

中文页码 23-43

1542305-T5-B

THE BOLD LOOK
OF **KOHLER**®

CATALOGUE

Cautions and Warnings.....	3
Specification.....	5
Thank you for Choosing Kohler Company.....	6
Toilet Schematic	6
Remote guide.....	7
Remote setting guide.....	8
Preparation before Initial Use.....	10
Open, close Cover/Open, Close Seat.....	11
Toilet Flush.....	12
Side Panel Function	14
UV Sterilization Function	14
Sterilized water.....	15
Auto Energy Saving Function	15
Deodorizer.....	15
Service and Clean.....	15
Trouble-shooting.....	20
Description of Content of Hazardous Substances in Product	22

Cautions and Warnings

Please read the cautions and warning carefully and observe accordingly.

- ☐ In case the power cord is damaged; to avoid danger, product should be replaced by the manufacturer or the professionals from its maintenance department or similar departments.
- ☐ Minimum water inlet pressure is 0.07MPa(dynamic), Maximum water inlet pressure is 0.74MPa.
- ☐ Please use the water supply hose accompanying with new machine. The old hose assembly shall not be used again.
- ☐ This product must be installed safely. Connect only to dedicated 220V~, 50Hz, 10A circuit protected by Ground-Fault Circuit-Interrupters (GFCI's) or Earth-Leakage Circuit-Breakers (ELCB's).



Warning

 **Warning:** any misuse from ignoring the content of this label may cause serious injury or death.

- ☐ The installation should be subject to the instructions before the power is connected.
- ☐ **Do not use any hard setting material (cement mortar) while installing the toilet.** Thermal expansion of hard setting material (cement mortar) will damage or crash the feet of toilet. Kohler will not be responsible for any damage because of using hard setting material (cement mortar) for toilet installation.
- ☐ **Risk of product damage.** Do not throw into the toilet what that will cause the toilet to block such as newspapers and sanitary towel. Do not bump the vitreous china with great force as it will cause damage and leaking.
- ☐ **Risk of electric shock or product damage.** Do not immerse the product into water.
- ☐ **Risk of product damage.** The power shall not be connected before the work is finished. Otherwise it may lead to product failure.
- ☐ When an electrical product is used, especially when children are near, the following basic safety precautions shall be followed:
 - Danger-Reduce risk from electric shock:**
 - Do not place or store this device where it can fall or be dropped into a bath or sink.
 - Do not place in or drop into water or other liquid.
 - Do not make any contact with the product drop into the water, unplug immediately.
- ☐ Do not operate this device if following occasions occurred: damaged cord or plug; if it is not working properly or if it has been dropped into water.
- ☐ Keep power cord far from heated surface.
- ☐ Prevent water splash on power plug.



Note

 **Note:** any misuse from ignoring the content of this label may cause personal injury or product damage.

- ☐ The remote control is only allowed to operate the device within the line of sight of the toilet.
- ☐ **Risk of product damage.** Do not install at a place where it may be splashed by water.
- ☐ **Risk of product damage.** Do not install the product at a place with excessive humidity, where moisture may condense at the surface of the product. Please maintain that the usage environment is under adequate ventilation, so as to prevent damage to electronic components.
- ☐ **Risk of product damage or property loss.** Water leakage may happen if the water pipe connector is pulled or pressed with excessive force.
- ☐ **Risk of product damage.** The product may be damaged if the nozzle is applied with excessive force.
- ☐ **Risk of product damage.** The part of the pipe where water may be frozen should be protected by thermal insulation. Any water left in the product may be frozen during the winter season. Please keep the product in room temperature before reinstallation or usage.

Cautions and warning (cont.)

- ☐ The thermal protector may be out of order during storage or transportation in warm climate which can lead to product failure. Please ensure the product cools to room temperature before reinstallation or usage.

WARNING - To reduce the risk of low grade burns, electric shock, fire or injury to persons:

- Children, elders or those with disabilities from their body, sensitivity or mental disabilities or lacking of common sense should not use or get close to this product unless under close tutelage. Children are not allowed to use or touch this product. Do not leave children alone in a room with such product.
 - For those children and the elderly who are unable to adjust the temperature, they should ask for help to adjust seat temp, water temp and wind temp of toilet cover to proper gears.
 - Prevent any exposed skin contact with heated seat too long to prevent low temperature burning.
- ☐ This device complies with the method described in the manual. Do not use attachments not recommended by Kohler Co. such as angle valve etc.
 - ☐ Do not lean on cover when use this device to prevent product from damage.
 - ☐ Following the installation procedure and install the product properly.
 - ☐ This product shall be repaired by professionals only. The warranty will become invalid if you try to repair this product by yourself.
 - ☐ When install the product in the room, a stop valve shall be installed in a close proximity. For emergency circumstances, the water inlet valve shall be stopped without using any tools; otherwise unexpected failure may cause the loss to the customer.
 - ☐ Do not drop or insert any substance to pipeline or any opening holes.
 - ☐ Do not use this product outdoor or in a place where a particle mist spray device is used, neither at a place using oxygen supply.
 - ☐ UV sterilization devices should be installed and maintained by qualified servicemen.
 - ☐ When user cut power supply off, if reactivation of power supply is required, please wait until the end of
 - ☐ “beep.....” indication, and then turn on power supply again.
 - ☐ Stop using product if any of the circumstances observed below. Shut power off and stop water inlet valve immediately.
 - Water hose and internal water leak from inside out.
 - When product is cracked or damaged.
 - When abnormal sound or obvious odour appears.
 - Product smokes.
 - Abnormal product heating problem.
 - ☐ Do not charge non-rechargeable battery.
 - ☐ For chargeable battery, remove battery from appliance before charging.
 - ☐ Remove used battery from appliance and dispose properly.
 - ☐ Remove battery if appliance is going to store for a long term.
 - ☐ No short circuit on power supply terminal.
 - ☐ Prevent remote control from splash water.

SPECIFICATION				
Flush volume		Average 4.6L, Full flush 5.8L, Flush ECO 4.0L		
Water efficiency grade*		Level 2		
Water pressure		Min water pressure 0.07M Pa (dynamic pressure) Max water pressure 0.74M Pa		
Rated voltage		220V~, 50Hz		
Rated power*		1090W		
Product outline dimension		About 675mm x 438mm x 533mm		
Weight of product		About 42kg		
Inlet water temp		1-35°C		
Operation Environment		1-40°C		
Cleaning	Rear wash		YES, adjustable	
	Spiral wash		YES, adjustable	
	Front wash		YES, adjustable	
	Water flow (water pressure 0.2MPa)		Max rear wash shall be no less than 500mL/min	
	Adjust cleaning water temp		OFF, adjustable 5 dials (ambient temp, about 31-39°C)	
	Cleaning time (Max)		About 300s	
	Adjustment of nozzle position		5 dials	
	Impulse massage		ON/OFF	
	Oscillation cleaning		ON/OFF	
	Safety device	Water temp overheat protection		Thermal fuse
		Back-flow preven		Check valve, Vacuum Breaker
Comfort	Thermal	Temp adjustment		OFF, adjustable 5 dials
		Safety device		Thermal fuse
	Cover		Auto OPEN/CLOSE, slow falling, remote OPEN/CLOSE	
	Seat		Slow falling, remote OPEN/CLOSE	
	Dryer	Temp adjustment		OFF, adjustable 5 dials
		Safety devices		Thermal fuse
	Deodorizing function		Yes	
Remote controller		Function setting refer to page 8~9		
Sanitary	Self-cleaning of nozzle		Yes	
	Antibacterial materials		Cover and Seat	
	Sterilized water		Yes	
	UV sanitize		Yes	
Other functions	Other safety devices		Circuit-Breakers	
	Auxiliary keyboard		Yes	
	Seat sensing		Located inside the seat	
	Night light		Yes, The night light is only used for internal lighting of the toilet.	
	Auto Lid OPEN/CLOSE		Microwave detection	
	Manual flush		Yes	
IOT Function		K-30085T-XP-0(YES), K-30085T-0(NO)		
In-wall tank dimension (L*W*D)		About 1228mm × 560mm × 80mm		
Flush control board dimension (L*W)		About 215mm × 150mm		
Concealed water tank driving method		Manual + Auto		
Flush control board color		Soft frost		
Flush control board LED light color		Blue		
Concealed water tank water inlet connector spec		G 1/2"		
Bearing capability		Max. 400kg		
Adjustable wall thickness		About 8 - 69mm		
* The description of water efficiency label marked on intelligent toilet: water efficiency label represents a compliance mark of the water efficiency grade etc. performance of intelligent toilet.				
* Power value testing condition: dynamic pressure 0.2MPa, inlet water temp 15°C.				
The above parameters are for the full-functional version. For differences in the specifications of models, refer to their product configuration matrix.				

Thank You For Choosing Kohler Company

Thank you for choosing Kohler. Kohler craftsmanship offers you a rare combination of proven performance and graceful sophistication that will satisfy you for years to come. The dependability and beauty of your Kohler product will surpass your highest expectations. We're very proud of our products here at Kohler and we know you will be too.

Please take a few minutes to study this Homeowners Guide. Pay special attention to the care and cleaning instructions.

All information in this manual is based upon the latest product information available at the time of publication. At Kohler, we constantly strive to improve the quality of our products. We reserve the right to make changes in product characteristics, packaging, or availability at any time without notice.

Toilet Schematic

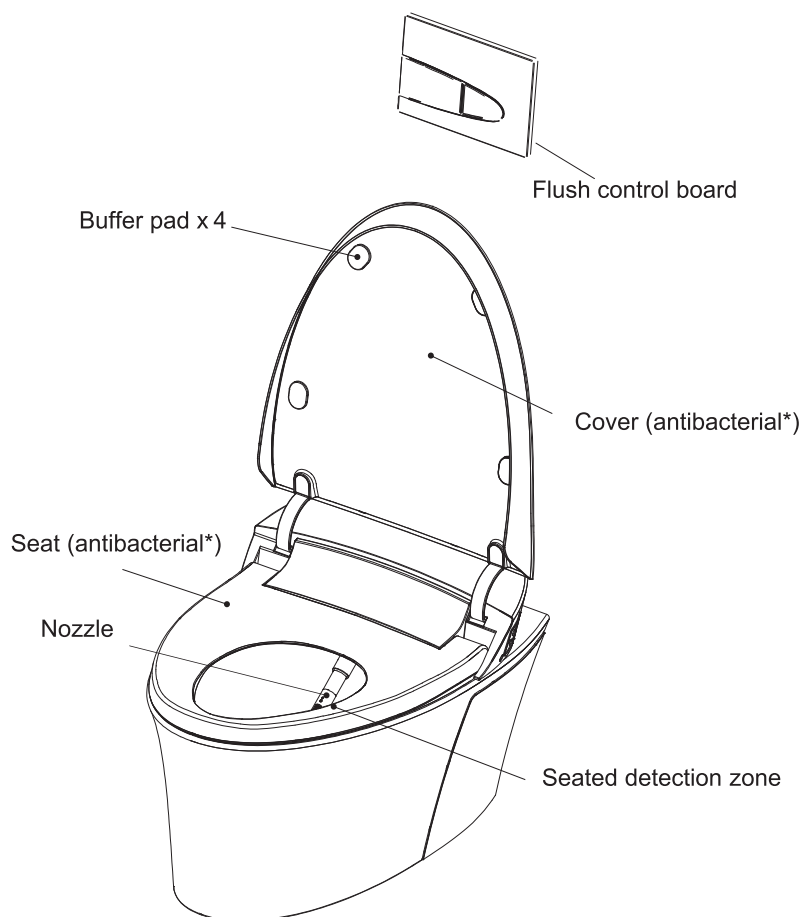

* Antibacterial: the seat and cover contains long term inorganic anti-bacteria material which will inhibit bacteria growth on surface, this does not represent the mildew and other incidental effects. The antibacterial rate is more than 90%. (Perform test in accordance with GB21551.2-2010 requirements. Testing lab: China household electrical appliances testing institute; electromechanical products testing technology center of Shanghai Entry-Exit inspection and quarantine bureau.)

REMOTE GUIDE

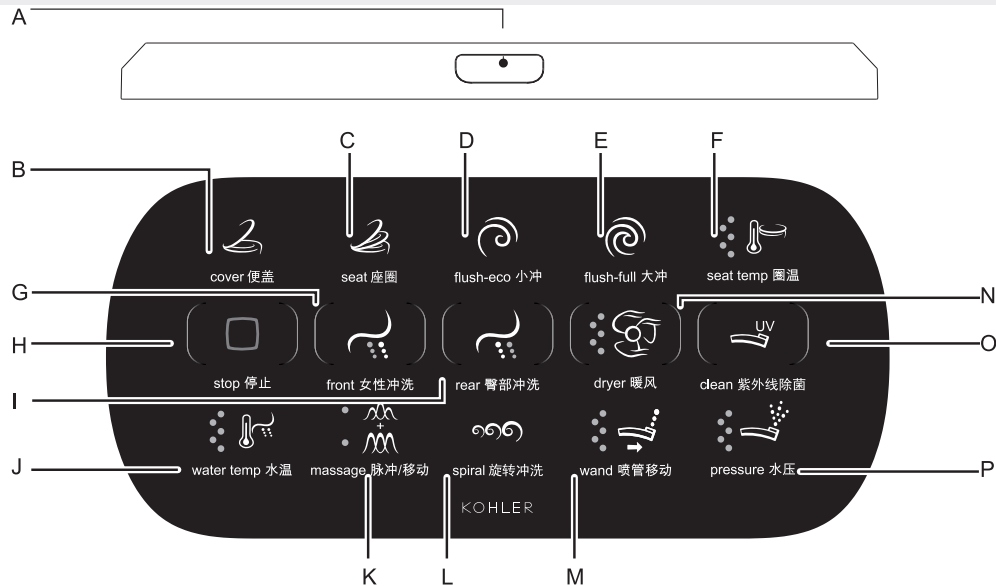

Warning: to prevent from falling down, please take remote from docking station before press the ON button.

A – Activate toilet

Press this button to activate toilet by remote. Perform ON/OFF screen switch from this button after activation.

If it is not connected to toilet after activation, the 3rd row icons will flash; icons stop flash after successful connection. Enter activation mode.

B – Lid OPEN/CLOSE

Press this button to perform cover ON/OFF action under unseated status.

C - Ring OPEN/CLOSE

Press this button to perform seat ON/OFF action under unseated status.

D – Flush ECO

Press this button to perform ECO flush operation.

E – Flush Full

Press this button to perform full flush operation.

F – Seat Temp

Press this button to adjust seat temperature, when 5 blue dots stop blinking indicate seat heating function is OFF.

G – Front Wash

Press this button to enter front wash when seated. Auto stop after about 5min or turn off immediately when press the OFF button.

H – Stop

- Press this button to stop front wash, rear wash, dryer and deodorizer, manual wand clean and UV etc. functions.
- Pressing and holding this button to turn off remote.

I – Rear Wash

Press this button to enter rear wash when seated. Auto stop after about 5min or turn off immediately when press the OFF button.

J – Water temp

Press this button to adjust water temp dial when front wash or rear wash is activated.

K – Massage

Press this button to enter oscillate when front wash or rear wash is activated; press this button again to enter pulsate; press this button the 3rd time, perform oscillate/pulsate simultaneously; press this button the 4th time to exit this mode (left side icon LED on for corresponding functions).

L – Spiral Wash

Press this button to enter spiral wash during rear wash, spiral icon blink. Press this button again to exit spiral wash (or press “STOP” button to turn off), spiral icon stop blinking.

M – Wand Move

Press this button to adjust wand move position.

N – Dryer

Press this button the 1st time to activate dryer function after seated; press this button again to adjust dryer dials. Auto stop after about 4 min or turn off immediately when press the OFF button.

O – UV Sterilization

Press this button to enter UV sterilization function under unseated status. Icon blink.

P – Water Pressure

Press this button to adjust water pressure dials when front wash or rear wash activated.



Low-voltage Warning

Note: please charge immediately after voltage warning.

- When  button blink, indicate remote internal battery will be exhausted, charging remote is required.

Pairing

Note: Pairing process shall only be performed when unseated.

- Press remote top ON button to activate toilet when cover is under normal powered on status. When bottom row of icons blink for a long time which indicate remote need pairing process.
- Hold remote dryer button, after bottom row of icons quick blinking, toilet operation starts.
- Hold toilet  button and  button on side panel, release button when heard one short beep.
- When the bottom row of icons on remote stop blinking, indicate successful pairing.

Remote to Toilet Communication

- When remote move out from detection area, bottom row of icons on remote will auto flush (indicating searching toilet signal).When move back to toilet detection area, if toilet is powered on and under normal operation, signal will be auto connected, icon will stop blinking after successful connection.

Stop Function

- Whenever pressing and holding  button, remote shall enter stop mode.

Remote Setting Guide

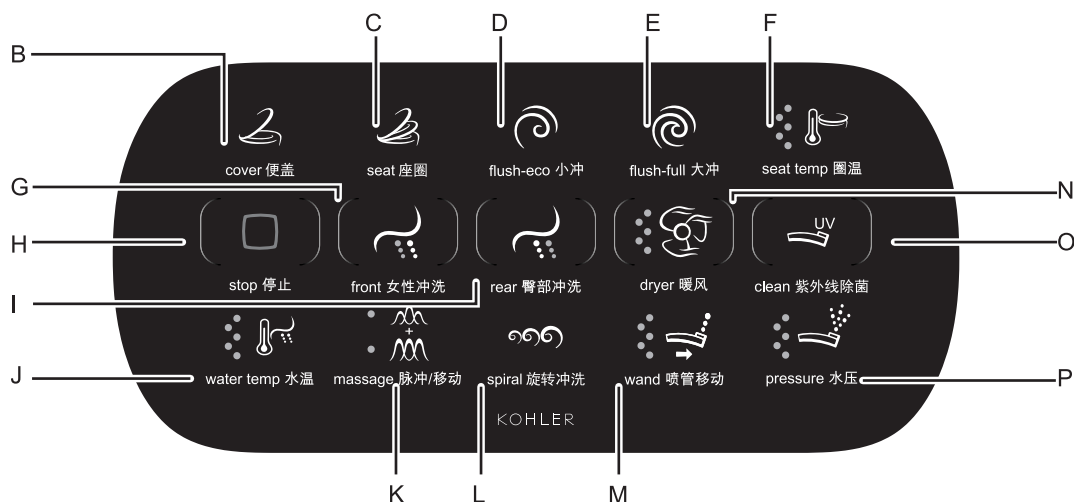

Pressing and holding toilet  button until heard one short beep, night light blink 3 times simultaneously, release button, then change settings according to below B/C/E/F/O.

B – Cover OPEN/CLOSE ...detection distance setting

- Holding and pressing this button to set auto cover detection distance
 1. Night light quick blink once is close distance (short beep)
 2. Night light quick blink twice is middle distance (short beep)
 3. Night light quick blink three times is far distance (short beep)
 4. Night light slow blink once to turn off auto cover open function (long beep).

C – Seat OPEN/CLOSE ...deodorizing function setting

- Holding and pressing this button to set deodorizer function ON/OFF status
 1. Night light quick blink once indicate deodorizer functions is ON (short beep)
 2. Night light slow blink once indicate deodorizer functions is OFF (long beep)

E – Flush full... auto flush setting

- Holding and pressing this button to set auto flush function ON/OFF status.
 1. Night light quick blink once to activate auto flush function (short beep)
 2. Night light slow blink once to deactivate auto flush function (long beep)

F – Seat temperature...energy saving setting

- Holding and pressing this button to set energy saving function ON/OFF status.
 1. Night light quick blink once to activate energy saving function (short beep)
 2. Night light slow blink once to deactivate energy saving function (long beep).

O – UV sterilization (UV light)... UV auto sterilization setting

- Holding and pressing this button to set auto sterilization function ON/OFF status.
 1. Night light quick blink once to activate auto sterilization function (short beep)
 2. Night light slow blink once to deactivate auto sterilization function (long beep)

Before change B/C/E/F/O setting after a certain time frame, holding and pressing  button on toilet side panel until one short beep, night light blink 3 times.

M – Wand move ... wand clean setting

- Holding and pressing manual clean wand function under unseated status, wand extend, perform manual clean on nozzle, holding and pressing this button again or press STOP button to deactivate this function.

Remote Battery Usage and Exchange

- Remote docking station uses 4 pieces of AA alkali batteries.
- When battery is low, red LED blinking on docking station, indicates customer to change battery.
- **Note**
 1. Batteries +/- poles shall be oriented as shown on the diagram on remote.
 2. Do not mix new and old batteries.
 3. Please use alkali batteries.

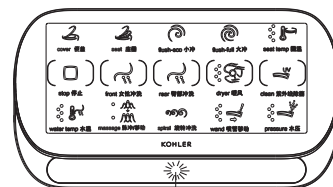

Red light blink

Others

- ☐ Do not put the remote control at a place where it may be sprayed by liquid, or immersed in liquid.
- ☐ Do not place it near hand dryer, hair dryer and small size home appliances, to avoid disturbance of normal usage of the remote control.
- ☐ Do not apply external force to the key zone of remote controller frequently or fiercely.
- ☐ After usage of remote control, put it back into the holder mounted on wall.
- ☐ Prevent dropping the remote control during usage.
- ☐ Anti-loss function: lock remote on docking station by screws. Specific method refers to installation instruction.

Preparation before Initial Use

Connect to power
supply Connect to water
inlet valve

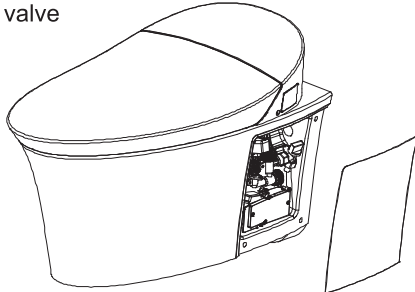

Power switch
ON status
(indicating LED
ON)

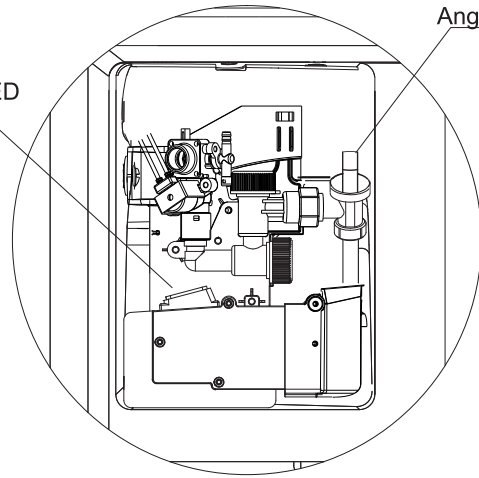

Angle valve OFF

- ☐ Ensure if water inlet valve is OPEN.
- ☐ Confirm power switch and inlet valve is OPEN by open side panel.
- ☐ Confirm "remote" battery is installed correctly.
- ☐ Confirm no obstruction in front of the product.
- ☐ When power is ON, wait until toilet complete self checking. It is normal that motor rotation and water flow sound generated and night light blinking during process. When night light stop blinking, self-checking complete.
- ☐ Ex-work status setting for initial use:

<p>Front wash:</p> <ul style="list-style-type: none"> • Water temp: mid • Water flow: mid • Wash position: 3rd dial <p>Rear wash:</p> <ul style="list-style-type: none"> • Water temp: mid • Water flow: mid • Washing position: 3rd dial <p>Spiral:</p> <ul style="list-style-type: none"> • Water temp: mid • Water flow: mid • Washing position: 3rd dial 	<p>Seat temp: mid</p> <p>Wind temp: mid</p> <p>Night light: ON</p> <p>Energy saving: OFF</p> <p>Auto cover swing function: ON; distance: mid</p> <p>Auto flush function: ON</p> <p>Auto UV function: ON</p> <p>Electrolyzed water function: ON</p> <p>Deodorizing: ON</p>
---	---

Cover/Seat OPEN/CLOSE Function

A Cover OPEN/CLOSE

- Auto cover OPEN/CLOSE

When cover is CLOSE, user enters sensor area, cover auto open.

When cover is OPEN, user leave sensor area, cover auto close after a period of time.

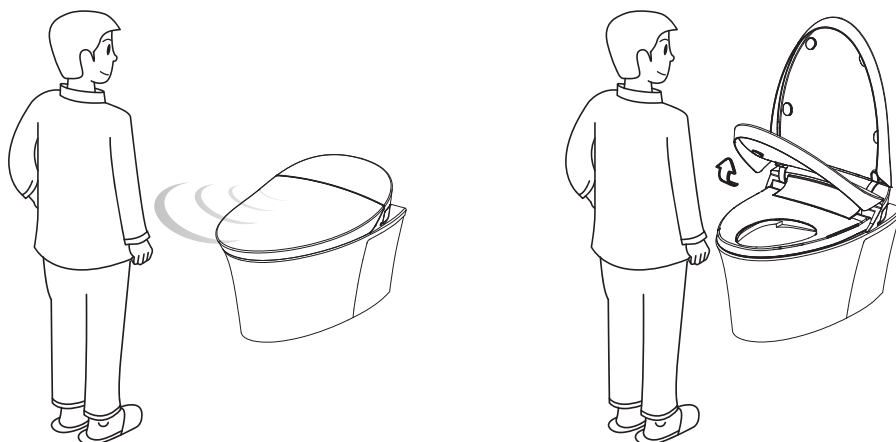

- OPEN/CLOSE cover by remote

Press cover OPEN/CLOSE button on remote when unseated, perform corresponding OPEN/CLOSE function. (Details refer to remote button sketch). Invalid operation when press  button on remote under seated status.

- Manual Cover OPEN/CLOSE

Cover shall be OPEN/CLOSE manually. When customer open/close cover normally, cover shall be able to auto open/close based on the movement trend. Do not apply force on cover at all time. Cover shall auto stop when encounter with the obstruction during movement.

Note:

1. When customer enter detection zone slowly, cover OPEN/CLOSE distance might be shorter. Please use remote or manual cover OPEN/CLOSE if still no response.
2. Auto cover OPEN/CLOSE function shall only be valid when remote "cover OPEN/CLOSE setting" is "ON". (Refer to page 9 Setting Method).
3. Do not set movable obstruction 40cm in front of toilet front end; cover might auto OPEN if there is movable obstructions. Refer to page 9 for eliminating "auto cover OPEN/CLOSE" function.

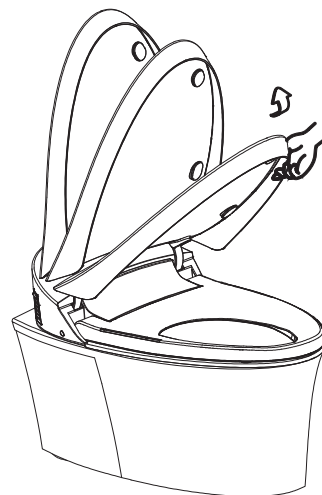

B Seat OPEN/CLOSE

- OPEN/CLOSE ring by remote

Press seat OPEN/CLOSE button on remote when unseated, perform corresponding OPEN/CLOSE function. (Details refer to remote button sketch). Invalid operation when press  button on remote under seated status.

• Manual Swing Seat

Seat shall be OPEN/CLOSE manually. When customer open/close seat normally, seat shall be able to auto open/close based on the movement trend. Do not apply force on seat at all time. Seat shall auto stop when encounter with the obstruction during movement.

Note:

During cover and seat OPEN/CLOSE process, do not apply excessive force on cover or seat; any man-made interference on cover or seat during auto OPEN/CLOSE process is not allowed.

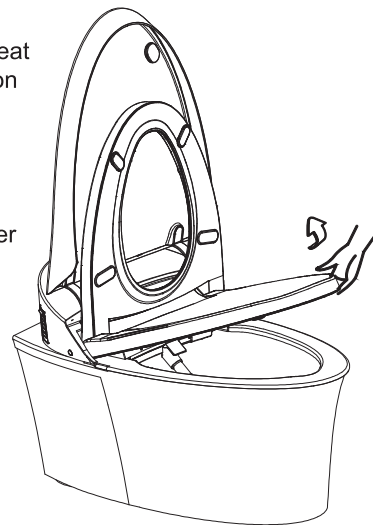

Toilet Flush

A. Auto flush function usage

a) Seated status

When seat is OPEN and toilet is in use. Toilet will auto flush after unseated for a certain time. Close seat within a period of time.

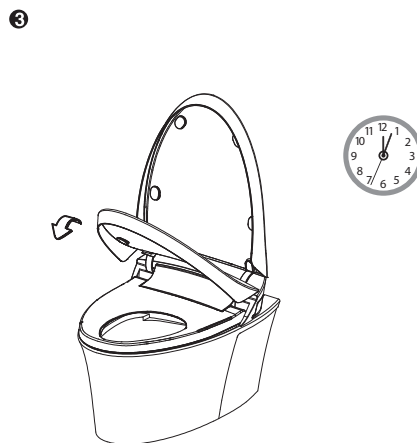
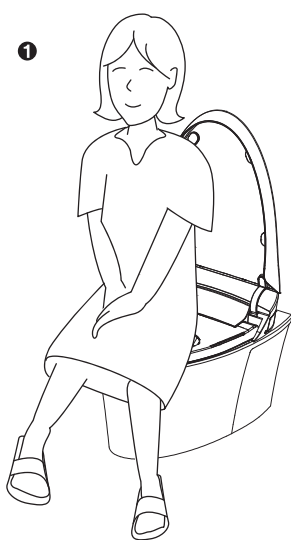

b) For man urine

When seat is OPEN, open seat manually or by remote; Toilet will auto flush after unseated for a certain time. Auto close seat/cover after a period of time.

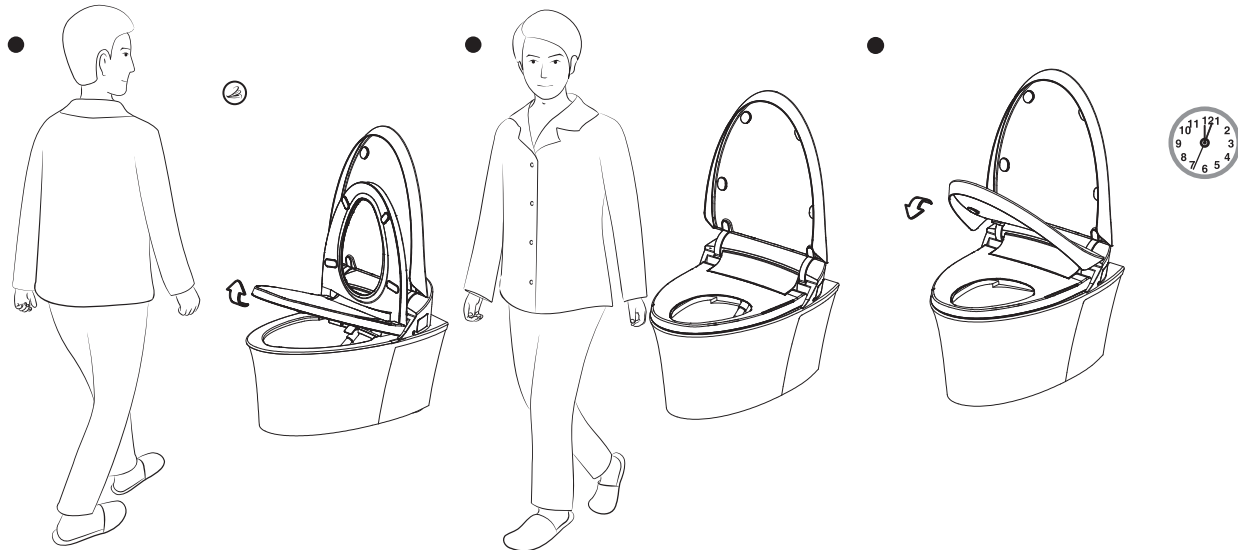

Note:

1. Customer shall be able to use remote to control flush water or manual flush water, or use basin to flush the toilet if auto flush function is OFF.
2. Auto flush function shall be effect when remote "flush setting" is "ON" (Refer to Page 9 setting method).

B. Flush controlled by remote

Customer shall be able to perform toilet flush function by pressing flush FULL or ECO button on remote.

Note: remote flush function shall not execute twice before complete flushing process .

C. Flush by manual pressing

When power is OFF, auto flush is deactivated, press manual flush button on flush control board:

Left button: flush full
Right button: flush ECO

Side Panel Function

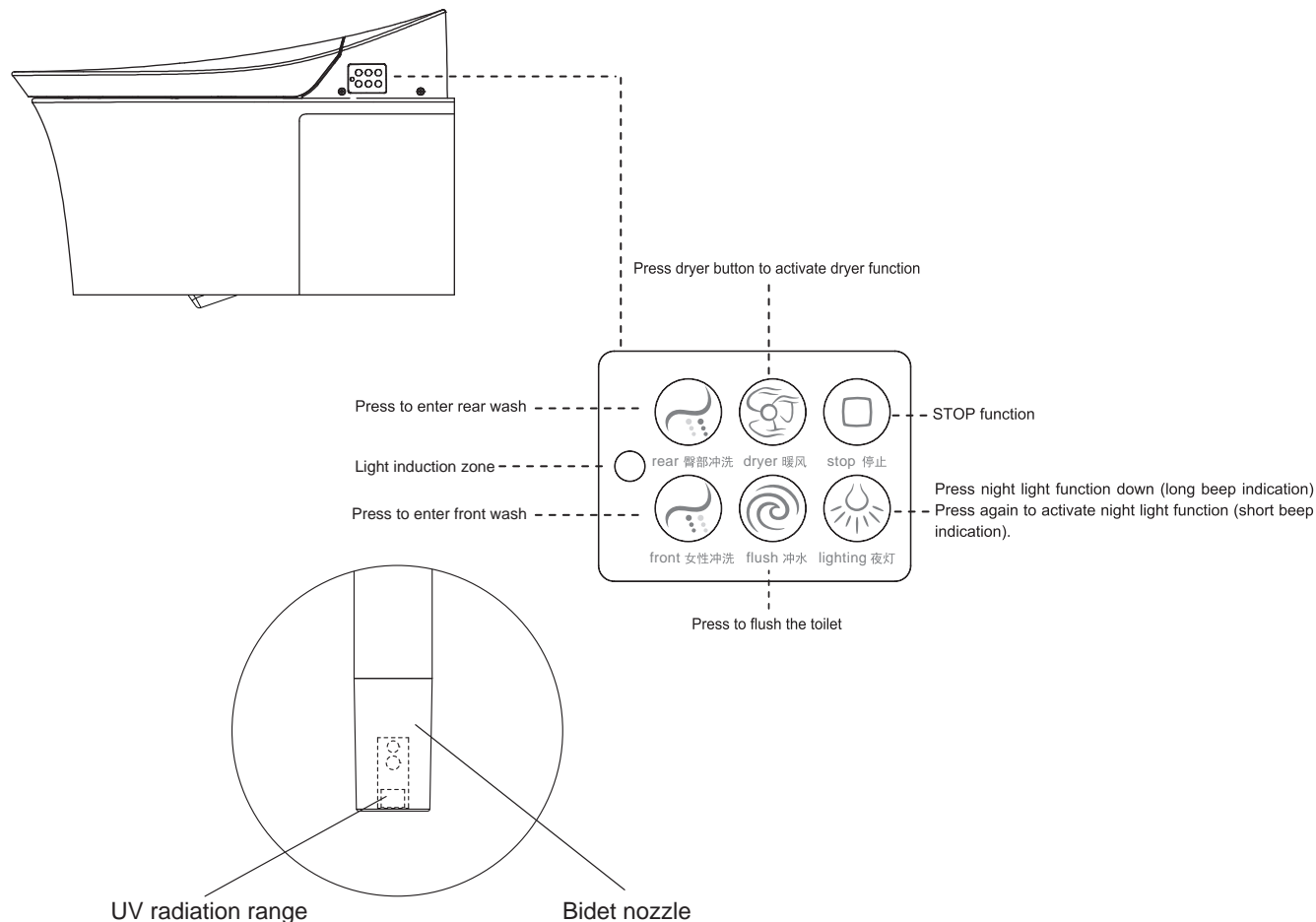

Note:

1. Each function shall perform ex-work setting. Customer shall be able to change setting by remote (review remote setting guide).
2. Press STOP button during front wash or rear wash to deactivate the function; otherwise turn off this function automatically after 5 min.
3. Press STOP button during dryer operation to deactivate this function; otherwise turn off this function automatically after 4 min.

UV Sterilization Function*

- UV sterilization function is used to sterilize wand by UV.
- **Auto UV sterilization**
 - ☐ Auto activates UV sterilization function to sterilize wand if nobody use for a long time. This function will not be reactivated within next 24 hrs.
 - ☐ During UV sterilization process, UV sterilization function will be deactivated if customer opens cover and seated on toilet, or press STOP button on side panel.
 - ☐ Auto UV sterilization function setting refers to Page 9.
- **Manual UV sterilization**
 - ☐ Click remote UV button to perform UV sterilization function when toilet cover is CLOSE.
 - ☐ During UV sterilization process, UV sterilization function will be deactivated if customer opens cover and seated on toilet, or press STOP button on side panel.

* UV sterilization (refers to the ultraviolet sterilization generated by UV lamp): During UV working cycle, the bacteria on nozzle surface will be eliminated by irradiation. The antibacterial rate is more than 99%. (Measured after one UV working cycle, it was measured within 18mmx8mm irradiation area. Perform test in accordance with GB/T 23131 requirements, UV radiation zone was shown in the diagram, UV working cycle activation mode refers to users guide. Testing lab: China household electrical appliances testing institute.)

Sterilized water*

- Electrolyzed water function is to sterilize nozzle by electrolyzed water.
- Toilet shall activate electrolyzed water sterilization function after customer complete front wash, rear wash or spiral wash etc. function and unseated.
- Auto activate electrolyzed water sterilization function every 8 hrs when nobody seated on toilet.

* Sterilized water (refers to the tap water containing hypochlorite generated by chlorine ions after ionization): Sterilized water generated during electrolysis working cycle eliminates bacteria on the nozzle surface. The antibacterial rate is more than 96%. (Perform test in accordance with GB /T 23131 when the content of chlorine ions in tap water is >24ppm. Different water quality might cause different sterilization effect. Electrolysis working cycle activation method refers to operation description. Testing lab: China household electrical appliances testing institute.).

Auto Energy Saving Function

- Toilet shall auto detect idle hour if energy saving function is ON, and decrease seat heating temp for energy saving purpose.
- Auto energy saving setting refers to Page 9.

Deodorizer

- Product default factory setting is auto activate deodorizer function when detecting customer seated.
- Refer to Remote Setting for how to switch over auto deodorization function.

Service and Clean

A. Regular clean

For best results, keep the following in mind when caring for your KOHLER product:

IMPORTANT! Do not rinse cover directly (include remote).

- Inspection – always test your cleaning solution on an inconspicuous area before applying to the entire surface.
- **Do not allow cleaners to soak on surface** - do not allow cleaners to soak the product.
- **Do not use abrasive material** – use a soft, damp sponge or cotton clothes. Never use an abrasive material such as a brush or scouring pad to clean surfaces.
- **Wipe surface** – wipe surfaces clean and rinse completely with water immediately after applying cleanser. Rinse and dry any overspray that lands on nearby surfaces.

Clean seat

- Do not use abrasive detergent and sterilizing aerosol spray products.

Caring indication: use detergent and water mixture or any other detergent listed for seat cleaning products to clean seat; use a soft, dampened sponge or cloth. Wipe away and dry with soft towel, natural dry seat in the air.

- No corrosive chemical products or cosmetics (such as nail polish or aftershave solution) allowed contacting with seat to avoid surface damage.

Clean stainless steel beauty parts

- Clean surface with neutral soap water, and then wipe the whole surface off with clean and soft rag. Do not use cleaners, such as Ammonia, decontamination powder or toilet cleaner which will cause surface damage.

NOTE: disobey these cleaning instructions could void the Kohler warranty.

NOTE: cleaning process success shall be determined by water hardness and temperature, accurate component quantity, cleaning specification modification.

Note: do not use excessive force when caring cover and seat to prevent product from damage.

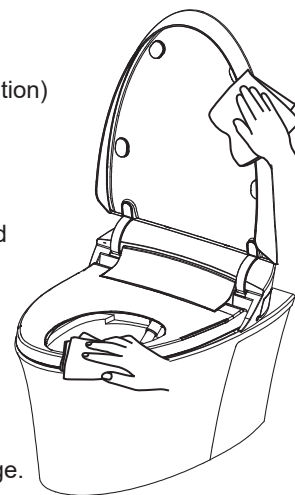

B. Nozzle clean

Method of washing the front/rear wash nozzle with a soft brush:

- ☐ Under unseated status, push and hold the “nozzle oscillate” key on the “remote control” for 2 seconds, or press and hold the front wash or rear wash key on the side panel to extend the nozzle.
- ☐ Use a wet soft brush to clean the nozzle.
- ☐ Press one of the above keys or the stop key on remote control one more time. The nozzle will retract or the nozzle will retract automatically after 2 min.

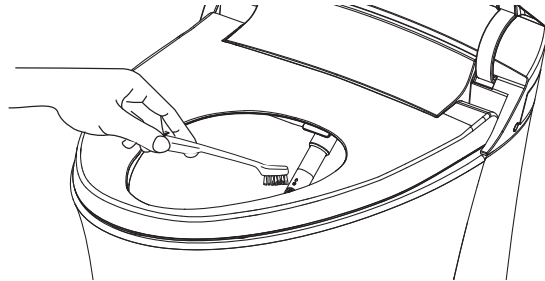

Customer to remove nozzle for cleaning:

- ☐ When unseated, push and hold the “oscillate” button on the “remote control” for 2 seconds, or press and hold the front wash or rear wash button on the side panel to extend the nozzle.
- ☐ Disconnect power supply within 2mins.
- ☐ Remove nozzle along the arrow direction as shown.

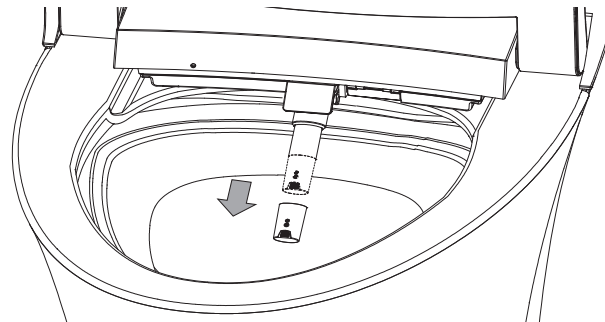

- ☐ Immerse nozzle into cleaning solution for 2 hours.
- ☐ Clean with soft brush.

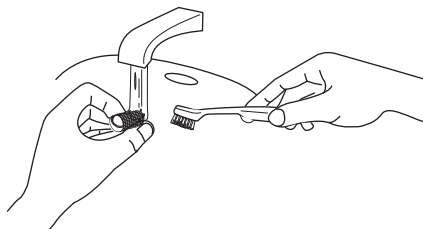

- ☐ Mount nozzle back to original position along the dismantle direction.
- ☐ Check nozzle clean function after power is ON.

C. Clean and Replace Filter Screen

Please clean or replace filter screen when customer found the amount of spray water decrease or no spray water problem occurred.

Toilet filter screen clean

- Turn off power supply, valve and remove filter screen plug.

1

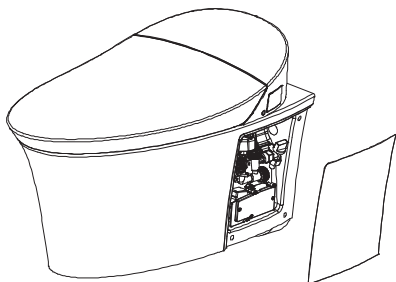

Power switch
Off mode
(LED OFF)

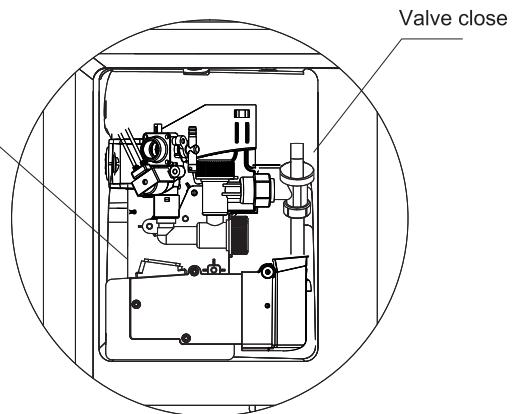

- Remove filter screen and clean

2

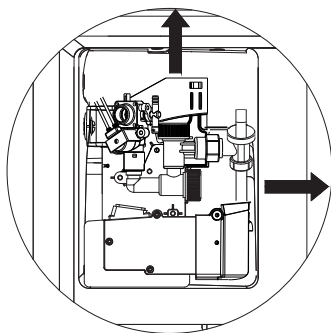

3 Clean filter screen

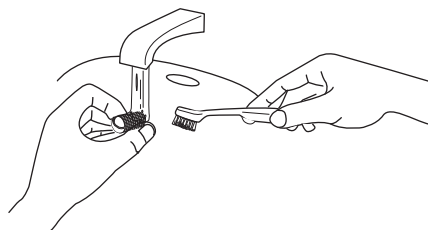

- Re-install filter screen, connect to hose connector, open valve. Turn
- on power supply after check connections and no leak observed.
- Reinstall side panel.

Concealed water tank filter screen clean

Please follow the steps specified in installation manual.

- Remove control board.
- Remove supporting board.
- Remove water repelling board.
- Screw valve switch to turn off water supply. Unscrew
- filter locknut as shown and clean with water.
- Reinstall filter screen after clean.

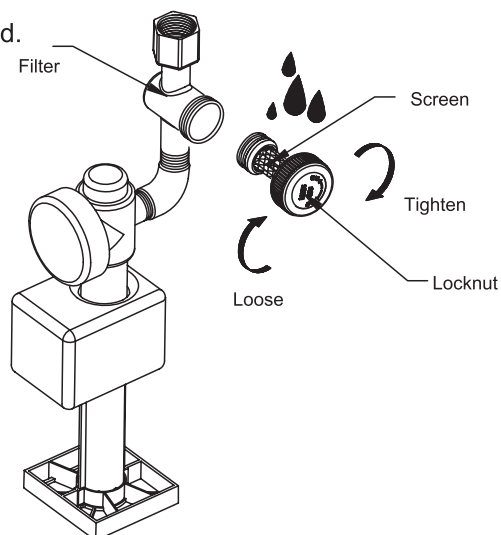

D. Exchange Deodorizer Block

Please replace deodorizer block when poor deodorizing performance or strange smell occurs.

Deodorizer block exchange steps:

- Remove deodorizer screen and deodorizer block.

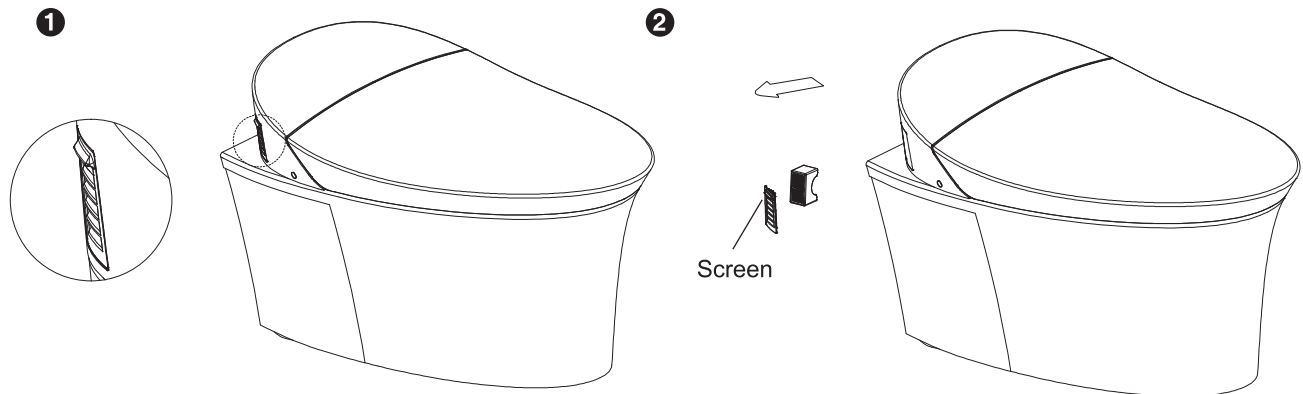

- After exchange deodorizer block, re-install back to the toilet.

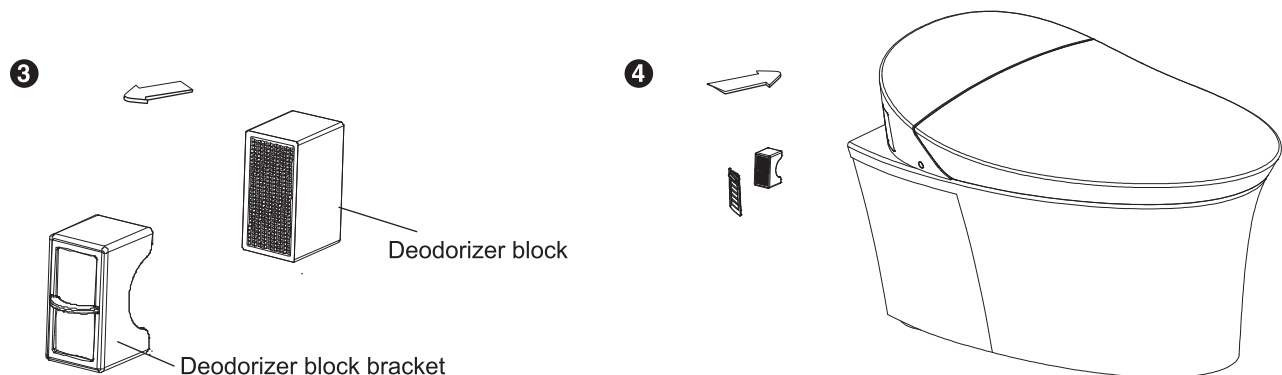

Note:

When take deodorizer block off, please do not insert finger or other objects into deodorizer block cavity to prevent fan or other parts damage.



Scan the QR code to order the replaced part with the part number 22761T-NA.

E. Service after long idle times

a) If the intelligent toilet will be idle for a long term, make sure the water in pipeline of cover is drained completely:

- Turn off power supply or valve, press discharge button within small hole on heating pipeline by fine rod to discharge the residual water.

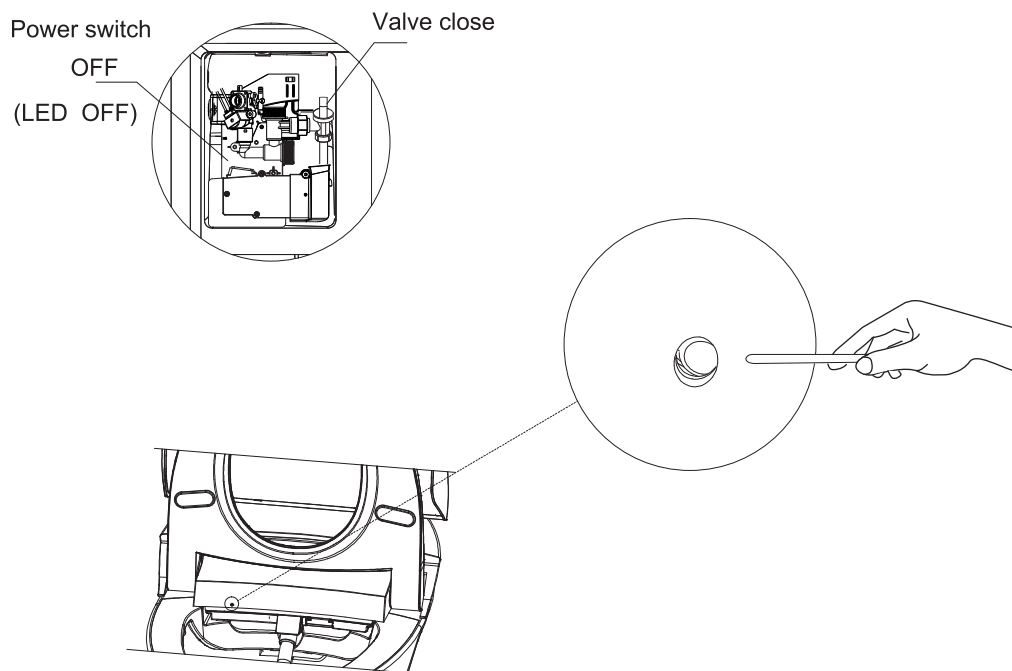

Note:

1. Residual water may freeze in winter and easy to metamorphic if toilet is not discharged completely within long idle times.
2. Any water remaining in the seat may freeze during winter, allow the unit to warm to room temperature before reinstalling or using.
3. Please flush several times after long idle times to ensure the cleanness of internal pipelines.
4. Please remove battery from docking station when prepare not to use for a long time.

b) Open cover or add water inside the toilet might avoi the plastic parts yellowing problem caused by backflow air from discharge pipe after residual toilet water evaporated during long-term idle status.

TROUBLE SHOOTING

This troubleshooting guide is for general aid only. A Kohler Authorized Service Representative should correct any electrical problems. For warranty service, contact your dealer or wholesale distributor.

Symptoms	Probable Causes	Recommended Action
1. Toilet does not work.	A. A power failure occurred. B. Product is under protected status. C. Toilet is OFF.	A. Wait until the power is restored. B. Turn power off on switchbox and then turn on (refer to owners guide page 10 diagram). C. Turn on switch on terminal box (refer to owners guide page 10 diagram).
2. Toilet does not flush automatically	A. No water supply. B. The water supply stop is closed. C. A power failure occurred. D. Product is under protected status. E. Auto flush function is OFF.	A. Wait for restoration of water supply. B. Open the water supply stop. C. Wait until the power is restored or check owners guide "manual flush" section D. Turn on switch on terminal box (refer to page 10 diagram). E. Refer to owners guide " Remote setting guide" section.
3. Toilet does not flush completely	A. Filter screen is clogged. B. Insufficient manual button travel.	A. Refer to owners guide " Clean filter screen " section . B. Dismantle water outlet control panel, adjust manual flush adjustment rod.
4. Clean function does not operate properly	A. No water supply. B. Water supply valve close or is not fully open. C. Toilet is on OFF mode. D. Unseated or current sitting gesture is unable to detect. E. Filter screen is clogged. F. Insufficient water supply pressure.	A. Wait for restoration of water supply. B. Fully open water supply valve. C. Turn on switch on terminal box (refer to owners guide page 10 diagram). D. Please sit on again or adjust sitting gesture. E. Refer to owners guide "Clean and Replace Filter Screen" section. F. Inspect water inlet hose for any sharp bending; if it is too sharp, please adjust hose.
5. Flush function stop work during operation.	A. Auto stops flush function after continuous 5 min flushing. B. The seat does not detect any customer.	A. If needed, please press flush button again. B. Adjust sitting gesture and sit again.
6. Spray function start even unseated	A. The seat is covered by an object or the seat is wet.	A. Remove object and wipe the seat.
7. Dryer stop work during operation.	A. Dryer auto stops after continuous 4 min blowing. B. The seat does not detect any customer.	A. If needed, please press dryer button again. B. Adjust sitting gesture and sit on again.
8. Deodorizer fan stop work	A. The seat sensor is not detecting the user. B. Accidentally press STOP button during operation. C. Auto deodorizing function is disabled.	A. Remove object or wipe seat. B. If needed, please sit on again after 2s. C. Refer to owners guide "Remote setting guide" section.
9. Unable to open/close cover	A. The seat sensor is not detecting the user. B. Customer interference during previous cover swing process.	A. Remove object or wipe seat. B. Use remote to open/close cover or manual open/close cover to normal position. Do not block switch during swing process.
10. Unable open/close cover automatically	A. Customer does not enter or leave detecting zone. B. Remote "auto swing" function is OFF. C. Toilet is flushing.	A. Please enter or leave detecting zone. B. Refer to owners guide "Remote setting guide" section. C. Wait until toilet flush process complete.
11. Night light OFF	A. Night light function is OFF. B. Ambient light is too bright.	A. Refer to night light in owner guide "Auxiliary side panel function" section to turn on night light function. B. Please turn off ambient light and close curtain, or confirm until ambient light is getting dark.

12.UV sterilization stop	A. Customer sits on seat. B. The seat is covered by an object or the seat is wet.	A. Please close cover and reactivate UV sterilization and close toilet cover. B. Remove objects or wipe seat.
13.No display on remote	A. Battery runs out. B. Wrong battery installation. C. Remote has not been awakened yet.	A. Change new battery. B. Re-install battery correctly. C. Touch remote screen. Approach to toilet or seated Press remote awaken button
14.Remote unable to control toilet.	A. Battery runs out. B. Remote and toilet distance is too far. C. Toilet power is not ON. D. Toilet is under OFF mode. E. Toilet and remote is not connected.	A. Refer to owners guide "Remote battery use and replace" section to replace battery. B. Refer to owners guide "Remote to toilet communication" section and move remote closer to toilet. C. Please connect toilet power supply. D. Turn on switch to terminal box (refer to owners guide page 10 diagram). E. Refer to owners guide "Remote to toilet communication" section, connect toilet to remote.
15.Seat temp is low when seated.	A. Seat temp is OFF. B. Energy saving mode.	A. Refer to owners guide remote guide within the manual for temp setting. B. Refer to owners guide remote guide within the manual to exit energy saving mode.
16.No water sup from inlet valve.	A. Water inlet valve is not OPEN. B. Water inlet float is covered by other parts. C. Water inlet valve float is stacked by other objects.	A. Open water inlet valve. B. Adjust other parts to avoid any contact with float during process. C. Clean float by water.
17.No water flush when press FLUSH FULL or FLUSH ECO button.	A. Wrong adjusting board and screw rod installation. B. Discharge valve leveler and barb is not connected.	A. Re-install screw rod. B. Re-install barb on discharge valve lever and snap in.
18.Water level is high or too low.	A. Water inlet valve float is not adjusted properly.	A. Adjust water level again.
19.Toilet leak.	A. Foreign objects block water inlet valve float when water enters water tank; unable to stop water; water leak from water discharge valve overflow pipe. B. Foreign objects on water sealing piece.	A. Adjust other parts to avoid any contact with float during process. B. Remove foreign objects on water seal piece.
<p>If you're going to service the toilet, you should observe the following rules:</p> <p>Turn off switch on terminal box (refer to owners guide Page 10 diagram). If it is necessary, open water supply valve. Please cut off power supply before servicing terminal box.</p>		

Description of Content of Hazardous Substances in Product

Reclaim Indication

When the product exceeds service life or is unable to use after repair, do not throw the product away in the normal trash. Please dispose the waste electronic parts through a qualified reclamation enterprise. Make sure the product is handled properly. Disposing of product must be done in accordance with the local or national government law.

Statistics of Contents of Toxic or Hazardous Substances or Elements

Statistics of Contents of Toxic or Hazardous Substances or Elements In Product										
部件名称	Hazardous Substances or Elements									
	Lead (Pb)	Mercury (Hg)	Cadmium (Cd)	Hexavalent Chromium (Cr(VI))	Polybrominated Biphenyls (PBBs)	Polybrominated Diphenyl Ethers (PBDEs)	Dibutyl Phthalate (DBP)	Diisobutyl Phthalate (DIBP)	Butyl benzyl Phthalate (BBP)	Bis(2-Ethylhexyl) Phthalate (DEHP)
Plastic Assy	○	○	○	○	○	○	○	○	○	○
Control Assy	×	○	○	○	○	○	○	○	○	○
PCB Assy	×	○	○	○	○	○	○	○	○	○
Motor Assy	×	○	○	○	○	○	○	○	○	○
Wire Harness Assy	○	○	○	○	○	○	○	○	○	○
Water Inlet Assy	○	○	○	○	○	○	○	○	○	○
* Wand Assy	○	○	○	○	○	○	○	○	○	○
Heater Assy	×	○	○	○	○	○	○	○	○	○
* Remote Assy	×	○	○	○	○	○	○	○	○	○
* Battery	○	○	○	○	○	○	○	○	○	○
* Ceramic Assy	○	○	○	○	○	○	○	○	○	○
* Water Tank Assy	○	○	○	○	○	○	○	○	○	○

Note 1: ○: Indicates that the homogeneous substance in the material composition is below the high limits of the current national standard.

×: Indicates that at least one of the homogeneous substance in the material composition exceeds the high limits of the current requirements .

Note 2: Components not listed above, indicates that the homogeneous substance in the material composition is below the high limits of the current national standard.

*: Indicates only partial product series contains this component.

Note: The information provided is based on the supplier data and Kohler inspection results. The product is designed not to hurt the environment. Under current technology, all hazardous materials have been used in the smallest amounts possible. Kohler will strive to reduce the use of these hazardous materials used in this product.



The product "service life for environment protection" is 10 years; Kohler Company will specify product service life based on product characteristics. The product "service life for environment protection" is only effective when the product is used as described in the product specification.

目录

安全注意事项..... 24

规格..... 26

感谢您选择科勒公司..... 27

整机简图..... 27

遥控器使用指南..... 28

遥控器设置指南..... 29

初次使用前准备..... 31

开、关盖/开、关圈..... 32

便器冲水..... 33

辅助键盘功能..... 35

UV除菌功能..... 35

除菌水..... 36

自动节能功能..... 36

除臭..... 36

维护清洗..... 36

常见问题..... 41

产品中有害物质含量的说明..... 43

安全注意事项

请认真阅读安全注意事项，请务必遵守。

- ☐ 如果电源软线损坏，为了避免风险，必须由制造商、其服务机构或类似的专业人员更换。
- ☐ 最小进水压力0.07MPa(动压)，最大进水压力0.74MPa。
- ☐ 必须使用随器具附带的新软管组件，旧软管组件不能重复使用。
- ☐ 本产品必须安全接地。只能连接到专用的220V~，50Hz，10A带接地故障断路器或接地漏电保护器的电路中。

警告

 警告：如果无视此标志内容而误操作时，有可能造成人员重伤或死亡。

- ☐ 在通电之前必须按照说明书中的要求接地。
- ☐ 在安装本坐便器时切勿使用任何凝胶材料（水泥砂浆）。因为凝胶材料（水泥砂浆）的热膨胀可能使坐便器的脚部挤破或损坏。科勒对所有因为凝胶材料（水泥砂浆）安装而引起的坐便器破裂恕不负责。
- ☐ 提防损坏产品。请不要向便器内冲入新闻纸、纸尿裤、妇用卫生巾等容易堵塞的物品。请不要用重力撞击陶瓷，以防止破损漏水。不要在0℃以下的环境中使用。
- ☐ 触电或产品损伤的危险。不要把产品浸入水中。
- ☐ 产品损坏的危险。在安装工作完成之前不要接通电源，这可能导致产品故障。
- ☐ 当使用电器产品时，尤其当儿童在场时，应该遵守基本的安全防范，包括如下：

危险—降低触电的危险：

- 不要把此产品放置在可能掉落或可能被拉入浴缸及水槽的地方。
- 不要放置或掉到水及其他液体中。
- 不要触及掉进水中的产品，请立刻拔掉电源插头。

- ☐ 如果有以下情况请不要使用本产品：电源线、插头及产品有损坏；产品不能正常工作；产品掉入水中。
- ☐ 使电源线远离加热表面。
- ☐ 防止将水淋到电源插头上。

注意

 注意：如果无视此标志内容而误操作时，有可能造成人身伤害或产生损失。

- ☐ 遥控器只允许在坐便器视线之内控制器具。
- ☐ 产品损伤的风险。不要安装在水可能溅到的地方。
- ☐ 产品损伤的风险。不要把产品安装在过分潮湿的地方，在这种地方，水汽可能凝聚在产品表面。请始终保持使用环境有足够的通风，以防止电子组件的损坏。
- ☐ 产品损坏或财产损失的风险。硬推、硬拉水管接头可能造成水渗漏。
- ☐ 产品损坏的风险。不要在喷嘴上施加过大的力，否则产品可能损坏。
- ☐ 产品损坏的风险。在一些水可能在水管中结冰的地方，要做好水管保温的安排。任何留在产品里的水在冬天储存时都可能结冰。在重新安装或使用前请保证产品暖至室温。
- ☐ 温暖的气候时，热保护器在存储或运输过程中可能失灵，导致产品不工作。在重新安装或使用前请保证产品冷至室温。

安全注意事项（续）

警告—避免低温灼伤、触电、火灾或人身损伤

- 当儿童、老年人、残疾人，以及身体、感知、智力能力缺陷或经验和常识缺乏的人使用或靠近此产品时，近距离的监护是必需的。儿童不应该被允许使用或接触此产品，不要让儿童独自待在安装有此产品的房间，儿童不应玩耍器具。
- 对于无法自己进行温度调节操作的儿童和老人，需要帮助将坐便盖的圈温、冲水温度及风温调节到合适的档位。
- 请避免长时间让裸露的皮肤接触加热座圈，以免低温灼伤。

- ☐ 仅按照手册中所描述的方式使用本产品，不要使用科勒不推荐的附件，如角阀等。
- ☐ 使用时请勿倚靠在盖板上，以免损坏产品。
- ☐ 根据安装说明正确地安装本产品。
- ☐ 只有专业人士可以修理此产品。不要试图自己维修此产品，否则保修无效。
- ☐ 在安装本产品的同一房间中，需要在触手可及的位置安装一个止水阀，用于紧急情况下，无需借助工具即可切断本产品的进水水路；否则本产品的意外故障可能会导致用户损失。
- ☐ 不要把任何物品掉入或插入管路和开孔处。
- ☐ 不要在户外或者微粒喷雾设备正在被使用的地方使用本产品。也不要给在缺氧的地方使用本产品。
- ☐ 需要有资质的维修人员维修紫外线杀菌装置。
- ☐ 用户切断电源后，如须再次接通电源，请务必听到“滴，滴...”提示音结束后，再接通电源。
- ☐ 如果发现下列情况，请勿继续使用。请断开电源并同时关闭进水角阀，停止供水。
 - 软管及产品的内部向外漏水。
 - 当产品出现裂缝或破损时。
 - 产品出现异声或明显异味。
 - 发现产品产生烟雾。
 - 当产品异常发热时。
- ☐ 非充电电池不要充电
- ☐ 充电电池，充电前要将电池从电器中取出
- ☐ 用尽的电池需要从器具中取出并安全处理
- ☐ 如果设备长期存放不用，应拆卸电池
- ☐ 电源端子不能短路
- ☐ 遥控器不能放置在被水淋到的地方

规格			
冲水用水量		平均 4.6L、全冲5.8L、半冲 4L	
水效等级*		2级	
供水压力		最小进水压力0.07MPa（动压） 最大进水压力0.74MPa	
额定电压		220V~, 50Hz	
额定功率*		1090W	
产品外型尺寸		约675mm x 438mm x 533mm	
产品重量		约42kg	
进水温度		1-35℃	
使用环境温度		1-40℃	
清洗	臀部冲洗		有，档位可调
	旋转冲洗		有，档位可调
	女性冲洗		有，档位可调
	出水流量（水压0.2MPa时）		臀部冲洗最大档不小于500mL/min
	清洗水温调节		关、五档可调（室温、约31-39℃）
	冲洗时间（最长）		约300s
	喷嘴位置调节		5档
	脉冲按摩		开/关
	移动冲洗		开/关
		安全装置	水温过热保护
逆流防止			单向阀，真空破坏器
舒适	座圈保温	温度调节	关、五档可调
		安全装置	温度保险丝
	盖板		自动开合、缓降、遥控开合
	座圈		缓降、遥控开合
	暖风	温度调节	关、五档可调
		安全装置	温度保险丝
	除臭功能		有
	遥控器		功能设置见 29-30 页
卫生	喷嘴自清洗		有
	抗菌材料		座圈、盖板
	除菌水		有
	UV除菌		有
其它功能	其它安全装置		漏电保护器
	辅助键盘		有
	落座感应		位于座圈内部
	夜灯		有，仅作为坐便器内部照明，不具备外部照明
	自动开关盖		微波感应
	手动冲水		有
IOT 功能		K-30085T-XP-0(有), K-30085T-0(无)	
隐藏水箱尺寸 (L*W*D)		约1228mm × 560mm × 80mm	
冲水控制面板尺寸 (L*W)		约215mm × 150mm	
隐藏水箱驱动方式		手动 + 自动	
冲水控制面板颜色		柔和霜白	
冲水控制面板LED灯颜色		蓝色	
隐藏式水箱进水接头规格		G 1/2"	
承压能力		最大400kg	
可调墙的厚度		约8 - 69mm	
* 智能坐便器施加的水效标识的说明：水效标识表示智能坐便器水效等级等性能的一种符合性标志。 * 功率值测试条件：动压 0.2MPa、进水温度15℃。 以上参数为全功能版本，具体型号的规格差异见产品配置表。			

感谢您选择科勒公司

感谢您选择科勒。科勒技术提供了可靠性能和优雅生活的结合，满足了您未来几年的需求。科勒产品的美观和可靠性将满足您最挑剔的眼光。我们为我们科勒的产品感到非常地自豪，相信您也会。

请花几分钟阅读一下这本用户手册，特别注意维护和清洗说明。

这本说明书中所有的信息基于最新公开的产品信息。在科勒，我们一贯坚持改善我们产品的质量。我们保留在任何时候不通知的情况下提高产品特性，包装或实用性的权利。

整体简图



* 抗菌：含无机系抗菌材料的座圈、盖板长期抗菌，抑制产品表面的细菌生长，这一加工处理不代表防霉等附带效果。抗菌率大于90%（依据GB21551.2-2010进行试验。测试机构：中国家用电器检测所、上海出入境检验检疫局机电产品检测技术中心）

遥控器使用指南

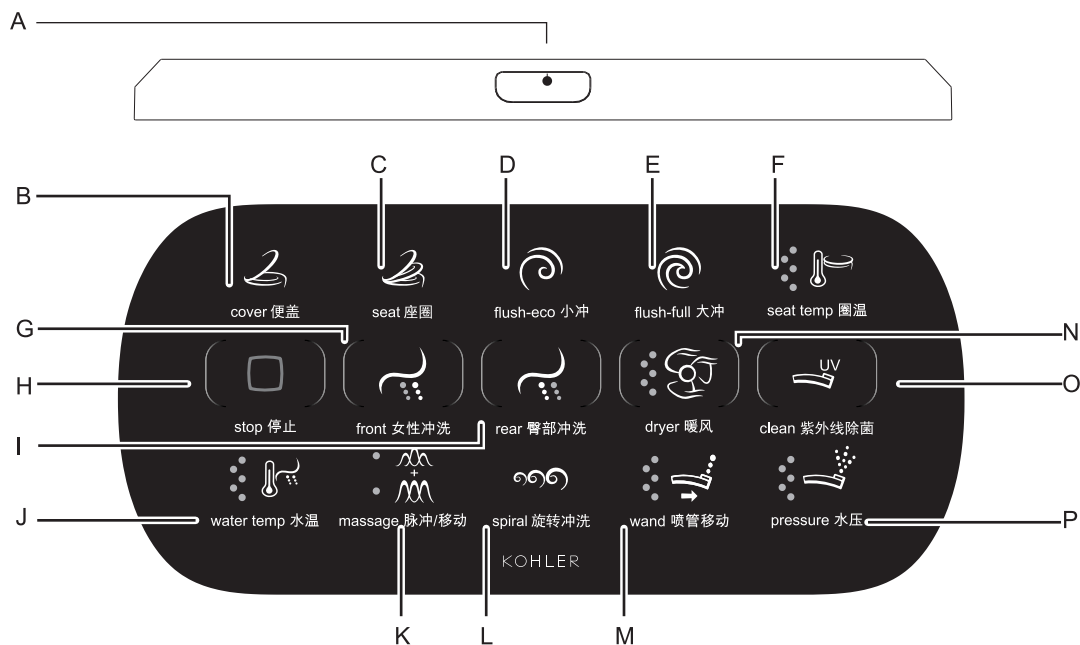

警告： 为避免掉落的风险, 请从充电座上取下遥控器再按开机键。

A - 开机

按此键进行遥控器开机。开机后按此键可进行开、关屏切换。

开机后若未与坐便器连接上, 则第三排图标会闪烁, 连接成功后停止闪烁, 进入可使用状态。

B - 便盖开/关

离座状态下, 可按此键进行开/关盖动作。

C - 座圈开/关

离座时, 可按此键进行开、关座圈动作。

D - 小冲

- 按此键对坐便器进行小水量冲洗。

E - 大冲

- 按此键对坐便器进行大水量冲洗。

F - 圈温

按此键调整圈温档位, 调至5个蓝色点不显示将关闭座圈加热功能。

G - 女性冲洗

落座后, 按此键进入女性冲洗, 约5分钟后自动停止或按停止键立即关闭。

H - 停止

- 按此键可停止女性冲洗、臀部冲洗、暖风和除臭, 手动清洁喷管、UV等功能。
- 长按此键关闭遥控器。

I - 臀部冲洗

落座后, 按此键进入臀部冲洗, 约5分钟后自动停止或按停止键立即关闭。

J - 水温

在开启女性冲洗或臀部冲洗后, 按此键调节水温档位。

K - 脉冲移动

在开启女性冲洗或臀部冲洗后, 按此键进入移动冲洗, 再次按进入脉冲冲洗, 第三次按移动/脉冲同时进行, 第4次按退出该模式 (相应功能启动时, 图标左侧的灯亮)。

L - 旋转冲洗

在进行臀部冲洗期间, 按此键进行旋转水型冲洗, 旋转冲洗图标闪动。再按退出旋转冲洗 (或按“停止”键关闭), 旋转冲洗图标停止闪动。

M - 喷管移动

在开启女性冲洗或臀部冲洗后，按此键调节喷管移动位置。

N - 暖风

落座后，第一次按此键开启暖风功能，再次重复按此键调节暖风档位，约4分钟后自动停止或按停止键立即关闭。

O - 紫外线除菌

在离座状态，短按此键进入紫外线杀菌功能，图标闪动。

P - 水压

在开启女性冲洗或臀部冲洗后，按此键调节水压档位。



低电压报警

注意：电压报警后请及时充电。

- 当  键闪烁时，表示遥控器内置电池电量将耗尽，需将遥控器放置在基座上充电；

配对

注意：配对操作只能在离座状态下进行。

- 座便盖正常上电，按遥控器顶端开机键开机，当最下面一排图标长时间闪烁，即表示该遥控器需要与本体进行配对操作。
- 长按遥控器暖风键，当最下面一排图标快闪后开始进行本体端操作。
- 同时长按本体辅助键盘的  键和  键，直到听到一声短鸣后放开按键。
- 看到遥控器最下面一排图标停止闪烁，表示配对成功。

遥控器与本机的通讯

- 遥控器被移动离开感应区域，遥控器最下面一排图标会自动闪动(表示寻找主机信号)，拿回主机附近后，如主机是通电正常工作状态，将自动连接信号，连接成功后停止闪动。

关机功能

- 任何时候长按  键，遥控器进入关机状态。

遥控器设置指南

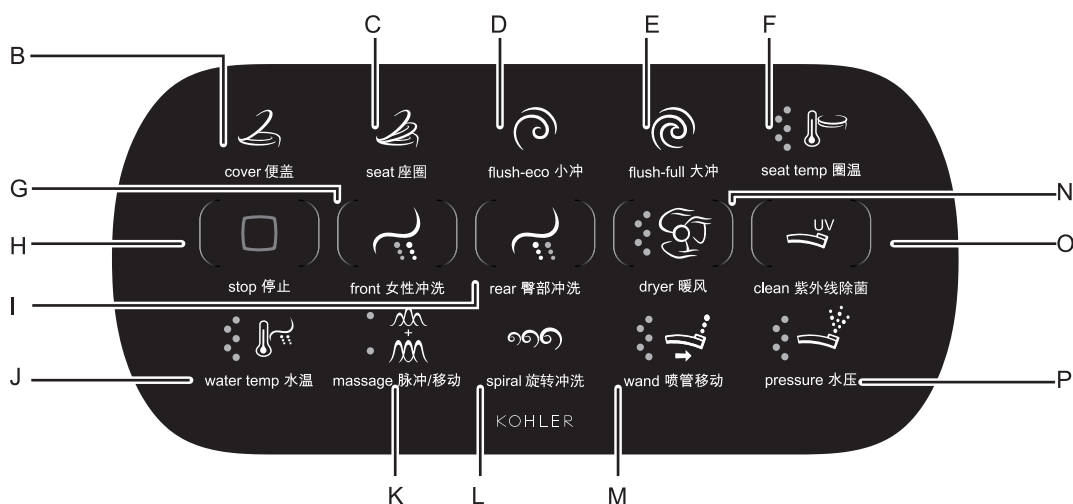

按住本体侧键盘 \odot 键，直到听到一声短音，同时夜灯闪烁三次后，放开按键，随后可按照以下B/C/E/F/O变更设置。

B - 便盖开/关…感应距的设置

- 长按此键进行自动翻盖感应距离设置：
 1. 夜灯快闪一次为近距（短音）。
 2. 夜灯快闪二次为中距（短音）。
 3. 夜灯快闪三次为远距（短音）。
 4. 夜灯慢闪一次则关闭自动翻盖功能（长音）。

C - 座圈开/关…除臭功能设置

- 长按此键设置除臭功能开启，关闭状态。
 1. 夜灯快闪一次开启除臭功能（短音）。
 2. 夜灯慢闪一次关闭除臭功能（长音）。

E- 大冲…自动冲水设置

- 长按此键设置自动冲水开启，关闭状态。
 1. 夜灯快闪一次开启自动冲水功能（短音）。
 2. 夜灯慢闪一次关闭自动冲水功能（长音）。

F - 圈温…节能设置

- 长按此键设置节能开启，关闭状态。
 1. 夜灯快闪一次开启节能功能（短音）。
 2. 夜灯慢闪一次关闭节能功能（长音）。

O - 紫外线除菌(UV灯)…UV自动杀菌设置

- 长按此键设置紫外线自动杀菌的开/关状态。
 1. 夜灯快闪一次开启紫外线自动杀菌功能（短音）。
 2. 夜灯慢闪一次关闭紫外线自动杀菌功能（长音）。

一定时间不进行B/C/E/F/O设置变更后，下次变更前需要重新用按住本体侧键盘 \odot 键，直到听到一声短音，同时夜灯闪烁三次。

M - 喷管移动…喷管清洁设置

- 离座状态下，长按此键启动手动清洁喷管功能，喷管伸出，可对喷头进行手动清洗，再次长按此键或按停止键停止该功能。

遥控器电池的使用及更换

- 遥控器充电座使用4节5号碱性电池。
- 当电量不够时，充电座会有红灯闪烁，提示用户需要更换电池。
- 注意：
 1. 电池的正负极必须与遥控器上的标记一致。
 2. 新旧电池不能混用。
 3. 请使用碱性电池。

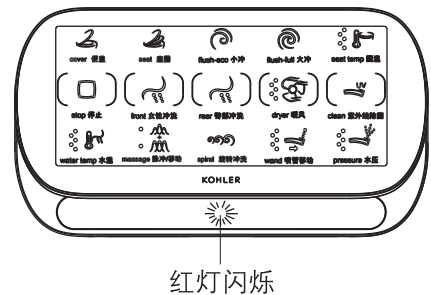

其他

- 请勿将遥控器放在液体可能直接喷淋到的地方，或浸泡在液体中。
- 请勿放置在烘手机、电吹风等小型家电的周围，以免干扰遥控器的正常使用。
- 请勿对遥控器的按键区域频繁、剧烈地施加外力。
- 遥控器使用完毕后，应放回墙上的遥控器支架。
- 在使用过程中，避免遥控器跌落。
- 防遗失功能：遥控器可通过螺丝与底座锁定，具体方法参见安装说明书。

初次使用前准备

接电线
接进水阀

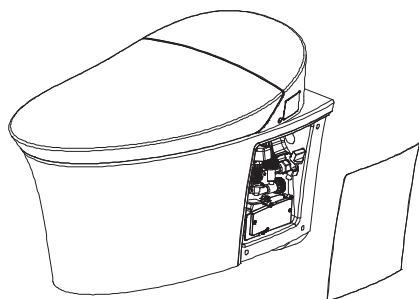

电源开关
开启状态
(指示灯亮)

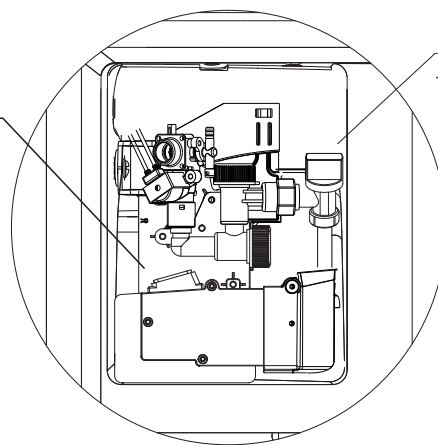

角阀开启状态
手柄位置如图示

- 确认进水阀是否已打开。
- 打开侧板确认电源开关和进水阀处于开启状态。
- 确认遥控器内已正确装入电池
- 确认产品正前方没有障碍物。
- 产品通电后，等待主机完成自检。期间可听到电机的转动声和流水声，夜灯闪烁，均属正常。当夜灯停止闪烁时，自检结束。
- 初次使用时为出厂设置状态：

女性冲洗：

- 水温：中档
- 水流强度：中档
- 冲洗位置：第3档

臀部冲洗：

- 水温：中档
- 水流强度：中档
- 冲洗位置：第3档

旋转冲洗：

- 水温：中档
- 水流强度：中档
- 冲洗位置：第3档

圈温：中档

风温：中档

夜灯：开

节能模式：关

自动翻盖功能：开，距离中

自动冲水功能：开

自动UV功能：开

除菌水功能：开

除臭：开

便盖/座圈开关功能

A 便盖开/关

• 自动开、关盖

关盖状态下，当用户进入感应区域时，盖板自动打开。

开盖状态下，当用户离开感应区域后，一段时间后自动关闭。

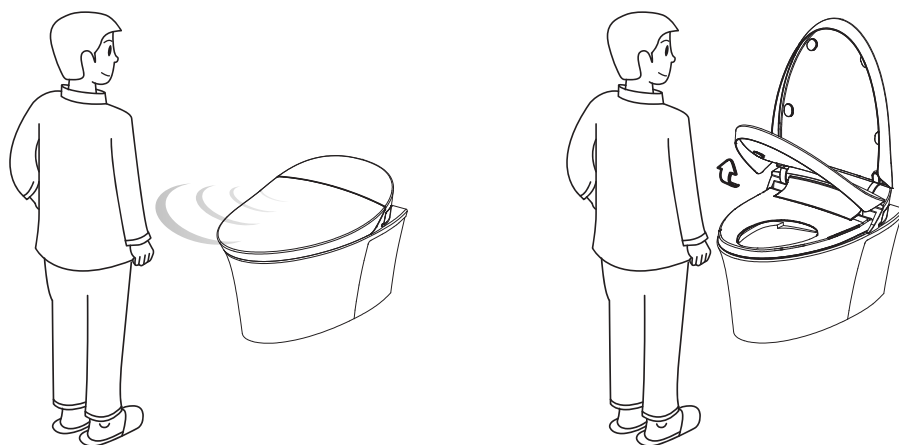

• 遥控器开、关盖

用户没有落座时，按下遥控器上的盖开/关键，则执行相应的开合功能(详见遥控器按钮简图)。用户落座时，按遥控器的  按键无效。

• 手动开、关盖

用户可以用手直接开、关盖。当用户有正常手动开、关盖的趋势时，盖板能够根据此运动趋势自动打开或关闭，不需要一直在盖板上保持用力。盖板在运动过程中遇阻碍会自动停下。

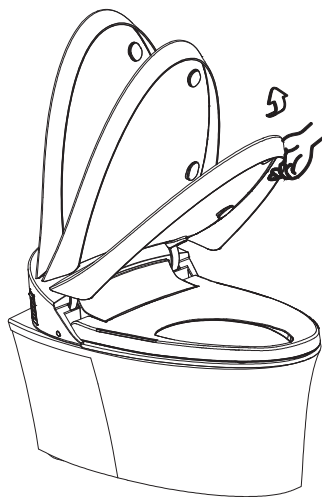

注意：

1. 当用户缓慢进入感应区域时，开、关盖感应距离可能变短。如仍无反应，请使用遥控器或手动开、关盖。
2. 只有在遥控器中的“开/关盖设置”设置为“开”时，自动开、关盖功能才有效（设置方法见第30页）。
3. 避免在坐便器前端40cm内设置可移动的障碍物，若有可移动的障碍物，盖板可能会自动打开；若需要取消“自动开、关盖”功能，请见第30页。

B 座圈开/关

• 遥控器开、关圈

用户没有落座时，按下遥控器上的圈开/关键，则执行相应的开合功能（详见遥控器按钮见图）。用户落座时，按遥控器的  按键无效。

• 手动翻圈

用户可以用手直接开、关圈。当用户正常手动开、关圈时，座圈能够根据此运动趋势自动打开或关闭，不需要一直在座圈上保持用力。座圈在运动过程中遇阻碍会自动停下。

注意

在盖板及座圈自动开合过程中，严禁强行、大幅度用力等人为因素干扰盖板及座圈的开合。

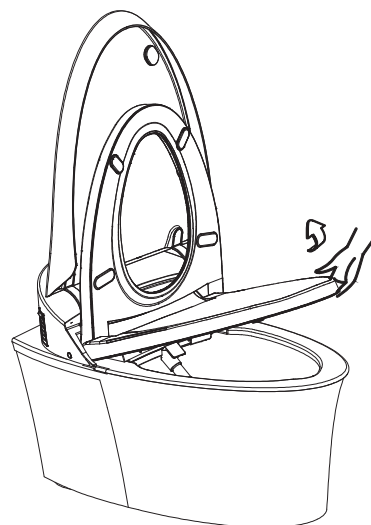

便器冲水

A. 自动冲水功能的使用

a) 使用座圈情况

盖板打开状态下，用户落座使用，当离开座圈一定时间后，便器自动冲水，一段时间后自动关闭。

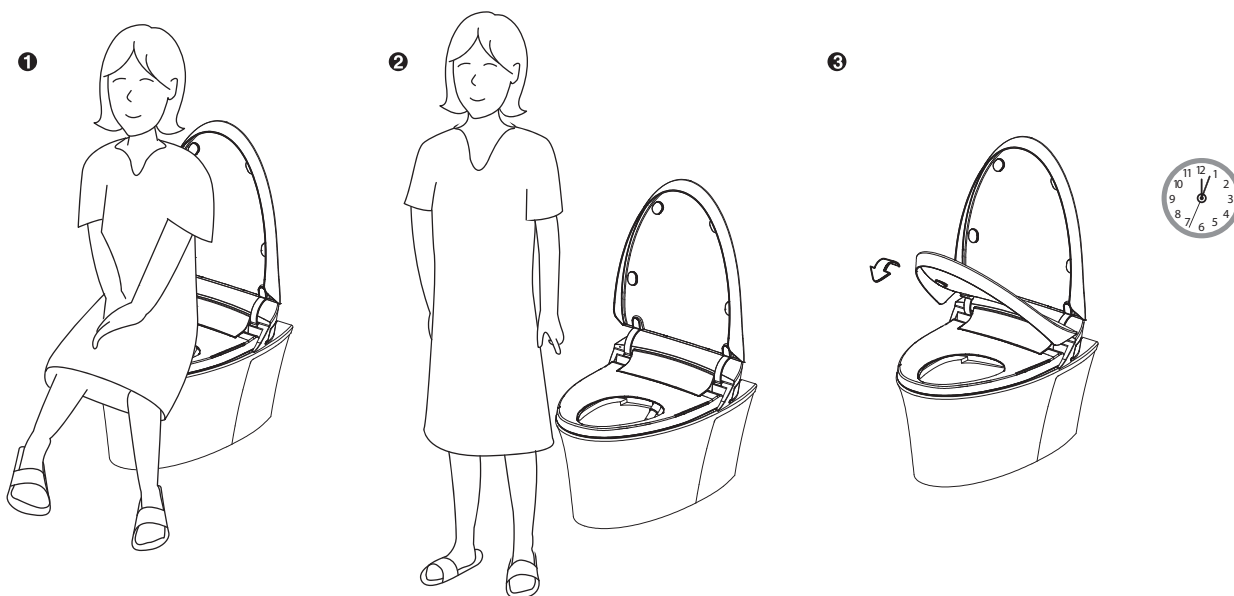

b) 男士小便情况

开盖状态下，用户手动或者使用遥控器翻起座圈，使用后，坐便器自动冲水，一段时间后，盖板、座圈自动关闭。

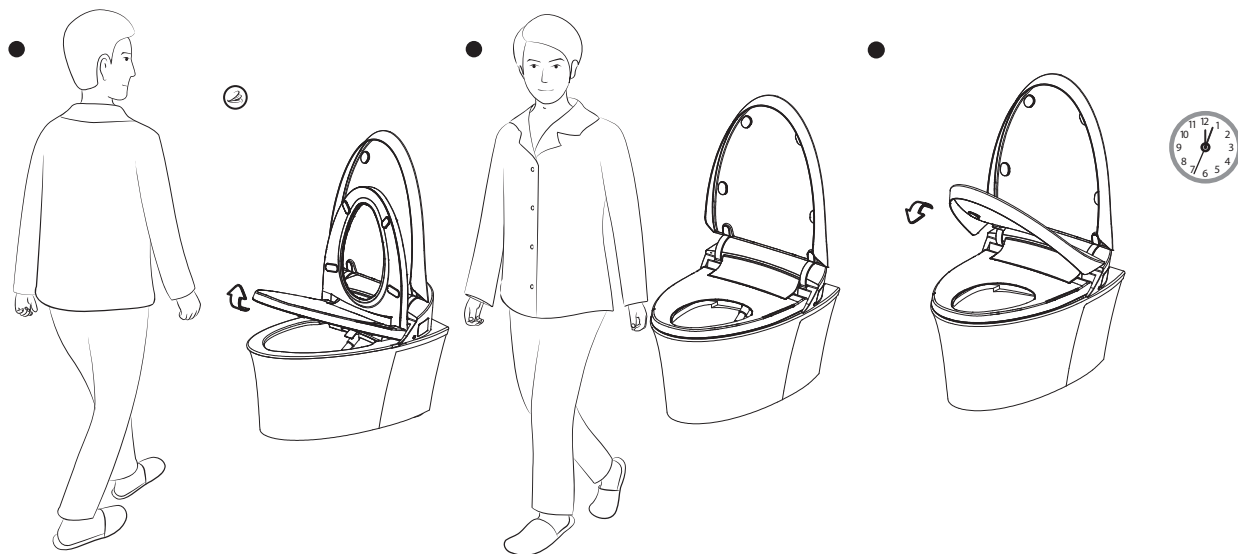

注：

1. 如果自动冲水功能关闭，用户可以用遥控器控制冲水，或手动按键冲水，或手工用盆冲水。
2. 只有在遥控器中的“冲水设置”设置为“开”时，自动冲水功能才有效（设置方法见第30页）。

B. 遥控器控制冲水

用户通过按遥控器上的大冲键或者小冲键，执行坐便器冲水功能。

注：遥控器冲水功能在冲水完成前，不会执行两次。

C. 手动按键冲水

当停电不能进行自动冲坐便器时，请按冲水控制面板手动冲水按键进行冲水。

左按键：马桶大冲

右按键：马桶小冲

辅助键盘功能

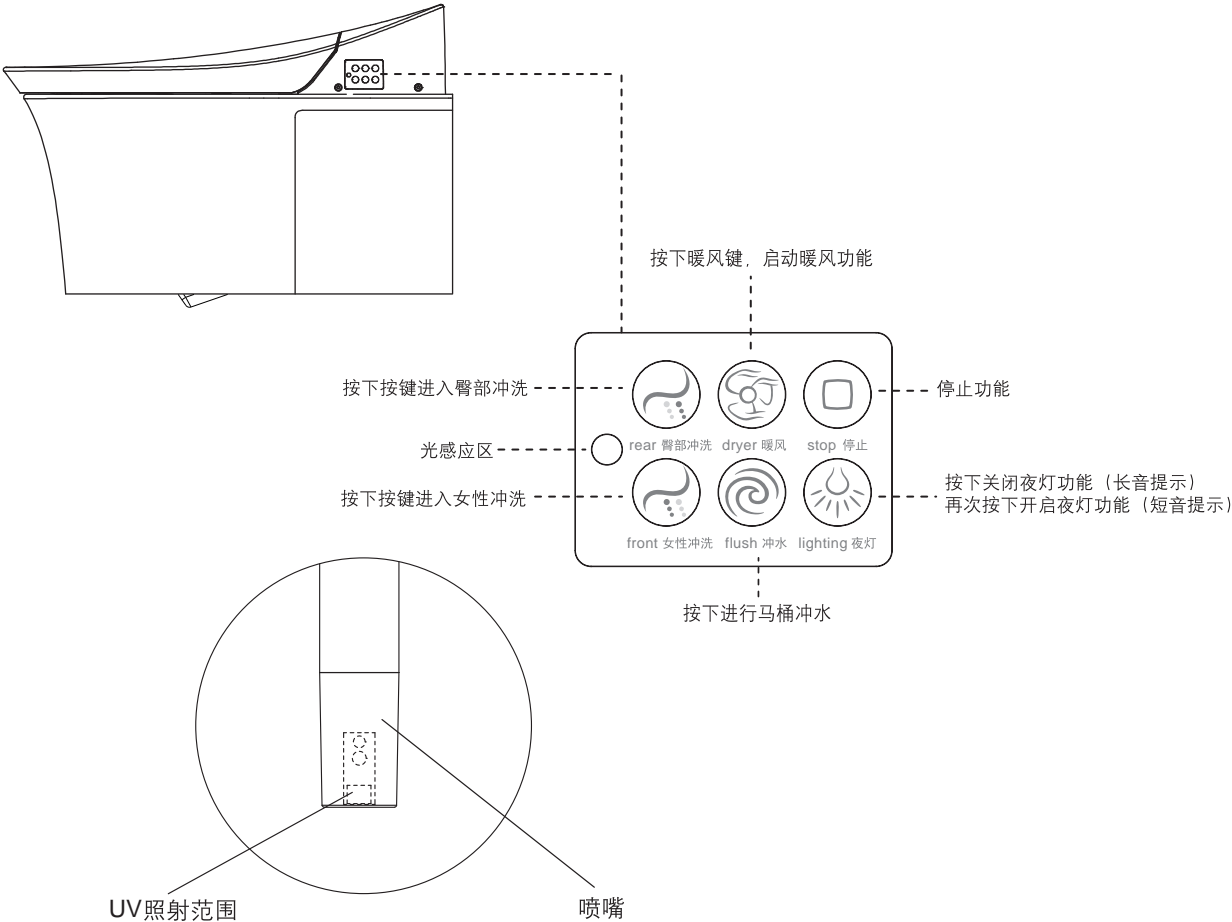

- 注：
- 1.各功能均按出厂设置运行。用户可通过遥控器更改设置（查看遥控器设置指南）。
 - 2.在使用女性冲洗、臀部冲洗功能时，按停止键，关闭该功能，否则5分钟后自动关闭。
 - 3.在使用暖风功能时，按停止键，关闭该功能，否则4分钟后自动关闭。

UV除菌功能*

- UV除菌功能是使用紫外线对喷管进行消毒。
- 自动UV除菌
 - 如果长时间无人使用，将自动启动UV除菌功能，对喷管进行除菌。除菌结束后24小时之内不会再次启动该功能。
 - UV除菌过程中，如果有用户来打开盖子落座使用坐便器，或者按下遥控器上的或辅助键盘上的停止键，UV除菌功能将关闭。
 - 自动UV除菌功能设置请参见第30页。
- 手动UV除菌
 - 在关闭座便盖的情况下，短按遥控器UV按键将立即执行UV除菌功能。
 - UV除菌过程中，如果有用户来打开盖子落座使用坐便器，或者按下遥控器上的或辅助键盘上的停止键，UV除菌功能将关闭。

* UV除菌（是指UV灯产生紫外线除菌）：在UV工作周期内通过照射对喷嘴表面进行除细菌。除菌率大于99%（在UV的一个工作周期后于18mm×8mm的照射区域内依据GB/T 23131进行试验，UV照射区域见示意图，UV工作周期开启方式见操作说明。测试机构：中国家用电器检测所）

除菌水*

- 除菌水功能是使用除菌水对喷头进行除菌的一种功能。
- 用户在使用过女性冲洗、臀部冲洗或旋转冲洗等功能，起身离开坐便器后，坐便器将启动除菌水除菌功能。
- 没有人使用坐便器的时候，每8个小时自动启动一次除菌水除菌。

* 除菌水（是指水电解装置电离自来水中的氯离子生成含次氯酸的水）：在电解水工作周期内产生的除菌水对喷嘴表面进行除菌。除菌率大于96%（在自来水中氯离子含量大于24ppm时依据GB/T 23131进行试验，各地水质不同可能导致除菌效果不同，电解水工作周期开启方式见操作说明。测试机构：中国家用电器检测所）

自动节能功能

- 在节能设置为开的情况下，产品会自动检测到使用频率低的时间带，并将便座加热温度下降以达到节电的目的。
- 自动节能设置参见第30页。

除臭

- 产品出厂设置为感应到有人座在座圈上时，自动开启除臭功能。
- 如何切换开/关自动除臭功能详见遥控器设置部分。

维护和清洗

A. 常规清洗

为了达到最好的效果，在维护您的科勒产品时记住下列几条：

重要！不要用水直接冲洗座便盖（包括遥控器）

- 测试-首先用清洗液在座便盖不显眼的地方测试，如果确认清洗液不会对座便盖外表造成损坏然后再应用于整个表面。
- 不要让清洁剂浸泡-不要让清洁剂浸泡产品。
- 避免表面粗糙的材料-使用柔软、潮湿的海绵或棉质布，不要用表面粗糙的材料来清洗表面，诸如刷子、冲刷垫等。
- 擦洗-加上清洁剂后，立即用湿布擦洗表面，擦除喷到表面的清洁剂和脏物。

清洗座圈

- 在用于清洗的气雾罐中避免使用具有研磨的清洁剂和消毒剂。

维护提示：用洗涤剂和水混合液体或任何列为可用于座圈清洁的产品清洗座圈，用柔软湿润的海绵或者布。用软毛巾擦干，在空气中让座圈自然干燥。

- 不允许带腐蚀的化学品或化妆品（诸如指甲油或须后水）和座圈接触，避免破坏表面。

清洗不锈钢外观件

- 以中性肥皂水清洗表面，再以干净的软布彻底擦干整个表面。许多清洁剂，比如氨水、去污粉及洁厕灵等，会对表面造成伤害，切忌使用。

注意：不遵守这些清洗说明可能使科勒的保修义务无效。

注意：清洗程序的成功取决于诸如水的硬度和温度，使用成分的精确数量，清洗规则的改变和被清洗产品的状态等因素。因为这些因素会有变化，科勒不能保证所提到的规则的有效性。

注意：清洁翻起的圈盖时，不能使大力，以免损坏产品。



B. 喷嘴的清洗

用户使用软毛刷清洁臀部/女性喷嘴的方法：

- 在离座状态下，长按“遥控器”上的“移动冲洗”按键2秒钟以上，或长按侧键盘的前冲或后冲键，喷管会伸出。
- 用户可以使用软毛刷沾水对喷嘴进行清洗。
- 再按一次上述按键之一或遥控器上的停止键，喷管缩回，或两分钟后喷管自动缩回。

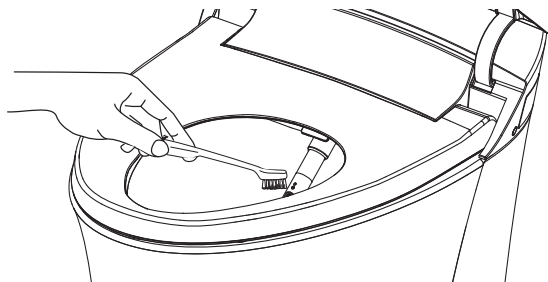

用户拆除喷头的清洗方法：

- 在离座状态下，长按“遥控器”上的“移动冲洗”按键2秒钟以上，或长按侧键盘的前冲或后冲键，喷管会伸出。
- 在两分钟之内断掉马桶电源。
- 沿图示箭头方向拔掉喷嘴。

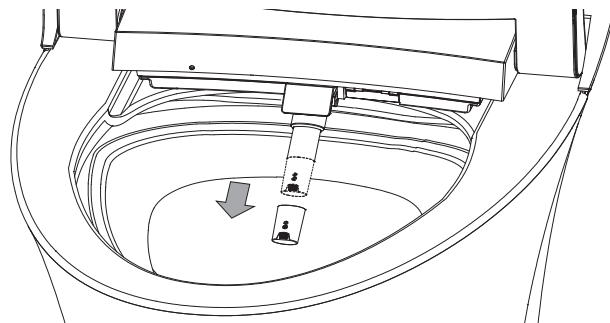

- 将喷嘴浸没在除垢剂溶液中2个小时。
- 用软毛刷清洗干净。

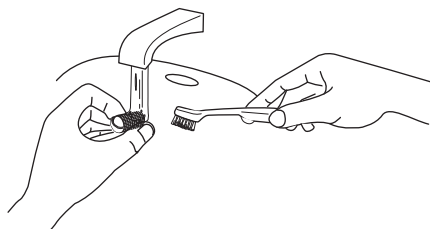

- 按拆除方向把喷嘴装回到初始位置。
- 上电检查喷管冲洗功能。

C. 滤网的清洗或更换

用户发现冲洗水量变小或出现不出水现象，请及时清洗或更换滤网。

坐便器滤网清洗

- 关掉电源，关闭角阀，取下滤网塞。

❶ 取下侧板

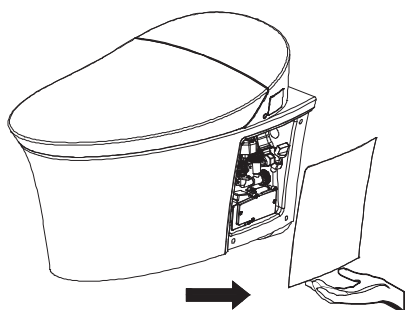

电源开关
关闭状态
(指示灯灭)

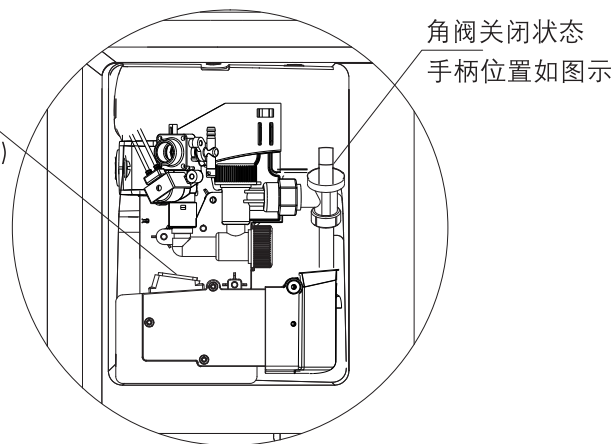

- 取出滤网，清洗滤网。

❷

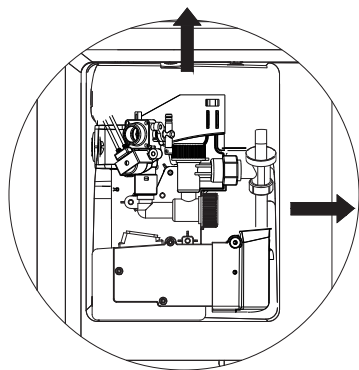

❸ 清洗滤网

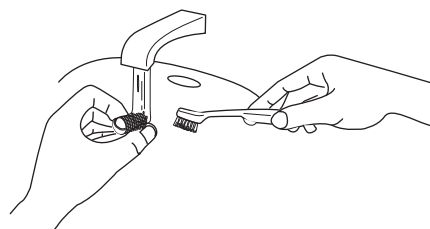

- 重新装好滤网，接上软管接头，打开角阀。
- 检查连接处，无任何水渗漏后，打开电源开关。
- 将侧板装回原位。

隐藏式水箱滤网清洗

按照安装说明书步骤操作(见安装说明P42--P48页)。

- 拆卸控制面板。
- 取出支撑板。
- 取出防水板。
- 旋转角阀的开关关闭水源。
- 如图将过滤器的锁紧螺母旋松取出，用清水清洗。
- 清洗完后装回原位。

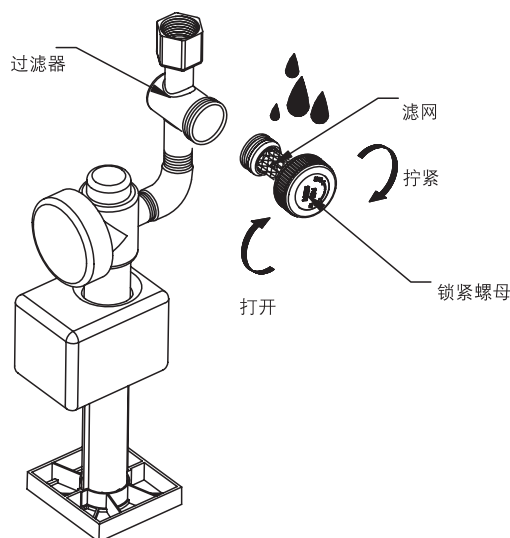

D. 除臭块的更换

用户发现除臭效果不明显，感觉有异味时，请及时更换除臭块。

更换除臭块步骤：

- 取出除臭百叶窗及除臭块。



- 更换新除臭块后，重新放回机体即可。

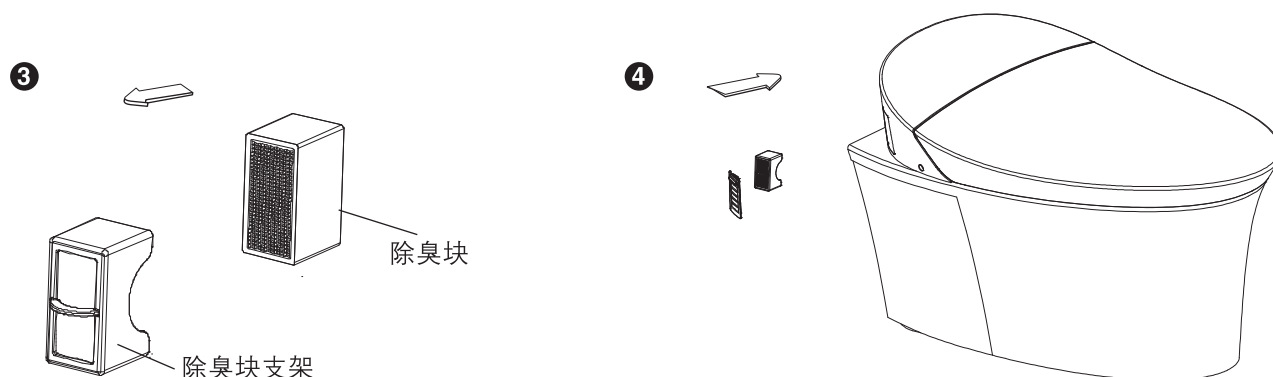

注：

取出除臭块后，请勿将手和其他物体伸入除臭块容纳腔内，以防损坏风机和其他部件。



扫码查看替换装，型号：22761T-NA。

E. 长期放置不用时的维护

a) 如果准备长期不使用智能座便盖，务必排尽座便盖内部管路中的积水：

- 关闭电源及角阀，使用细棒长按入小孔内的加热管的泄水按钮，排空加热管内的积水。

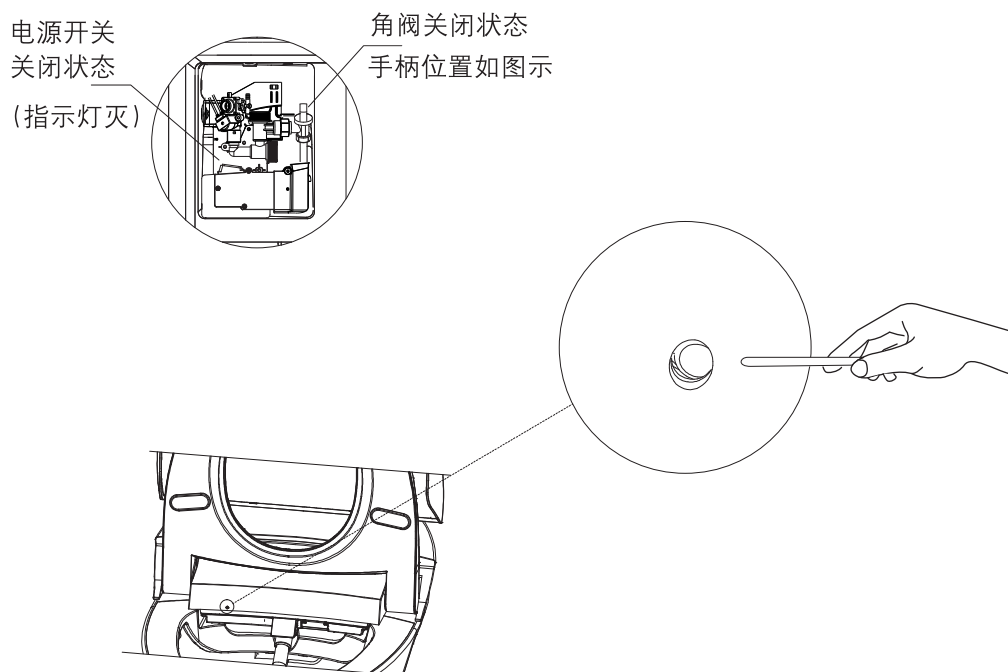

注：

1. 如果没有排尽积水而又长时间不使用该产品，残留水冬天容易冻结夏天容易变质。
 2. 冬天发现家中的供水管道已经冻结，不要马上使用智能座便盖，可以升高室内的温度，等待其自然解冻后再使用。
 3. 长期不用后再次使用时，请务必多进行几次冲洗，确保内部管路清洗干净。
 4. 长期不使用，请取出遥控器充电座中的电池。
- b) 长期放置不用时，可能会由于马桶里面水分挥发完毕后，下水道的气体溢出导致塑料件变黄风险，打开上盖或往马桶里面加水可有效避免该问题。

常见问题

本指南仅作一般帮助之用。科勒公司授权的服务代表或者合格电工应当能够解决所有的电气问题。如需了解担保服务，请联系您当地的经销商或批发商。

常见问题	可能原因	建议措施
1. 坐便器不工作	A. 停电 B. 产品处于保护状态 C. 产品处于关机状态	A. 等到电力恢复 B. 关闭接线盒上电源，再打开(见第31页的图示) C. 打开接线盒上的开关(见第31页的图示)
2. 坐便器不自动冲水	A. 停水 B. 供水角阀关闭 C. 停电 D. 产品处于关机状态 E. 自动冲水功能被禁止	A. 等到恢复供水 B. 打开供水角阀 C. 等待恢复电力或者查看“手动冲洗”部分进行手动冲洗。 D. 打开接线盒上的开关(见第31页的图示) E. 查看“遥控器设置指南”部分
3. 坐便器冲不干净	A. 过滤网阻塞 B. 手动按键行程不足	A. 查看“清洗过滤网”部分 B. 拆下出水控制面板，调节手动冲洗调节螺杆
4. 清洗功能无法正常使用	A. 停水 B. 供水角阀关闭或者未完全打开 C. 产品处于关机状态 D. 没有入座或者当前坐姿无法使座圈感应到 E. 过滤网阻塞 F. 供水水压不足	A. 等到恢复供水 B. 完全打开供水角阀 C. 打开接线盒上的开关(见31页的图示) D. 请入座或者调整坐姿 E. 查看“清洗过滤网”部分 F. 检查进水软管是否折弯过急，如折弯过急，请调整软管
5. 使用过程中冲洗功能停止工作	A. 连续冲洗5分钟后冲洗功能自动停止 B. 座圈未感应到人体	A. 如需要，请再次按下冲洗按键 B. 变换坐姿或者重新入座
6. 人体未入座时也能使用清洗功能	A. 座圈上有异物覆盖或者座圈是湿的	A. 移除异物或者擦干座圈
7. 使用过程中暖风风机停止工作	A. 连续使用暖风功能4分钟，风机自动停止 B. 座圈未感应到人体	A. 如需要，请再次按下暖风按键 B. 变换坐姿或者重新入座
8. 除臭风机不工作	A. 座圈未感应到人体 B. 使用过程中误按停止键 C. 自动除臭功能被禁止	A. 变换坐姿或者重新入座 B. 如需要，请离座2秒后重新入座 C. 查看“遥控器设置指南”部分
9. 不能开关盖	A. 座圈上有异物覆盖或者座圈是湿的 B. 便盖在先前开关过程中受到人为干扰	A. 移除异物或者擦干座圈 B. 使用遥控器开关便盖或手动打开便盖直至正常，便盖开关过程中不阻挡其开关
10. 不能自动开关盖	A. 用户没有进入或离开感应区域 B. 遥控器“自动翻盖”功能被关闭 C. 坐便器正在冲水中	A. 请进入或离开感应区域 B. 查看“遥控器设置指南”部分 C. 等待坐便器冲水结束
11. 夜灯不亮	A. 夜灯功能被关闭 B. 环境光线太亮	A. 查看“辅助键盘功能”中的夜灯部分来打开夜灯功能 B. 请关闭室内灯光并拉上窗帘或待光线较暗时确认
12. 紫外线杀菌不工作	A. 有人坐在坐便器上 B. 座圈上有异物覆盖或者座圈是湿的	A. 请离座后关闭盖子再重新开启紫外线杀菌及关闭坐便盖 B. 移除异物或者擦干座圈
13. 遥控器无显示	A. 电池电量耗尽 B. 电池极性装反 C. 遥控器未被唤醒	A. 更换新电池 B. 重新正确安装 C. 触摸遥控器屏幕 靠近坐便器或落座 按遥控器唤醒键

14. 遥控器无法遥控坐便器	A. 电池电量不足 B. 遥控器离坐便器太远 C. 坐便器本机没有上电 D. 坐便器本体处于关闭状态 E. 坐便器与遥控器未连接	A. 查看“遥控器电池的使用及更换”部分来更换电池 B. 查看“遥控器与本机的通讯”部分并靠近坐便器 C. 请给本体上电 D. 打开接线盒上的电源开关（见第31页的图示） E. 查看“遥控器与本机的通讯”部分，连接坐便器与遥控器
15. 落座时感觉座圈偏冷	A. 圈温关闭 B. 设置节能模式	A. 参照本手册遥控器使用指南设置圈温 B. 参照本手册遥控器使用指南使用方法退出节能模式
16. 进水阀不进水	A. 进水角阀没有打开 B. 进水阀的浮筒被其它零件挡住 C. 进水阀的浮筒被杂物粘住	A. 把进水角阀打开 B. 调整其它零件切勿与浮筒工作时位置接触 C. 用水清洗干净浮筒
17. 按下大、小排按钮时不排水	A. 调节板与螺丝杆安装错误 B. 排水阀的杠杆扣与倒扣没接上	A. 重新安装螺丝杆 B. 重新安装倒扣在排水阀杠杆扣
18. 水位太高或太低	A. 进水阀的浮筒没有调整好	A. 重新调整水位
19. 坐便器漏水	A. 水箱进水时进水阀的浮筒有杂物挡住，止不住水 B. 封水片有杂物	A. 调整其它零件切勿与浮筒工作时位置接触 B. 取出排水阀清洗封水片的杂物

如要检修此坐便器，您必须首先：

关闭接线盒上的开关（见第31页的图示）

如有需要，打开供水阀。

如需检修接线盒部分，请切断接线盒前端输入电源。

Scan the QR code for English manuals:



产品中有害物质含量的说明

回收提示

本产品超过使用期限或经过维修无法正常使用后，不应随意丢弃，请交由有废弃电器电子产品处理资质的企业处理，正确的处理方法请查阅国家或当地有关废旧电器电子产品处理的规定。

有害物质统计表

产品中有害物质的名称及含有的信息表										
部件名称	有害物质									
	铅 (Pb)	汞 (Hg)	镉 (Cd)	六价铬 (Cr(VI))	多溴联苯 (PBBs)	多溴 二苯醚 (PBDEs)	邻苯二甲酸 二正丁酯 (DBP)	邻苯二甲酸 二异丁酯 (DIBP)	邻苯二甲酸 丁苄酯 (BBP)	邻苯二甲酸二 (2-乙基) 己酯(DEHP)
塑料组件	○	○	○	○	○	○	○	○	○	○
控制类组件	×	○	○	○	○	○	○	○	○	○
PCBA 组件	×	○	○	○	○	○	○	○	○	○
电机类组件	×	○	○	○	○	○	○	○	○	○
导线类组件	○	○	○	○	○	○	○	○	○	○
进水组件	○	○	○	○	○	○	○	○	○	○
* 喷管组件	○	○	○	○	○	○	○	○	○	○
加热组件	×	○	○	○	○	○	○	○	○	○
* 遥控器组件	×	○	○	○	○	○	○	○	○	○
* 电池	○	○	○	○	○	○	○	○	○	○
* 陶瓷类组件	○	○	○	○	○	○	○	○	○	○
* 水箱组件	○	○	○	○	○	○	○	○	○	○

注1：○：表示该有害物质在该部件所有均质材料中的含量均不超出电器电子产品有害物质限制使用国家标准要求。

×：表示该有害物质至少在该部件的某一均质材料中的含量超出电器电子产品有害物质限制使用国家标准要求。

注2：以上未列出的部件，表明其有害物质含量均不超出电器电子产品有害物质限制使用国家标准要求。

*：表示部分机型含有该部件。

注：本表格提供的信息是基于供应商提供的数据及科勒公司的检测结果。

本产品应用环保设计理念，在当前技术水平下，所有有害物质或元素的使用已经控制到了最低程度，科勒公司会继续努力通过改善现有技术来减少这些物质的使用。



本产品的“环保使用期限”为10年，科勒公司根据产品设计特性指定该期限。只有在本产品使用说明书所述的正常情況下使用本产品时，“环保使用期限”才有效。