

# 安装说明

## 新悦3.0智能坐便器

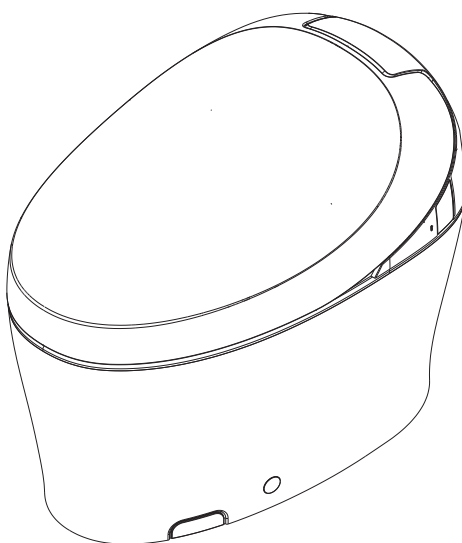













科勒（中国）投资有限公司  
中国上海市静安区江场三路158号 邮编: 200436  
制造商: 上海科勒电子科技有限公司  
中国上海市宝山区丰翔路1955号 邮编: 200444

THE BOLD LOOK  
OF **KOHLER**®

## 安全注意事项

---

-  **危险：** 存在触电风险。维修前应先断开电源。
-  **警告：** 存在财产受损风险。安装前请阅读所有说明。请遵循所有说明正确安装坐便器，以避免因安装不当而导致产品损坏。
-  **警告：** 存在触电风险。仅可连接至受接地故障电路断路器 (GFCI) 或漏电保护器 (RCD) 保护的已妥善接地的专用电路。使用 220 VAC、50 Hz、10 A 的电源。
-  **警告：** 存在触电风险。需要接地。所有电气连接均应由有资质的电工进行。
-  **警告：** 存在触电风险或产品损坏风险。请勿将遥控器放置在可能被水溅到的位置。请勿将遥控器浸入液体中。将遥控器、电源插座等电子器件与浴缸或淋浴器保持足够远的距离。使用防溅和防水的电源插座。
-  **警告：** 在安装本产品时切勿使用任何凝胶材料（水泥砂浆）。凝胶材料（水泥砂浆）的热膨胀可能使产品挤破或损坏。科勒公司对所有因为使用凝胶材料（水泥砂浆）安装而引起的坐便器损坏恕不负责。
-  **警告：** 存在人身伤害和产品损坏风险。产品较重，若操作不当，玻化陶瓷外壳可能会破损或裂开。坐便器应由两人使用适当的抬升技巧一起抬起。
-  **警告：** 存在人身伤害和产品损坏风险。拆箱时，切勿通过抓住座圈的边缘提起坐便器。
-  **小心：** 存在有害气体风险。若不立即安装新的坐便器，请暂时将一块抹布放置在地板上法兰中。
-  **小心：** 存在产品损坏风险。在安装工作完成之前请勿接通电源，否则可能导致产品故障。
-  **小心：** 存在财产受损风险。在安装本产品的同一房间中，需要在触手可及的位置安装一个止水阀。用于紧急情况下，无需借助工具即可切断本产品的进水水路；否则本产品的意外故障可能会导致用户损失。
-  **小心：** 存在产品损坏风险。在固定坐便器时，请勿过度拧紧螺丝。若螺丝拧的过紧，玻化陶瓷外壳可能会破裂。

**重要信息!** 对于 K-37981T-\*\* 和 K-37983T-\*\*, 确认坐便器坑距为 12" (305 mm), 允许  $\pm 1-1/8"$  (28 mm) 公差。对于 K-37982T-\*\* 和 K-37984T-\*\*, 确认坐便器坑距为 15-3/4" (400 mm), 允许  $\pm 1-1/8"$  (28 mm) 公差。若未满足, 可能会影响安装。

**重要信息!** 供水止水阀凸出成品墙外的部分应不超过 1/8" (3 mm), 沉入成品墙内的部分应不超过 3/16" (5 mm)。若未满足, 可能会影响安装。

**重要信息!** 使用本产品自带的供水软管和角阀。请勿重复使用旧软管和旧角阀。

**重要信息!** 请勿在坐便器后方安装会妨碍盖板抬起的物品。

**重要信息!** 为了避免受到其他设备的干扰, 将遥控器放置在距离手机或吹风机等电器足够远的位置。

**重要信息!** 首次使用前, 拆下坐便器上预装的滤芯, 并安装随附的新滤芯。

**注意：** 确保待钻孔位置的下方没有水管或电线。

**注：** 浴室内安装的插座（若有）应距离浴缸或淋浴器至少 39-3/8" (1000 mm)。

**注：** 连接供水之前, 用自来水或可供饮用水彻底冲洗供水管, 以清除杂质。

**注：** 遥控器基座应安装在如厕坐姿时可轻松触及的位置。



**注：**当坐便器已接通电源时，坐便器将自动进入启动程序。此程序包括喷管移动、水管通水和夜灯闪烁。启动程序完成后，坐便器不再发出声响。

**注：**橙色滤芯指示灯表示滤芯即将到期。滤芯指示灯闪烁橙色表示滤芯已过期，需要更换。若滤芯未安装到位，滤芯指示灯将交替闪烁橙色和白色。

**注：**仅在通电时更换滤芯。若在断电情况下更换滤芯，橙色滤芯指示灯警示将无法解除。供电恢复后卸下滤芯并重新安装滤芯将重置滤芯指示灯，以免滤芯指示灯警示未解除而保持闪烁或亮起状态。

**注：**仅在坐便器有用户落座时，清洗功能才会工作。若测试清洗功能，必须覆盖落座感应区域。

**注：**测试清洗功能时，用塑料袋覆盖座圈或者用手盖住喷管。

本说明书中的所有信息均基于出版时可用的最新产品信息。科勒公司保留随时更改产品特性、包装或供货情况的权利，恕不另行通知。

安装前，确保为坐便器预留足够的空间，且不会影响门的开合。

请遵守当地管道安装、建筑及电气条例。

建议使用直径为 15 mm 的水管或内径大于 15 mm 的水管。

切勿使用科勒公司不推荐的配件（例如角阀）。

为达到更好的冲水效果，用户在进行 PPR 管连接时，应避免因热熔而导致明显的缩径或热熔挤出物堵塞管道的现象，并确保连接后管道的内径不小于 9/16" (15 mm)。

切断电源后如需重新接通电源，务必等待坐便器发出的蜂鸣声结束后再接通电源。

固定布线中心必须配有触电开距，以便在过电压等级 III 条件下完全断开电源。

检查新的坐便器是否损坏。

电源线与供水管线应采用墙内安装方式。

若在安装本产品时遇到任何问题，请联系您的经销商或批发商，或通过本手册提供的联系方式联系客户服务中心。

## 接地说明

---

本产品应接地。发生短路时，接地为电流提供逃逸通路，从而降低触电风险。本产品配有一条电源线，此电源线有一条接地线和一个接地插头。此插头必须插入已妥善安装和接地的电源插座中。

 **危险：存在触电风险。不正确使用接地插头可能会导致触电风险。**

如有必要维修或更换电线或插头，请勿把接地线连接至接线片。具有绿色外表面的绝缘线（无论是否带有黄色条纹）是接地线。

若未完全理解接地说明，或者不确定产品是否已妥善接地，应向有资质的电工或维修人员核实。

本产品出厂时已配有特定的电线和插头，以便连接至适当的电路中。确认本产品已连接至与插头具有相同配置的插座中。本产品不应使用任何适配器。请勿改装随附的插头。若插头与插座不匹配，应由有资质的电工安装合适的插座。若必须重新连接本产品以便用于其它类型的电路，应由有资质的维修人员进行连接。

本产品不应使用延长电线。

# 感谢您选择科勒

---

需要帮助？请联系我们的客户服务中心。

- 中国大陆：+(86) 800-820-2628, +(86) 400-820-2628
- 中国香港、中国澳门、中国台湾：+(852) 3125-7728
- 保养和清洁：[kohler.com.cn/support/care-and-cleaning/](http://kohler.com.cn/support/care-and-cleaning/)

## 工具和材料

---

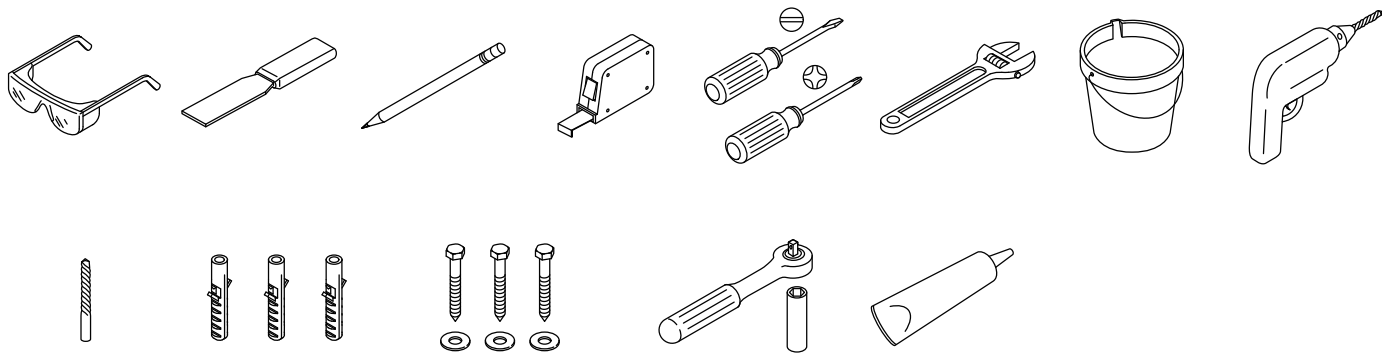

10 mm 钻头    10 mm 膨胀胶粒    10 mm 螺栓和垫圈    13 mm 深套筒扳手    密封硅胶

以及：

- 垫子或其他防护材料
- 塑料袋（可选）

# 产品信息

注： 更多产品规格，请查阅产品随附的《用户指南》。

冲水用水量	大冲： 1.0 加仑（3.8 升）
	小冲： 0.8 加仑（3.0 升）
水效等级*	2 级
坑距	K-37981T-**/K-37983T-**： 12" (305 mm)
	K-37982T-**/K-37984T-**： 15-3/4" (400 mm)
供水压力	最小进水压力： 0.07 MPa（动压）
	最大进水压力： 0.74 MPa
额定电压	220V~， 50 Hz
额定功率*	990W
产品尺寸	约 28-3/16" (716 mm) 长 x 17-15/16" (456 mm) 宽 x 20-13/16" (529 mm) 高
产品重量	约 101.4 磅（46 千克）
进水温度	33.8°F (1°C ) - 95°F (35°C)
使用环境温度	33.8°F (1°C) - 104°F (40°C)

注： 功率值测试条件：动压： 2 bar (0.2 Mpa)；进水温度： 15°C (59°F)；座圈温度： 关闭座圈温度档位，运行至座圈温度稳定状态；水温： 关闭水温档位，运行冲洗程序至水温稳定状态

注： 坐便器上加施的水效标识表示本产品的水效等级等性能，是产品符合性的一种标识。

## 开箱指导

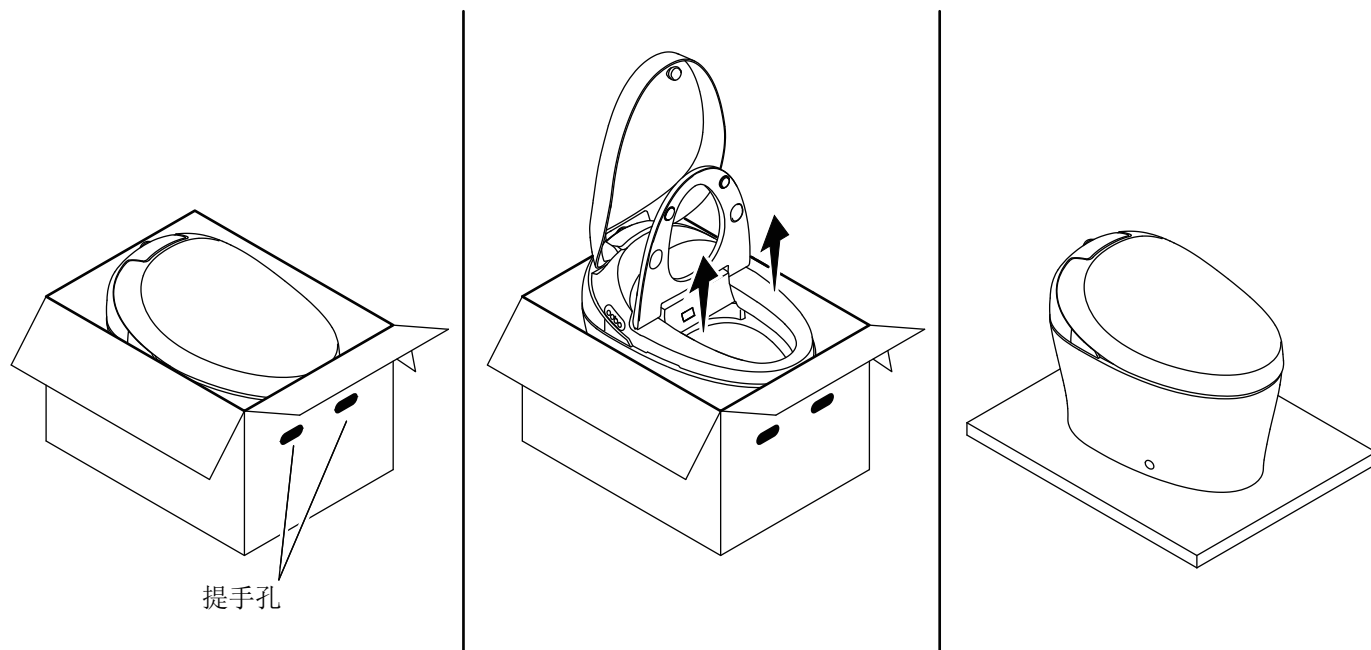

**⚠ 警告：** 存在人身伤害和产品损坏风险。产品较重，若操作不当，玻化陶瓷外壳可能会破损或裂开。坐便器应由两人使用适当的抬升技巧一起抬起。

**⚠ 警告：** 存在人身伤害和产品损坏风险。切勿通过抓住座圈的边缘提起坐便器。

**重要信息！** 错误的坐便器开箱方式可能导致产品损坏。请遵照说明打开坐便器的包装。

**注：** 安装过程中请保留产品塑料包装袋，以避免可能造成的物理损坏。

- ☐ 确认箱子朝向与图示一致，即提手孔靠近箱子顶部。
- ☐ 打开包装箱。
- ☐ 正确握住坐便器缸体的边缘，将坐便器抬起。
- ☐ 小心将坐便器放置在足够大的垫子或其他防护材料上，确保坐便器放稳。推荐的垫子或防护材料尺寸：不小于 31-1/2" (800 mm) 长 x 31-1/2" (800 mm) 宽。

## 1. 安装场地准备

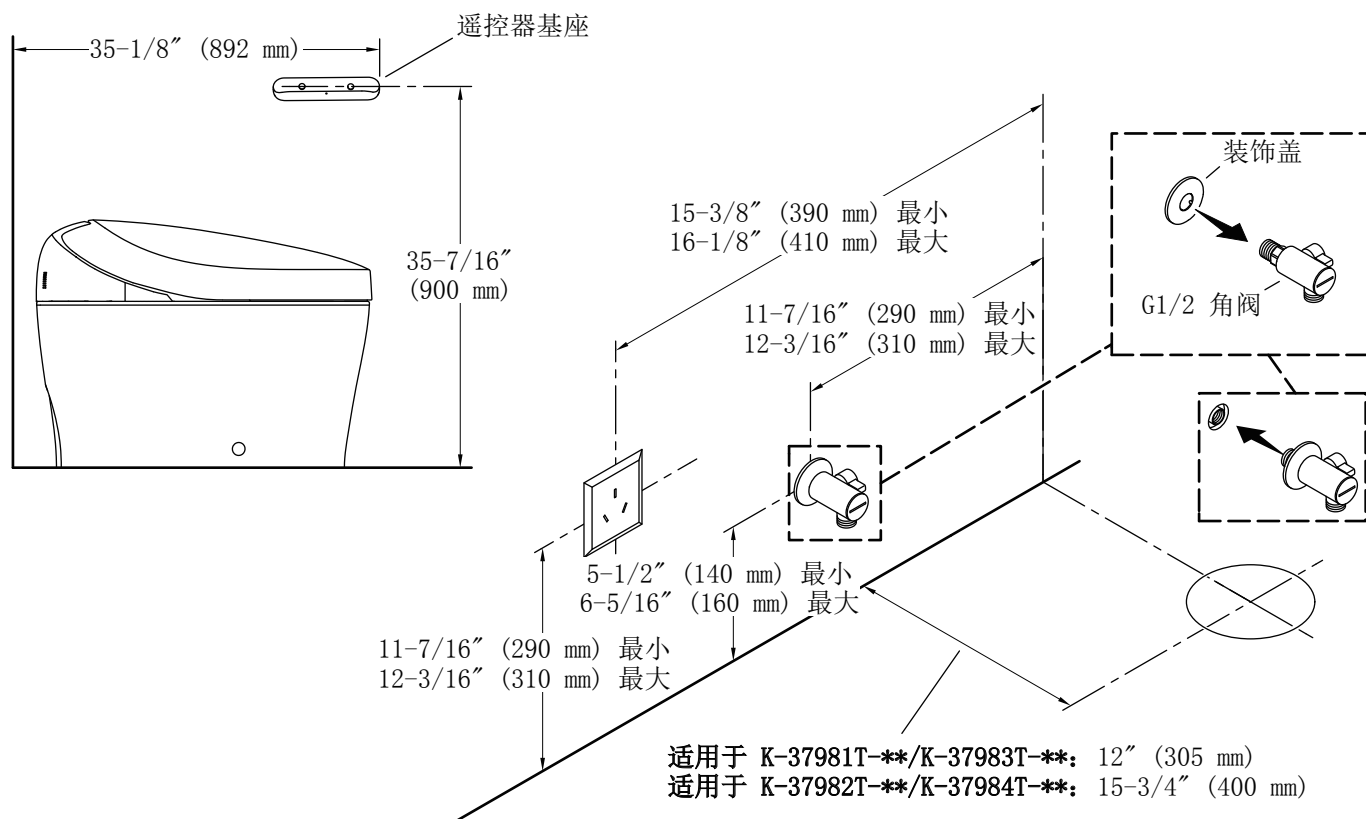

**⚠ 危险：** 存在触电风险。安装前先断开电源。

**⚠ 警告：** 存在触电风险。仅可连接至受接地故障电路断路器 (GFCI) 或漏电保护器 (RCD) 保护的已妥善接地的专用电路。使用 220 VAC、50 Hz、10 A 的电源。

**⚠ 警告：** 存在触电风险或产品损坏风险。将遥控器、电源插座等电子器件与浴缸或淋浴器保持足够远的距离。使用防溅和防水的电源插座。

**重要信息！** 对于 K-37981T-\*\*-K-37983T-\*\*：安装坐便器前，确认地板出水口的中心离成品墙面 12" (305 mm)。对于 K-37982T-\*\*-K-37984T-\*\*：安装坐便器前，确认地板出水口的中心离成品墙面 15-3/4" (400 mm)。请参阅“产品信息”章节，了解您的坐便器型号的坑距要求。坑距的最大公差为 1-1/8" (28 mm)。

**重要信息！** 请勿在坐便器后方安装会妨碍盖板抬起的物品。

**注意：** 电源线与供水管线应采用墙内安装方式。请勿将角阀或电源插座放置在坐便器正后方。建议放置在上图所示的位置。确保所有安装均符合适用的规范。

**注：** 请勿重复使用旧角阀。

**注：** 供水管路和电源线可布置在坐便器的任意一侧。

当坐便器的动作感应检测到动作时，坐便器盖板将会自动打开。可使用遥控器来调节动作感应灵敏度或禁用动作感应。请参阅《用户指南》。

### 安装供水系统

- 将随附的装饰盖穿插到随附的 G1/2 角阀上（如图所示）。
- 安装 G1/2 角阀。
- 接好角阀之后，请排水至目视清洁为止。

### 安装供电装置

**注：** 坐便器凸出至外部的电源线长度约为 43-5/16" (1100 mm)。

- 安装一个 220 VAC、50 Hz 的专用接地型插座，此插座应受接地故障电路断路器 (GFCI) 或漏电保护器 (RCD) 保护。插座安装区域如图所示。

## 2. 拆除旧的坐便器（若有）

---

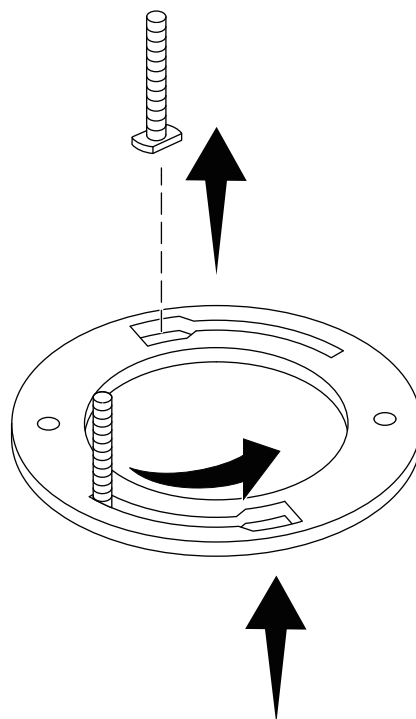
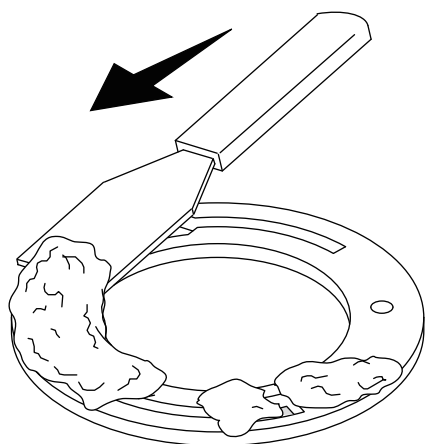

**⚠ 小心：存在有害气体风险。若不立即安装新的坐便器，请暂时将一块抹布放置在排水孔中。**

- ☐ 关闭供水阀。
- ☐ 冲洗坐便器，用海绵吸干水箱和坐便器缸体内剩余的水。
- ☐ 关闭供水止水阀（若有），拆除旧的水箱和坐便器缸体。
- ☐ 将法兰上残留的蜡屑清除干净。
- ☐ 卸下法兰上的 T 型螺栓。
- ☐ 将地板上的法兰拆下，并废弃旧的 T 型螺栓和法兰。

### 3. 放置坐便器

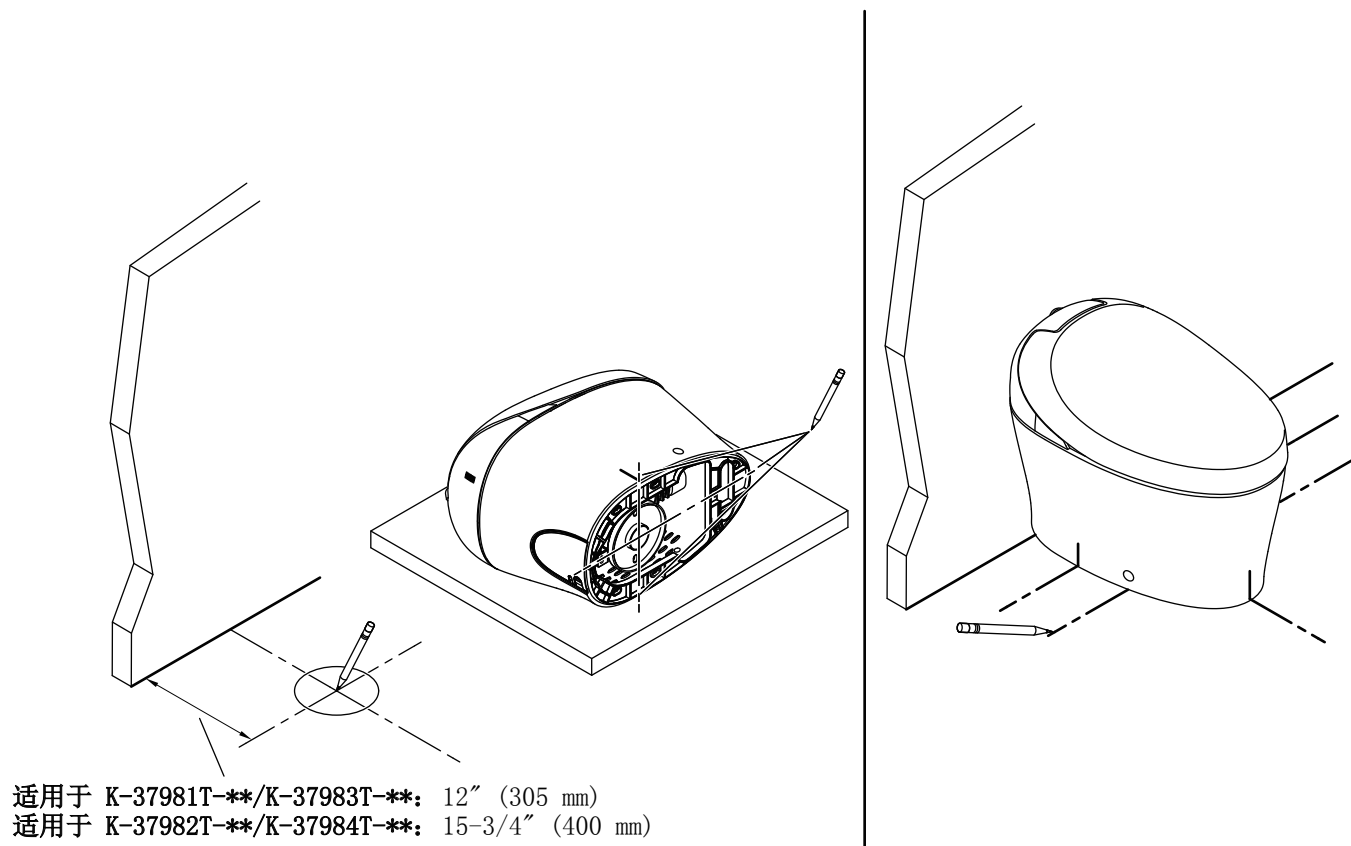

**警告：** 存在人身伤害和产品损坏风险。产品较重，若操作不当，玻化陶瓷外壳可能会破损或裂开。坐便器应由两人使用适当的抬升技巧一起抬起。

**警告：** 存在人身伤害和产品损坏风险。切勿通过抓住座圈的边缘提起坐便器。

- ☐ 确定排水孔的中心点，用“+”标记出与墙壁垂直的中心线。
- ☐ 将坐便器水平放置在垫子或其他防护材料上。
- ☐ 确定安装在坐便器上的排污管的中心点。在坐便器的四侧标出中心线。
- ☐ 将坐便器小心地轻放于地板上。确认坐便器与地板上标记的排水孔中心线对齐。
- ☐ 在坐便器左右两侧标出支架安装孔位置的中心线。



## 4. 钻安装孔

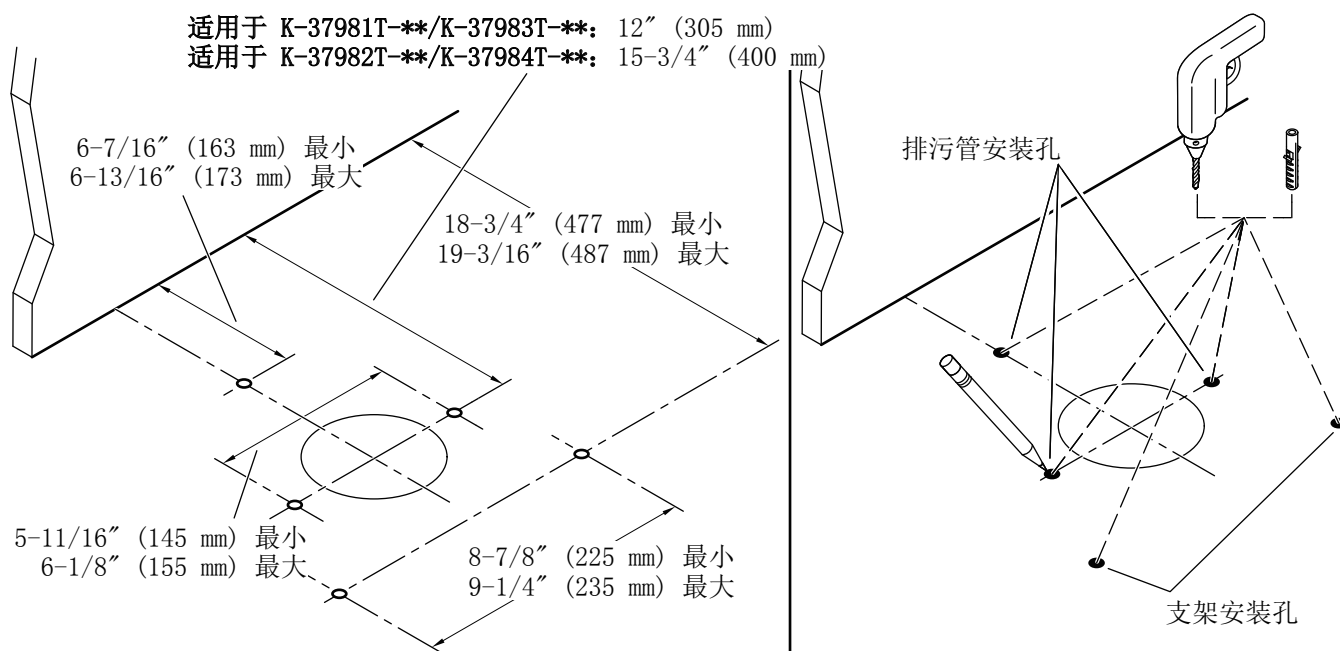

**注意：** 确保待钻孔位置的下方没有水管或电线。

- ☐ 根据给出的测量值在地板上标记出安装孔位置。
- ☐ 在标记位置钻 10 mm 的孔。
- ☐ 将随附的膨胀胶粒分别插入各支架安装孔。
- ☐ 将 10 mm 膨胀胶粒（未随附）分别插入各排污管安装孔。

## 5. 放置排污管

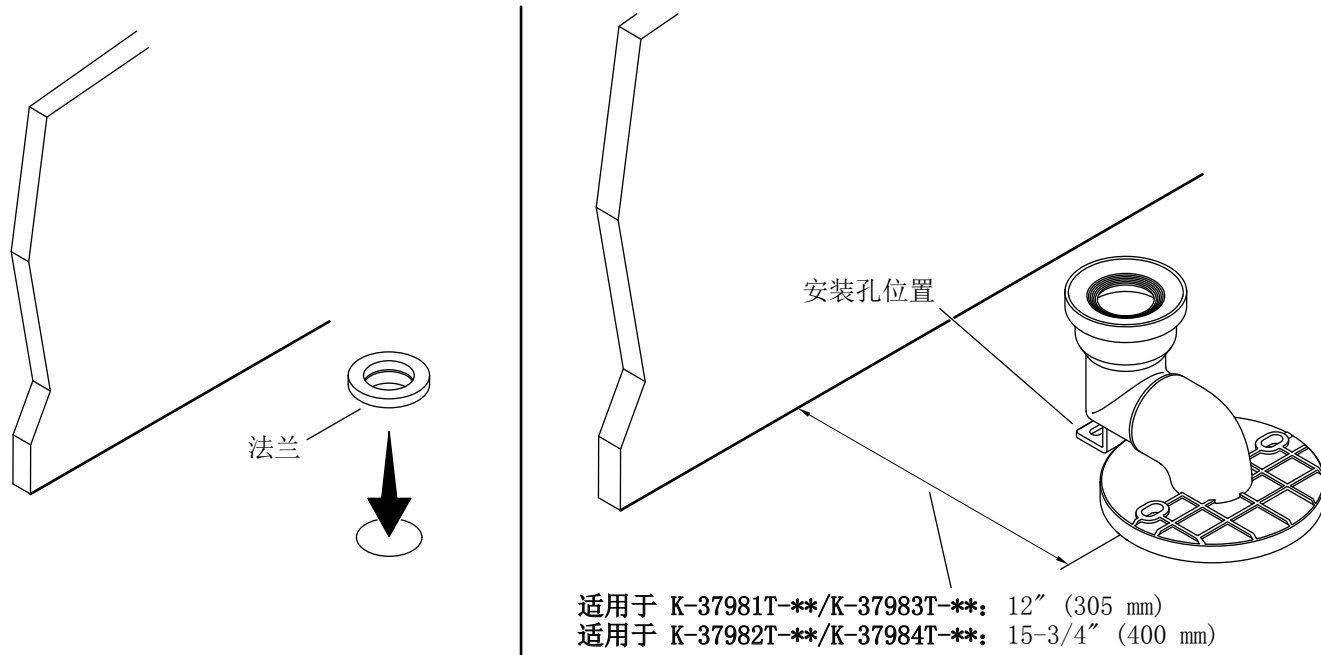

- 将随附的法兰与地板上的排水孔对齐。
- 按压法兰，使其固定在地板上。
- 小心将排污管放置在地板排水孔上方，使其与安装孔对齐。

## 6. 安装支架和排污管

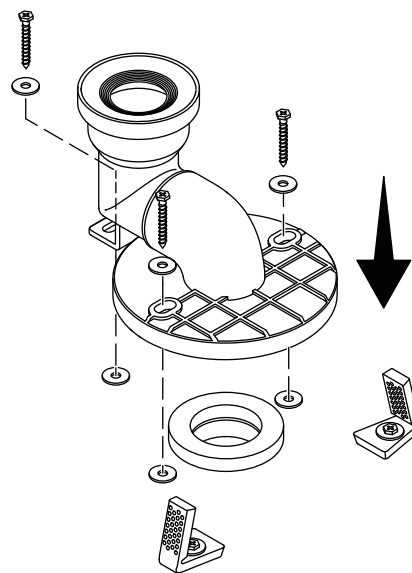
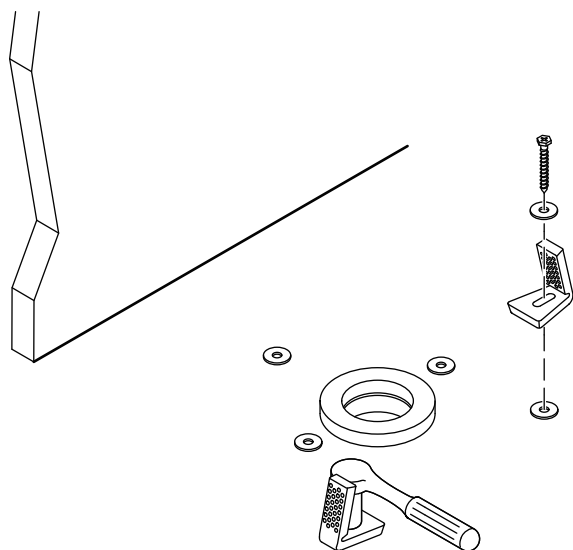

**注：** 客户需自备三套螺栓和垫圈，以便安装排污管。

- ☐ 使用两套随附的螺栓和垫圈将支架安装在地板上。
- ☐ 将排污管与排水孔对齐。
- ☐ 用螺栓和垫圈（未随附）将排污管固定在地板上。

## 7. 安装坐便器

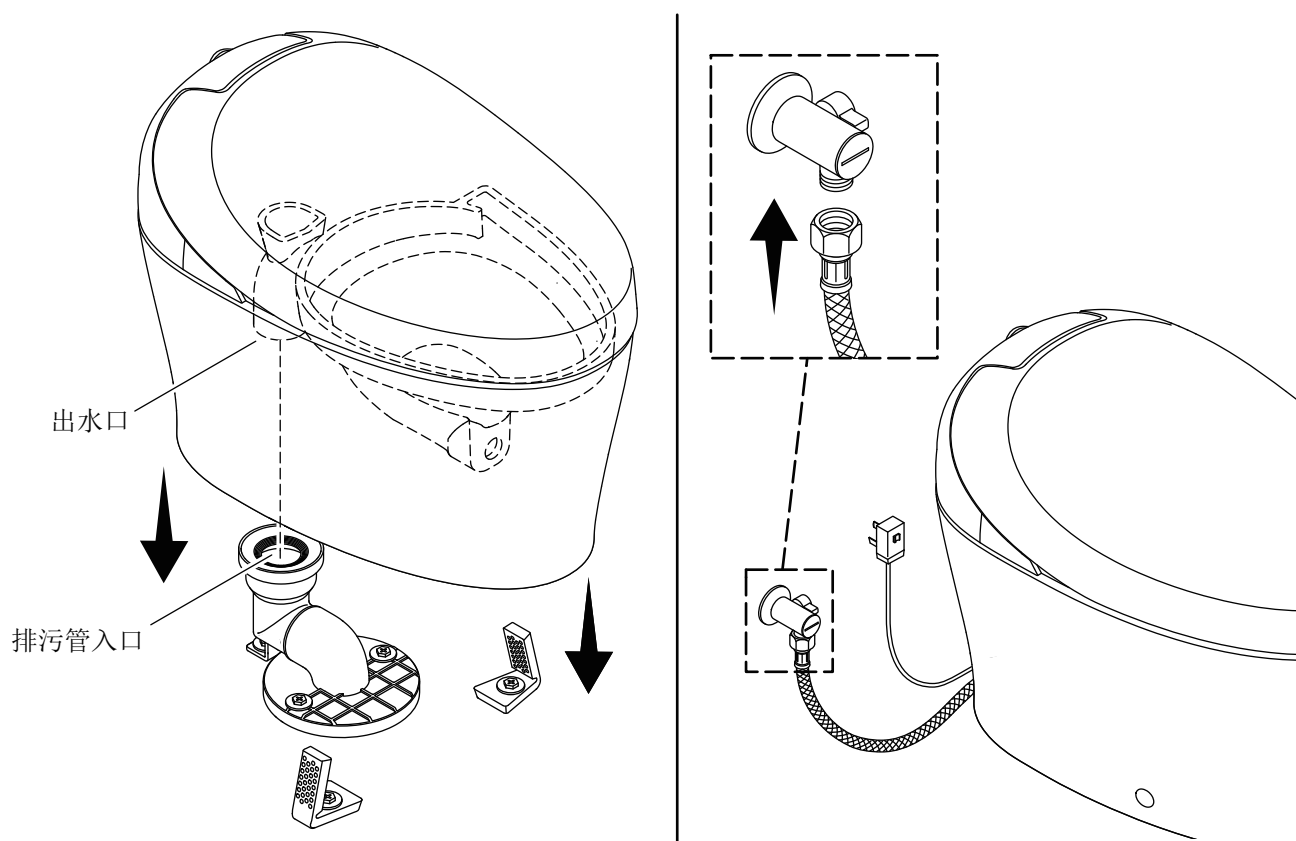

**⚠ 警告：** 存在人身伤害和产品损坏风险。产品较重，若操作不当，玻化陶瓷外壳可能会破损或裂开。坐便器应由两人使用适当的抬升技巧一起抬起。

**⚠ 警告：** 存在人身伤害和产品损坏风险。切勿通过抓住座圈的边缘提起坐便器。

**注：** 连接供水前，先打开 G1/2 角阀彻底冲洗供水管，以清除各种杂质。

- ☐ 安装时，将供水管和电源线从坐便器后方引出。
- ☐ 在他人协助下，将坐便器抬到排污管上方，并将出水口对准排污管入口。
- ☐ 小心地将坐便器放到排污管上。
- ☐ 确认供水管和电源线没有夹在坐便器下方。
- ☐ 将供水管连接至 G1/2 角阀。
- ☐ 打开供水阀。

## 8. 固定坐便器

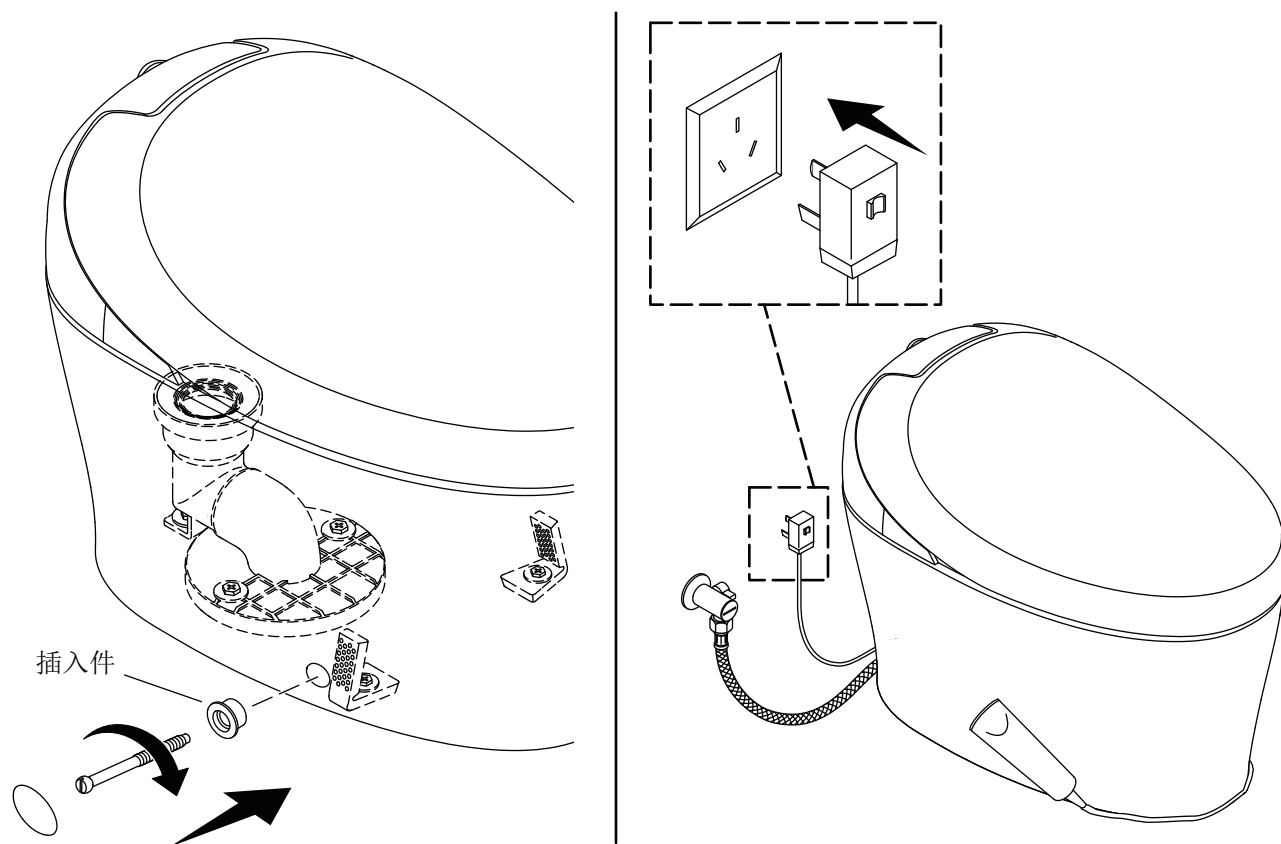

**警告：** 存在触电风险。请勿使用未接地插座。仅可连接至受接地故障电路断路器 (GFCI) 或漏电保护器 (RCD) 保护的已妥善接地的专用电路。使用 220 VAC、50 Hz、10 A 的电源。

**小心：** 存在产品损坏风险。请勿过度拧紧螺丝。若螺丝过度拧紧，玻化陶瓷外壳可能会破损或裂开。

**注：** 当坐便器接通电源时，坐便器将自动进入启动程序。此程序包括喷管移动、水管通水和夜灯闪烁。启动程序完成后，坐便器不再发出声响。

- ☐ 将插入件分别放入坐便器两侧的孔中。
- ☐ 将螺丝插入孔中并拧紧。**不可过度拧紧！**
- ☐ 为每个螺丝安装一个螺帽。螺帽应与坐便器的外缘齐平。
- ☐ 将电源线插入电源插座。
- ☐ 等待夜灯停止闪烁。夜灯停止闪烁表示启动程序已完成。
- ☐ 按压冲水按钮，使坐便器充分注水。
- ☐ 检查所有连接处有无漏水，并根据需要进行调整。
- ☐ 在坐便器外侧边缘与地板之间的接缝处涂抹透明密封硅胶。（注：脚感视窗与地板连接处打胶高度建议不超过5mm，以免影响感应效果）
- ☐ 按照密封硅胶制造商的说明，使密封硅胶固化。

## 9. 安装滤芯

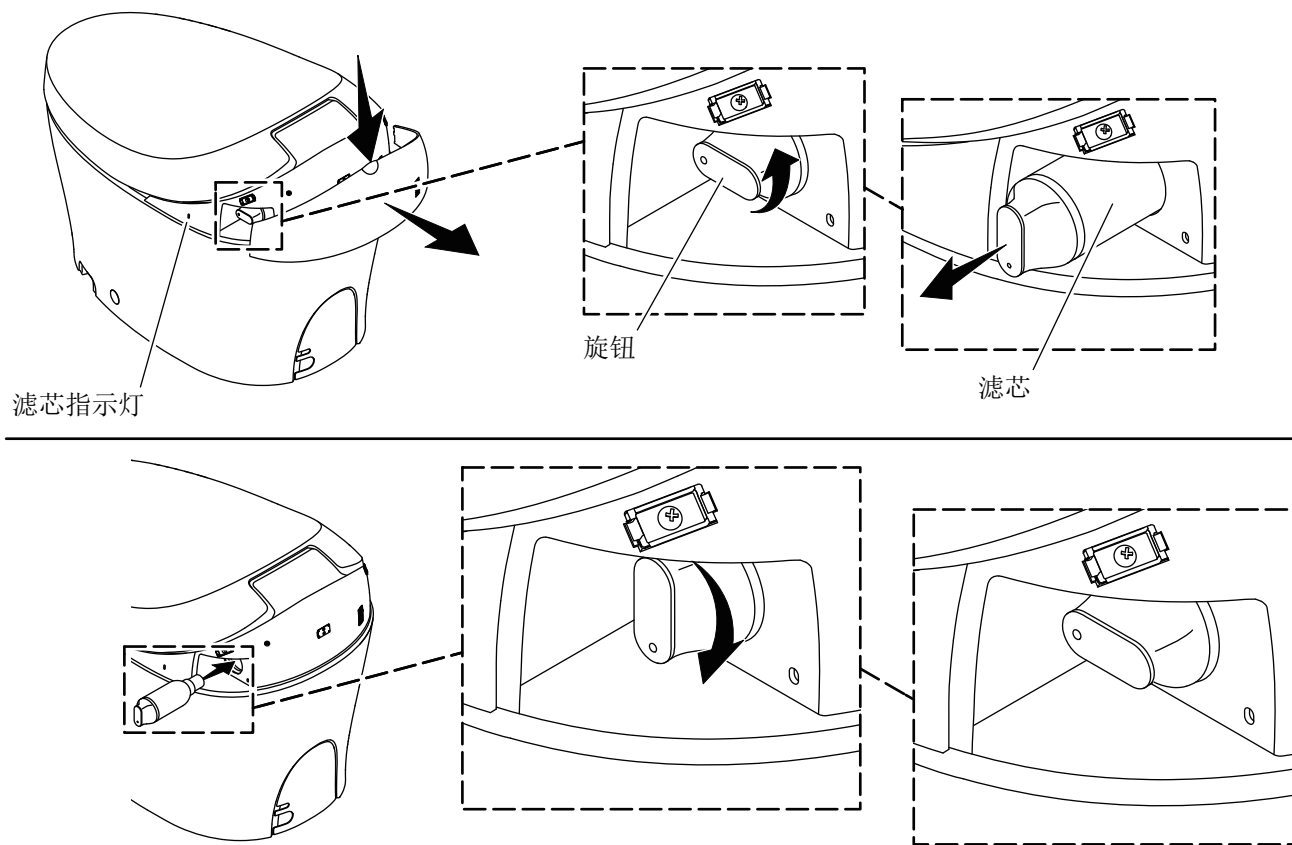

**重要信息!** 首次使用前，拆下坐便器上预装的滤芯，并安装随附的新滤芯。

**注：** 橙色滤芯指示灯表示滤芯即将到期。滤芯指示灯闪烁橙色表示滤芯已过期，需要更换。

**注：** 安装时，确认旋钮的方向如图所示。若滤芯未安装到位，滤芯指示灯将交替闪烁橙色和白色。

**注：** 仅在通电时更换滤芯。若在断电情况下更换滤芯，橙色滤芯指示灯警示将无法解除。供电恢复后卸下滤芯并重新安装滤芯将重置滤芯指示灯，以免滤芯指示灯警示未解除而保持闪烁或亮起状态。

- ☐ 按图示方向轻推，以拆下后盖。
- ☐ 旋转旋钮，拆下预装的滤芯。
- ☐ 安装随附的新滤芯。适当按压并旋转旋钮，将新滤芯固定到位。
- ☐ 重新安装后盖。

## 10. 安装遥控器基座和遥控器电池

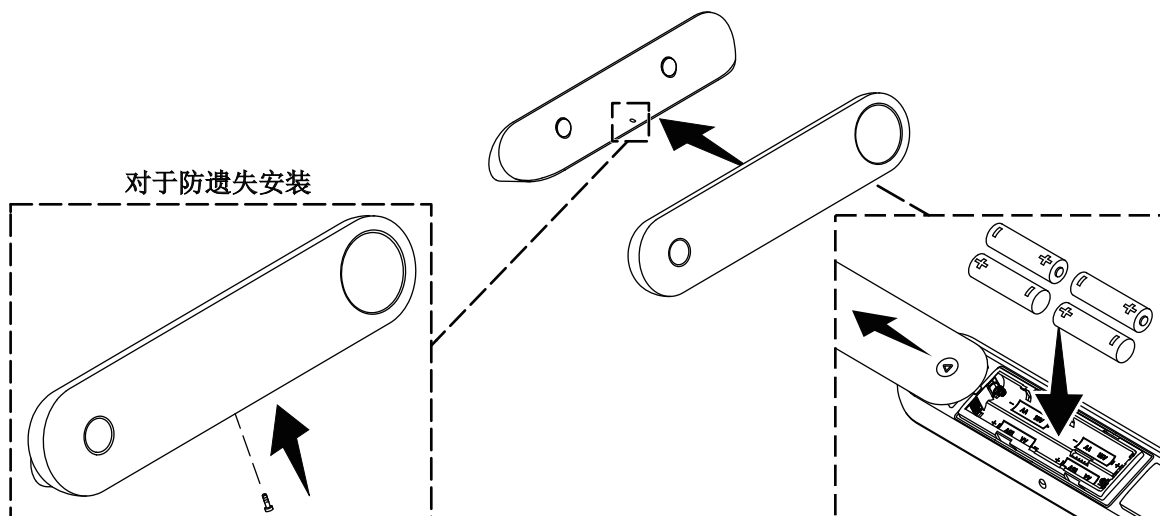
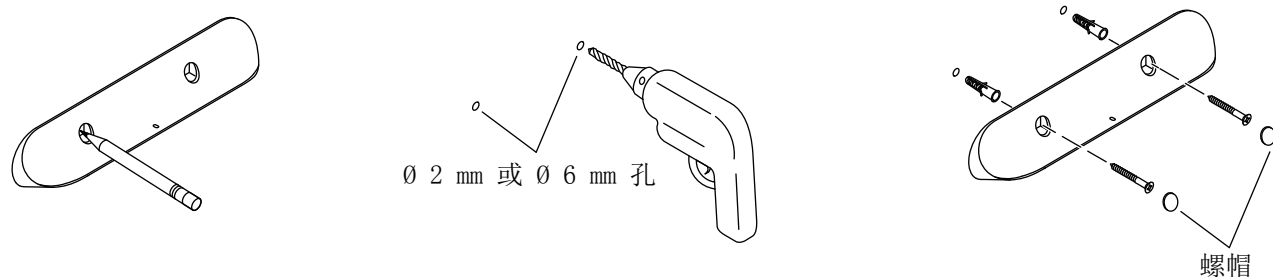

**⚠ 小心：** 存在产品损坏风险。请勿将遥控器放置在可能被水溅到的位置。请勿将遥控器浸入液体中。

**重要信息！** 为了避免受到其他设备的干扰，将遥控器放置在距离手机或吹风机等电器足够远的位置。

**注：** 遥控器基座应安装在如厕坐姿时可轻松触及的位置。

- ☐ 将遥控器基座放在所需的安装位置。
- ☐ 确认遥控器基座呈水平状态。
- ☐ 使用铅笔标记两个安装孔位置。
- ☐ **若安装在密度板或其它木质表面：** 在每个标记位置钻一个 2 mm 的孔。
- ☐ **若使用膨胀胶粒进行安装：** 在每个标记位置钻一个 6 mm 的孔，孔深大于 45 mm。将随附的膨胀胶粒安装到孔中。
- ☐ 将遥控器基座置于膨胀胶粒上或记号处。使用随附的螺丝固定。
- ☐ 安装随附的螺帽。
- ☐ 按压箭头区域周围，并如图所示滑动，以取下遥控器电池盖。
- ☐ 按图示朝向安装随附的四节 5 号电池。
- ☐ 将遥控器电池盖重新安装到位。
- ☐ 将遥控器置于遥控器基座上。
- ☐ **对于防遗失安装：** 安装随附的螺丝，将遥控器固定到遥控器基座上。

## 11. 安装检验

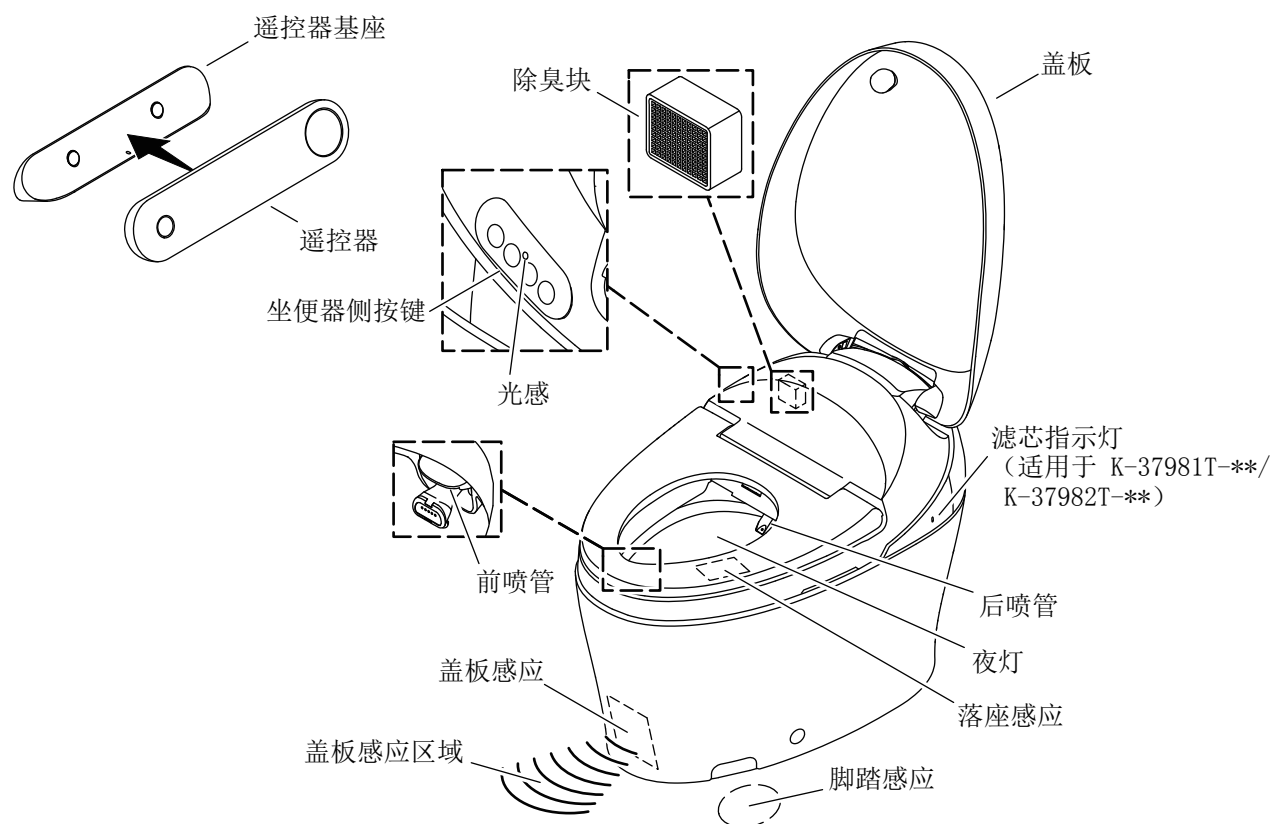

**注：**当坐便器已接通电源时，坐便器将自动进入启动程序。此程序包括喷管移动、水管通水和夜灯闪烁。启动程序完成后，坐便器不再发出声响。

**注：**仅在坐便器有用户落座时，清洗功能才会工作。若测试清洗功能，必须覆盖落座感应区域。

**注：**测试坐便器功能前，先移除产品的外包装塑料袋。

**注：**测试清洗功能时，用塑料袋覆盖座圈或者用手盖住喷管。

- ☐ 确认进水阀已打开。
- ☐ 确认电源已连接。
- ☐ 确认遥控器电池已正确安装。
- ☐ 确认坐便器前方无任何遮挡物。
- ☐ 确认坐便器已完成启动程序。
- ☐ 用手盖住喷管或用塑料袋覆盖座圈。
- ☐ 用手或湿布按压位于座圈右前侧的落座感应区域。
- ☐ 使用遥控器测试坐便器功能。
- ☐ 如需一般故障排除辅助信息，请参阅产品随附的《用户指南》。





英文版请扫二维码













Please scan the QR code for English manuals.

# Installation Instructions

## Smart Toilet

### Safety Precautions

---

-  **DANGER: Risk of electric shock.** Disconnect the power before servicing.
-  **WARNING: Risk of property damage.** Read all the instructions before installation. Follow all the instructions for installing the toilet correctly to avoid damage related to improper installation.
-  **WARNING: Risk of electric shock.** Connect only to a properly grounded dedicated circuit protected by a Ground Fault Circuit Interrupter (GFCI) or Residual Current Device (RCD). Use 220 VAC, 50 Hz, 10 A service.
-  **WARNING: Risk of electric shock.** Grounding is required. A qualified electrician should make all electrical connections.
-  **WARNING: Risk of electric shock or product damage.** Do not place the remote control in a location that could be splashed with water. Do not immerse the remote control into liquids. Keep the electrical components such as the remote control and electrical outlet far enough away from the bath or shower. Use an anti-splash and waterproof electrical outlet.
-  **WARNING: Do not use any hard setting material (cement mortar) while installing the product.** Thermal expansion of hard setting material (cement mortar) will damage the product. Kohler Co. will not be responsible for any damage because of using hard setting material (cement mortar) for toilet installation.
-  **WARNING: Risk of personal injury and product damage.** This product is heavy. The vitreous shell may chip or break if handled carelessly. Lift the toilet with two people, using proper lifting technique.
-  **WARNING: Risk of personal injury and product damage.** When unpacking, **DO NOT grab the product by the rim of the bidet seat to lift the toilet.**
-  **CAUTION: Risk of hazardous gases.** If the new toilet is not installed immediately, temporarily place a rag in the floor flange.
-  **CAUTION: Risk of product damage.** Do not connect the power until the installation is completed to avoid product failure.
-  **CAUTION: Risk of property damage.** When installing the product in the room, a stop valve should be installed within certain distance. For emergency circumstances, users should be able to close the water inlet valve without using any tools; otherwise unexpected failure may cause losses to the customer.
-  **CAUTION: Risk of product damage.** When securing the toilet, do not overtighten the screws. The vitreous shell may chip or break if the screws are overtightened.

**IMPORTANT!** For K-37981T-\*\* and K-37983T-\*\*, verify that the toilet pit distance is 12" (305 mm) which allows a tolerance of  $\pm 1\text{-}1/8"$  (28 mm). For K-37982T-\*\* and K-37984T-\*\*, verify that the toilet pit distance is 15-3/4" (400 mm) which allows a tolerance of  $\pm 1\text{-}1/8"$  (28 mm). Otherwise, the installation will be compromised.

**IMPORTANT!** The water supply stop should be 1/8" (3 mm) Max outside the finished wall and 3/16" (5 mm) Max inside the finished wall. Otherwise, the installation will be compromised.

**IMPORTANT!** Use the supply hose and valve provided with the product. Do not reuse a previously installed hose and valve.

**IMPORTANT!** Do not install items behind the toilet that will interfere with the cover when the cover is raised.

**IMPORTANT!** To avoid interference from other devices, install the remote control in a location far enough away from the electrical appliances such as hand dryer or hair dryer.

**IMPORTANT!** Before initial use, remove the filter preinstalled on the toilet and install the new provided filter.

**ATTENTION:** Make sure that there is no water pipe or electrical wires under the holes to be drilled.

**NOTE:** Receptacles (if any) installed in the bathroom should be located at least 39-3/8" (1000 mm) from the bath or shower.

**NOTE:** Before connecting the water supply, flush any debris in the water supply hose with tap water or water that meet drinking water standard.

**NOTE:** The remote control docking station should be mounted in a location that is easily accessible from a seated position on the toilet.

**NOTE:** When electrical power is connected to the toilet, the toilet will automatically go through a start-up sequence. The sequence includes wand movement, waterline purge, and nightlight blinks. The toilet will go silent when the start-up sequence is complete.

**NOTE:** The orange filter light indicates that the filter will be expired soon. The flashing orange filter light indicates that the filter has expired and needs to be replaced. If the filter is not secured into place, the filter light will flash orange and white alternatively.

**NOTE:** Only replace the filter when the power is ON. The orange filter light will NOT turn off if the filter is replaced when the power is OFF. Uninstalling and reinstalling the filter when the power is restored will reset the filter light and prevent the filter light from flashing or staying on.

**NOTE:** The toilet cleansing features will not function without an occupant. To test cleansing features, the occupancy sensor area must be covered.

**NOTE:** When testing the cleansing features, cover the seat with plastic wrap or cover the wand with your hand.

All information in the instructions is based upon the latest product information available at the time of publication. Kohler Co. reserves the right to make changes to product characteristics, packaging, or availability at any time without notice.

Before installation, verify that there is sufficient space for the toilet which will not affect the opening or closing of the door.

Follow all local plumbing, building, and electrical codes.

Recommend to use a DN 15 mm pipe or pipe with internal diameter greater than 15 mm.

Do not use attachments (such as angle valve) that are not recommended by Kohler Co.

In order to achieve better flush performance, the user should avoid any obvious pipe necking or blockage from thermal melt during PPR pipe connection and ensure the pipe has an internal diameter of no less than 9/16" (15 mm) after connection.

To reconnect the power supply after the power supply is shut off, wait until the beeping sound ends.

The fixed wiring center must be equipped with electric shock opening in order to disconnect the power completely when level III overvoltage condition occurs.

Inspect the new toilet for any damage.

The power supply and water supply lines should be wall mounted.

If you encounter any complications with installing the product, contact your dealer or wholesale distributor, or contact the Customer Care Center using the information located in the front of this manual.

## Grounding Instructions

---

This product should be grounded. In the event of an electrical short circuit, grounding reduces the risk of electric shock by providing an escape wire for the electric current. This product is equipped with a cord having a grounding wire with a grounding plug. The plug must be plugged into an electrical outlet that is properly installed and grounded.



**DANGER: Risk of electric shock.** Improper use of the grounding plug can result in a risk of electric shock.

If repair or replacement of the cord or plug is necessary, do not connect the grounding wire to either flat blade terminal. The wire with insulation having an outer surface that is green with or without yellow stripes is the grounding wire.

Check with a qualified electrician or service personnel if the grounding instructions are not completely understood, or if in doubt whether the product is properly grounded.

This product is factory equipped with a specific electric cord and plug to permit connection to a proper electric circuit. Verify that the product is connected to an outlet having the same configuration as the plug. No adapter should be used with this product. Do not modify the plug provided. If the plug does not fit the outlet, have the proper outlet installed by a qualified electrician. If the product must be reconnected for use on a different type of electric circuit, the connection should be made by qualified service personnel.

Do not use an extension cord with the product.

# Thank You for Choosing KOHLER

Need help? Contact our Customer Care Center.

- Mainland China: +(86) 800-820-2628, +(86) 400-820-2628
- Hong Kong (China), Macau (China), Taiwan (China): +(852) 3125-7728
- Care and cleaning: [kohler.com.cn/support/care-and-cleaning/](http://kohler.com.cn/support/care-and-cleaning/)

## Tools and Materials

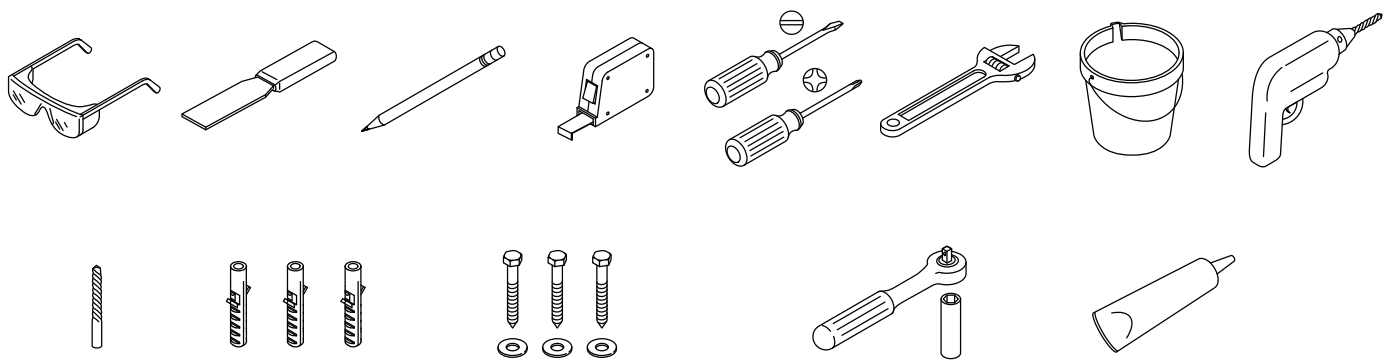

10 mm Drill Bit 10 mm Anchors 10 mm Bolts and Washers 13 mm Deep Socket Wrench Silicone Sealant

**Plus:**

- Cushion or other protective material
- Plastic Wrap (Optional)

## Product Information

**NOTE:** For more product specifications, refer to the Homeowners Guide packed with the product.

Flushing Volume	Full Flush: 1.0 gal (3.8 L)
	Eco Flush: 0.8 gal (3.0 L)
Water Efficiency Grade*	Grade 2
Rough-In Distance	K-37981T-** / K-37983T-**: 12" (305 mm)
	K-37982T-** / K-37984T-**: 15-3/4" (400 mm)
Water Supply	Min Inlet Water Pressure: 0.07 MPa (dynamic pressure)
	Max Inlet Water Pressure: 0.74 MPa
Rated Voltage	220 VAC, 50 Hz
Rated Power*	990W
Product Dimensions	About 28-3/16" (716 mm) L x 17-15/16" (456 mm) W x 20-13/16" (529 mm) H
Product Weight	About 101.4 lb (46 kg)
Inlet Water Temperature	33.8°F (1°C) - 95°F (35°C)
Environmental Temperature	33.8°F (1°C) - 104°F (40°C)

**NOTE:** Power value test conditions: dynamic pressure: 2 bar (0.2 Mpa); inlet water temperature: 15°C (59°F); seat temperature: stable, with seat temperature setting deactivated; water temperature: run a wash feature until the water temperature is stable, with water temperature setting deactivated

**NOTE:** The water efficiency label applied to the toilet indicates the water efficiency grade and other performance of the product, which is a marking of product conformity.

## Unpacking Notice

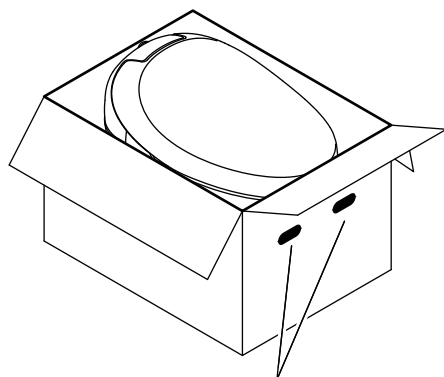

Cutout for Handles

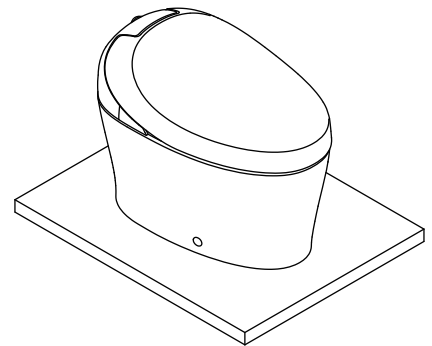
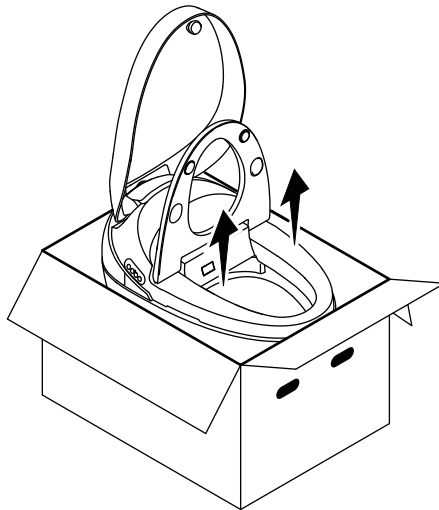

**⚠ WARNING: Risk of personal injury and product damage.** This product is heavy. The vitreous shell may chip or break if handled carelessly. Lift the toilet with two people, using proper lifting technique.

**⚠ WARNING: Risk of personal injury and product damage. DO NOT grab the product by the rim of the bidet seat to lift the toilet.**

**IMPORTANT!** Incorrectly unpacking the toilet may damage the product. Follow the instructions to unpack the toilet.

**NOTE:** Keep the plastic film wrapping the product during installation to avoid potential physical damage to the product.

- ☐ Verify that the box is oriented with the cutout for handles near the top of the box, as shown.
- ☐ Unpack the toilet.
- ☐ Lift up the toilet by properly holding the bowl rim of the toilet.
- ☐ Carefully place the toilet on a large enough cushion or other protective material that will hold the toilet securely.  
Recommended cushion or protective material size: No smaller than 31-1/2" (800 mm) L x 31-1/2" (800 mm) W.

# 1. Prepare the Site

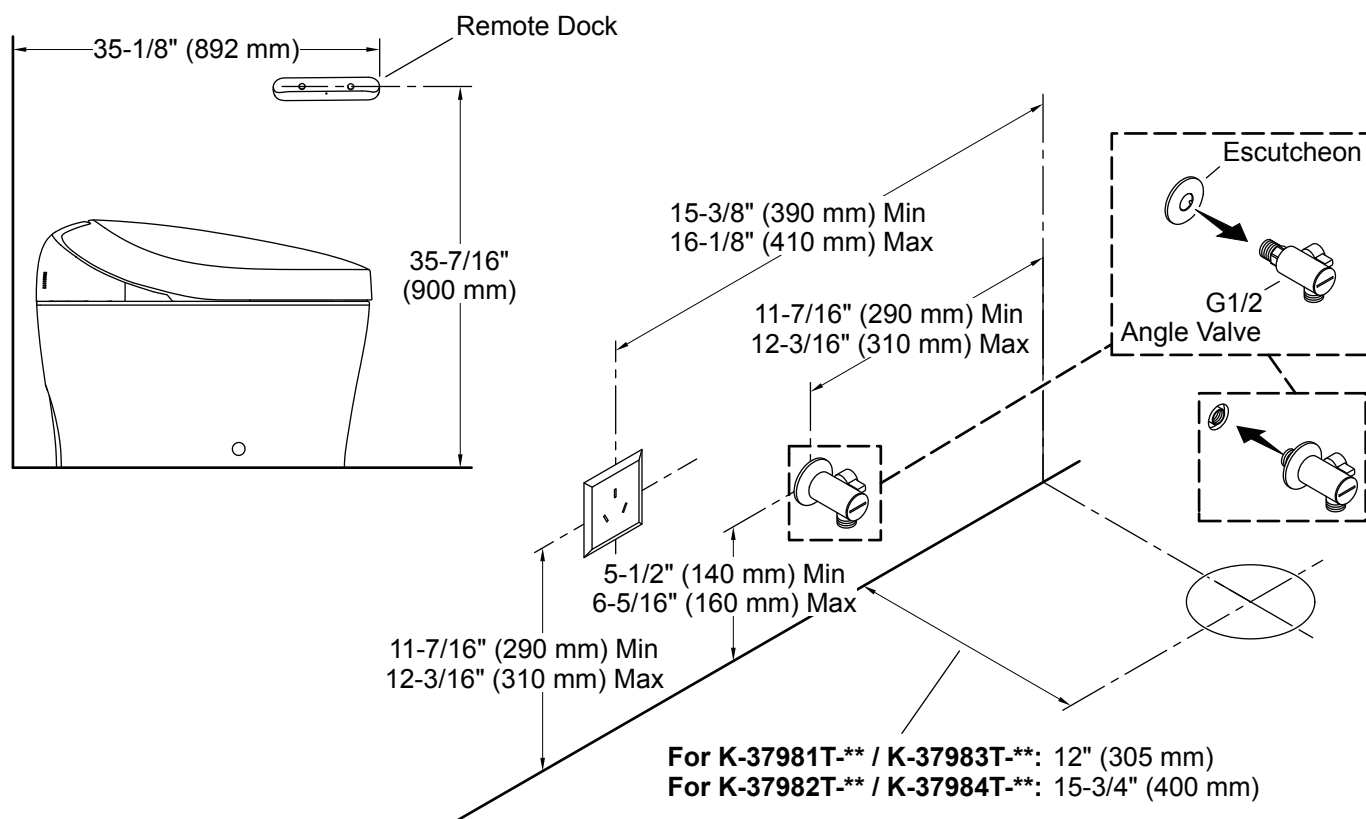

**⚠ DANGER: Risk of electric shock.** Disconnect the power before installation.

**⚠ WARNING: Risk of electric shock.** Connect only to a properly grounded dedicated circuit protected by a Ground Fault Circuit Interrupter (GFCI) or Residual Current Device (RCD). Use 220 VAC, 50 Hz, 10 A service.

**⚠ WARNING: Risk of electric shock or product damage.** Keep the electrical components such as the remote control and electrical outlet far enough away from the bath or shower. Use an anti-splash and waterproof electrical outlet.

**IMPORTANT!** For K-37981T-\*\* / K-37983T-\*\*: Before installing the toilet, confirm that the center of the floor outlet is 12" (305 mm) from the finished wall. For K-37982T-\*\* / K-37984T-\*\*: Before installing the toilet, confirm that the center of the floor outlet is 15-3/4" (400 mm) from the finished wall. Refer to the "Product Information" section for the specific rough-in distance of your toilet model. The maximum tolerance for the rough-in distance is 1-1/8" (28 mm).

**IMPORTANT!** Do not install items behind the toilet that will interfere with the cover when the cover is raised.

**NOTICE:** The power supply and water supply lines should be wall mounted. Do not locate the angle valve or electrical outlet directly behind the toilet. The locations illustrated above are suggested. Verify that all installations adhere to applicable codes.

**NOTE:** Do not reuse a previously installed angle valve.

**NOTE:** The water supply line and power line can be either side of the toilet.

The toilet is equipped with a motion sensor to automatically open the cover when movement is sensed. Sensitivity can be adjusted or turned off using the remote control. Refer to the Homeowners Guide.



**Install the Water Supply**

- ☐ Insert the provided escutcheon onto the provided G1/2 angle valve, as shown.
- ☐ Install the G1/2 angle valve.
- ☐ After connecting the angle valve, drain the water until it is visually clean.

**Install the Electrical Service**

**NOTE:** The toilet power cord is approximately 43-5/16" (1100 mm) in length outside of the toilet.

- ☐ Install a dedicated 220 VAC, 50 Hz grounding-type receptacle, protected by a Ground Fault Circuit Interrupter (GFCI) or Residual Current Device (RCD), within the dimensions shown.

## 2. Uninstall the Existing Toilet (If Any)

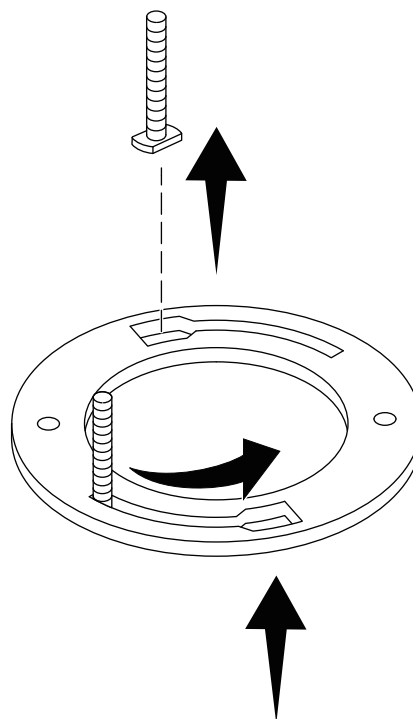
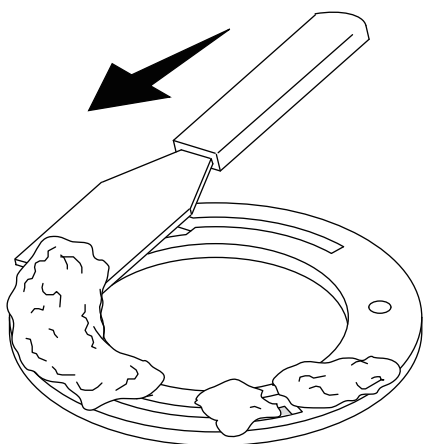

**⚠ CAUTION: Risk of hazardous gases.** If the new toilet is not installed immediately, temporarily place a rag in the drain hole.

- ☐ Turn OFF the water supply.
- ☐ Flush the toilet, and use a sponge to remove the remaining water from the tank and bowl.
- ☐ Disconnect water supply shut-off valve (if any), and remove the residual tank and bowl.
- ☐ Scrape away any remaining wax residue from the flange.
- ☐ Uninstall T-bolts from the flange.
- ☐ Remove the flange from the floor and discard the T-bolts and flange.

### 3. Position the Toilet

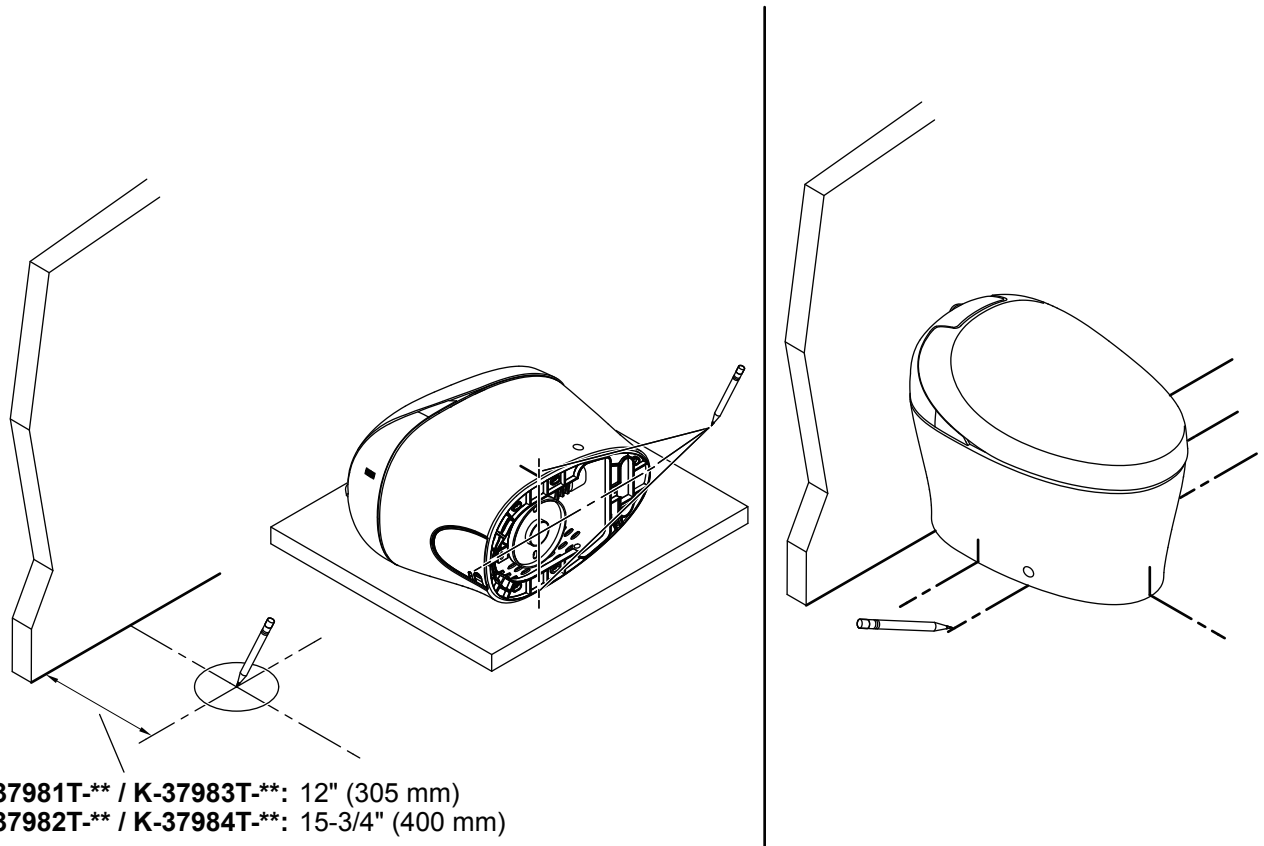

**⚠ WARNING: Risk of personal injury and product damage.** This product is heavy. The vitreous shell may chip or break if handled carelessly. Lift the toilet with two people, using proper lifting technique.

**⚠ WARNING: Risk of personal injury and product damage. DO NOT grab the product by the rim of the bidet seat to lift the toilet.**

- ☐ Identify the centerpoint of the drain hole and mark the "+" centerlines perpendicular to the wall.
- ☐ Carefully place the toilet horizontally on the cushion or other protective material.
- ☐ Identify the centerpoint of a trapway mounted on the toilet. Mark the centerlines on all four sides of the toilet.
- ☐ Carefully lower the toilet onto the floor. Verify that the toilet is aligned to the centerline of the drain hole marked on the floor.
- ☐ Mark the centerline of the bracket mounting hole positions on both the left and right sides of the toilet.

## 4. Drill the Mounting Holes

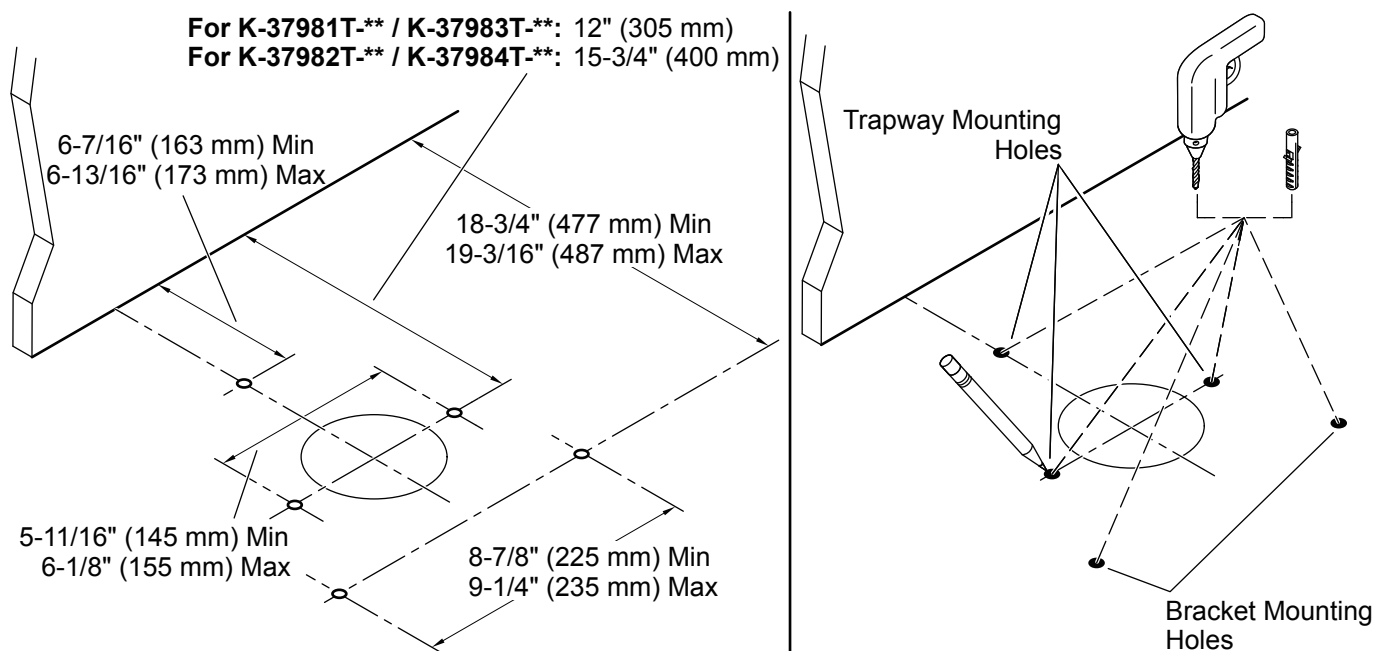

**ATTENTION:** Make sure that there is no water pipe or electrical wires under the holes to be drilled.

- ☐ Mark the mounting hole on the floor according to given measurements.
- ☐ Drill the 10 mm holes on the marked positions.
- ☐ Insert a provided anchor into each of the bracket mounting holes.
- ☐ Insert a 10 mm anchor (not provided) into each of the trapway mounting holes.

## 5. Position the Trapway

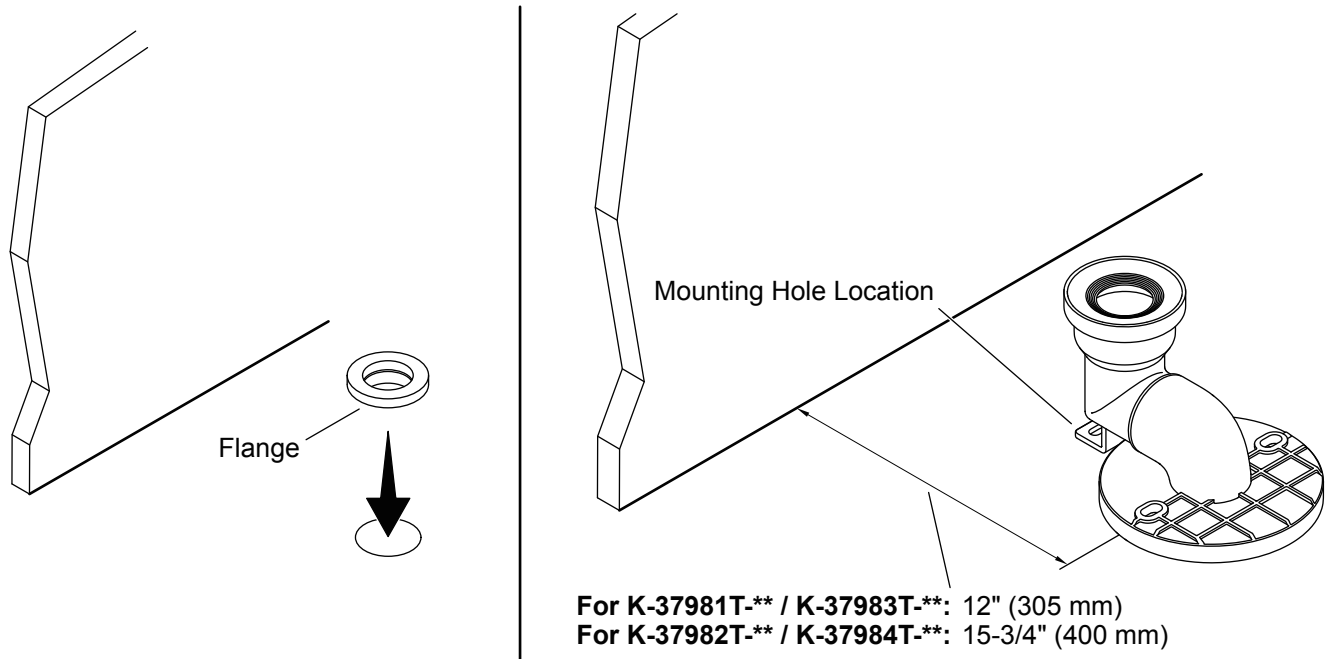

- ☐ Align the provided flange with the drain hole on the floor.
- ☐ Press the flange to secure on the floor.
- ☐ Carefully position the trapway over the floor drain hole, aligning the mounting holes.

## 6. Install the Brackets and Trapway

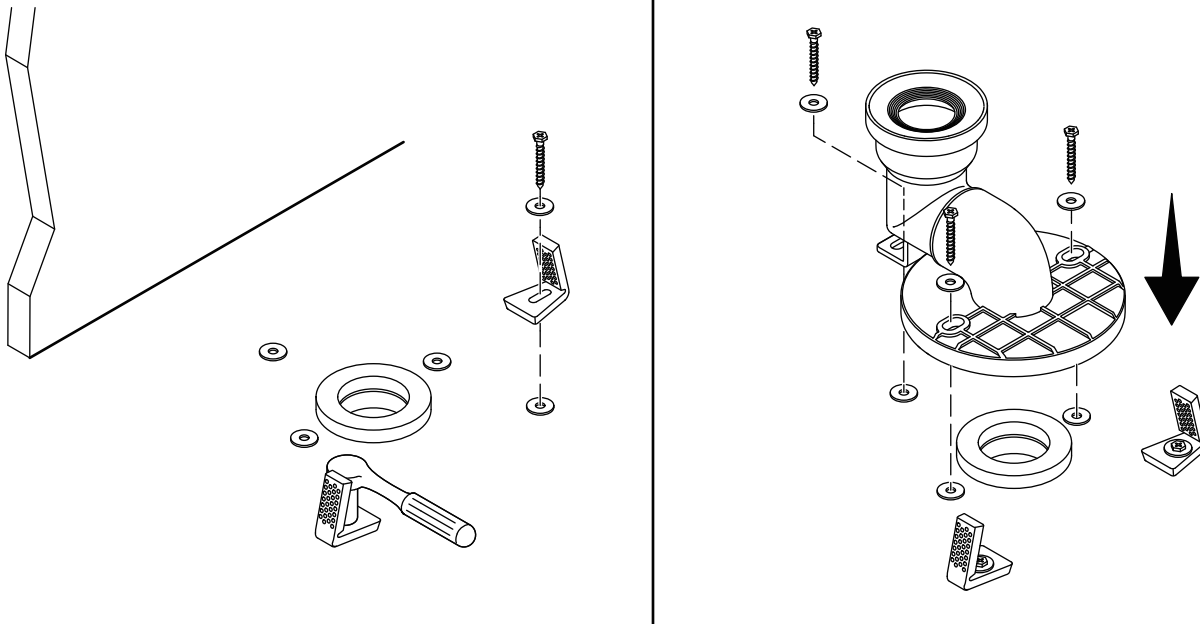

**NOTE:** Three sets of bolts and washers to be arranged by the customer for trapway installation.

- ☐ Install the brackets on the floor using the two sets of provided bolts and washers.
- ☐ Align the trapway with the drain hole.
- ☐ Secure the trapway on the floor with the bolts and washers (not provided).

## 7. Install the Toilet

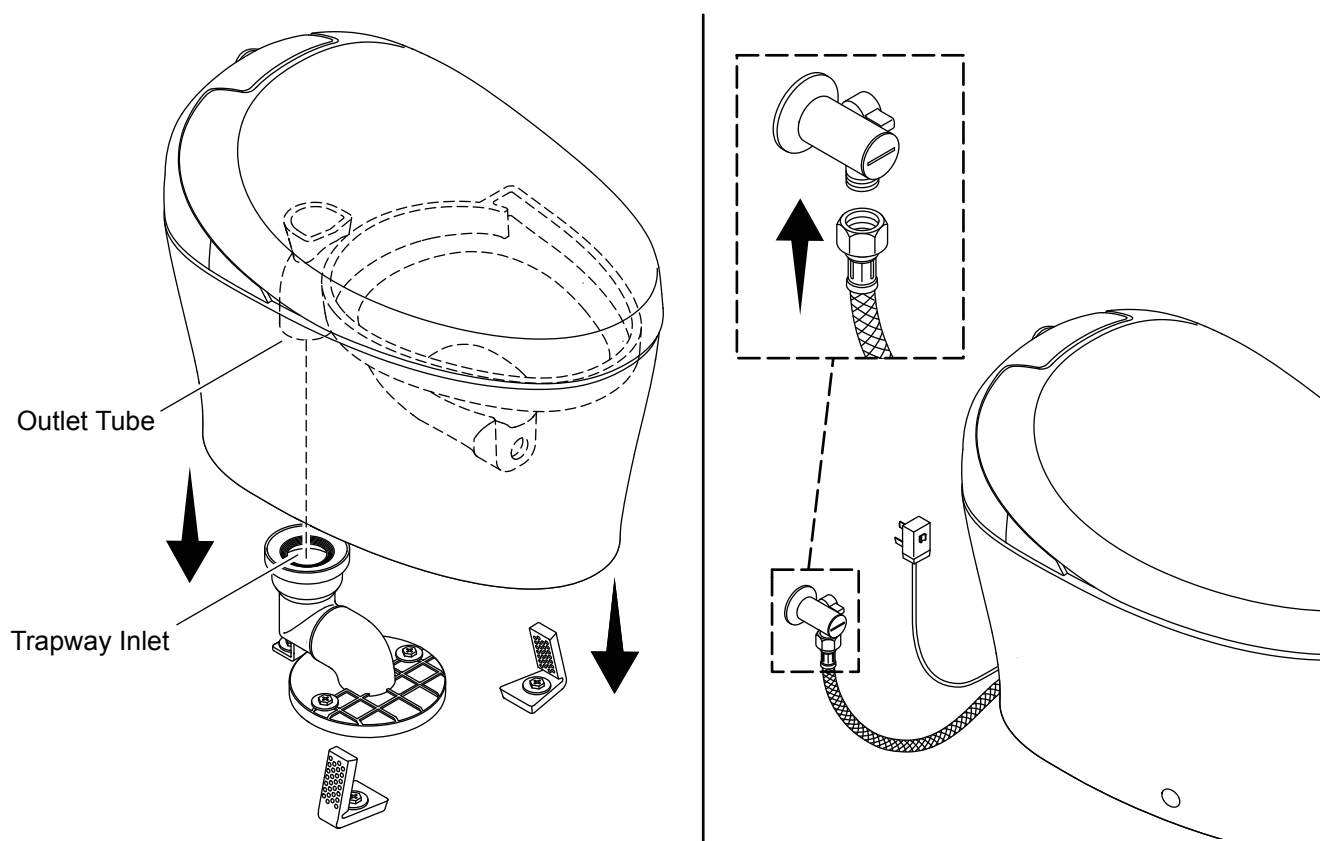

**⚠ WARNING: Risk of personal injury and product damage.** This product is heavy. The vitreous shell may chip or break if handled carelessly. Lift the toilet with two people, using proper lifting technique.

**⚠ WARNING: Risk of personal injury and product damage. DO NOT grab the product by the rim of the bidet seat to lift the toilet.**

**NOTE:** Before connecting the water supply, turn ON the G1/2 angle valve to flush any debris in the water supply hose.

- ☐ Route the water supply line and power cord out the back of the toilet for your installation.
- ☐ With assistance, lift the toilet over the trapway and align the outlet tube over the trapway inlet.
- ☐ Carefully lower the toilet onto the trapway.
- ☐ Verify that the water supply line and electrical cord are not pinched under the toilet.
- ☐ Connect the water supply hose to the G1/2 angle valve.
- ☐ Turn ON the water supply.

## 8. Secure the Toilet

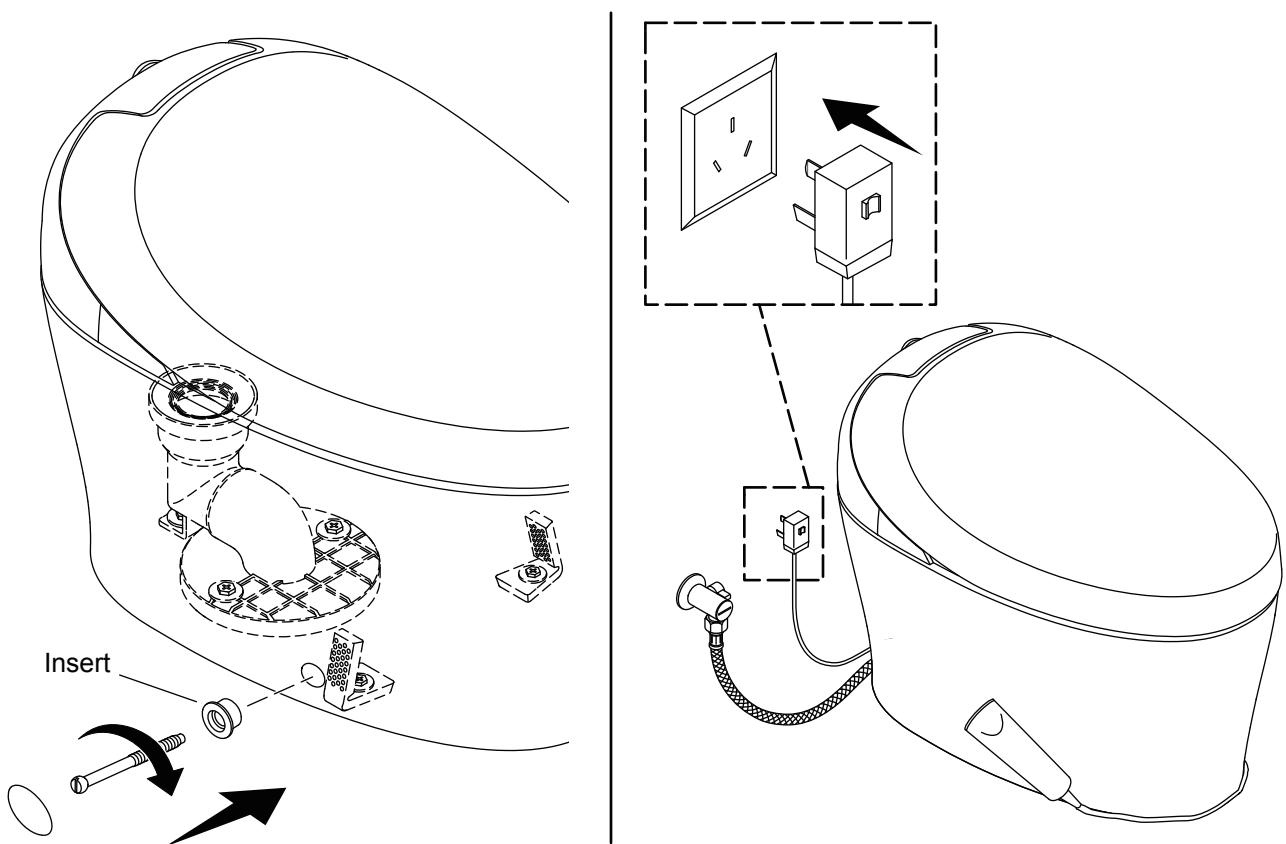

**⚠ WARNING: Risk of electric shock.** Do not use an ungrounded outlet. Connect only to a properly grounded dedicated circuit protected by a Ground Fault Circuit Interrupter (GFCI) or Residual Current Device (RCD). Use 220 VAC, 50 Hz, 10 A service.

**⚠ CAUTION: Risk of product damage.** Do not overtighten the screws. The vitreous shell may chip or break if the screws are overtightened.

**NOTE:** When electrical power is connected to the toilet, the toilet will automatically go through a start-up sequence. The sequence includes wand movement, waterline purge, and nightlight blinks. The toilet will go silent when the start-up sequence is complete.

- ☐ Place an insert into each of the holes on the side of the toilet.
- ☐ Insert a screw into each of the holes and tighten securely. **Do not overtighten!**
- ☐ Install a cap over each screw. The caps should be flush with the exterior of the toilet.
- ☐ Plug the power cord into the electrical outlet.
- ☐ Wait for the nightlight to stop blinking, indicating that the start-up procedure is complete.
- ☐ Press the flush button and let the toilet fully refill.
- ☐ Check all connections for leaks, and make adjustments as needed.
- ☐ Apply transparent silicone sealant along the seam between the outside edges of the toilet and the floor. (Note: It is recommended that the height of the sealant applied at the joint between the foot-sensing window and the floor does not exceed 5mm, so as not to affect the sensing effect.)
- ☐ Allow the silicone sealant to cure following the silicone sealant manufacturer's instructions.



## 9. Install the Filter

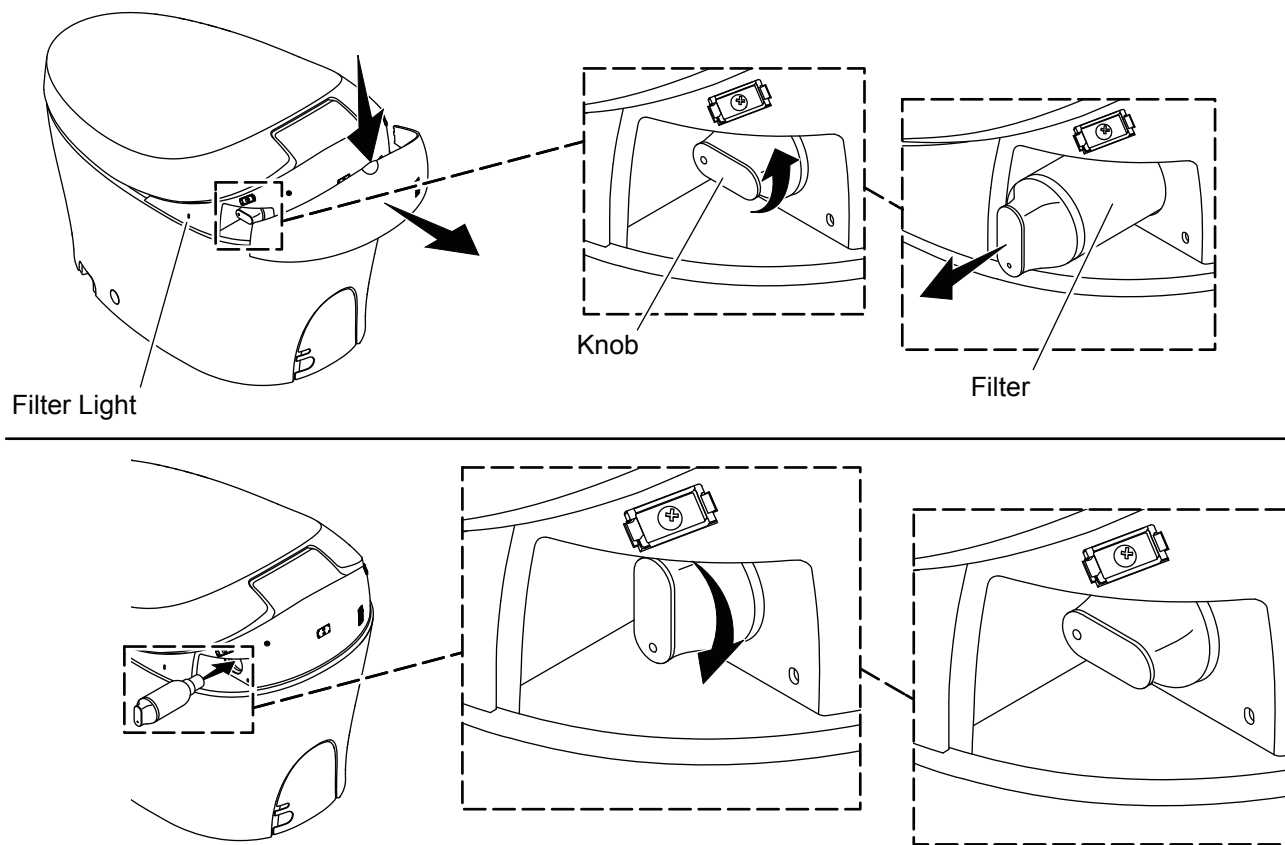

**IMPORTANT!** Before initial use, remove the filter preinstalled on the toilet and install the new provided filter.

**NOTE:** The orange filter light indicates that the filter will be expired soon. The flashing orange filter light indicates that the filter has expired and needs to be replaced.

**NOTE:** Verify that the knob is oriented as shown when installed. If the filter is not secured into place, the filter light will flash orange and white alternatively.

**NOTE:** Only replace the filter when the power is ON. The orange filter light will NOT turn off if the filter is replaced when the power is OFF. Uninstalling and reinstalling the filter when the power is restored will reset the filter light and prevent the filter light from flashing or staying on.

- ☐ Push as shown to remove the rear cover of the seat.
- ☐ Rotate the knob to remove the preinstalled filter.
- ☐ Install the provided new filter. Press gently and rotate the knob to secure the new filter in place.
- ☐ Reinstall the rear cover of the seat.

## 10. Install the Docking Station and Remote Control Batteries

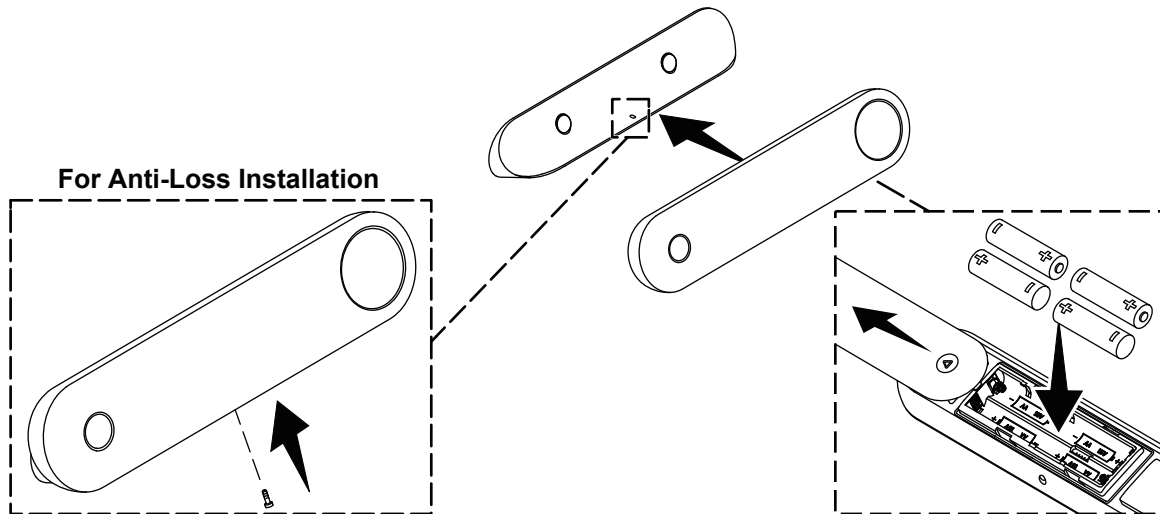
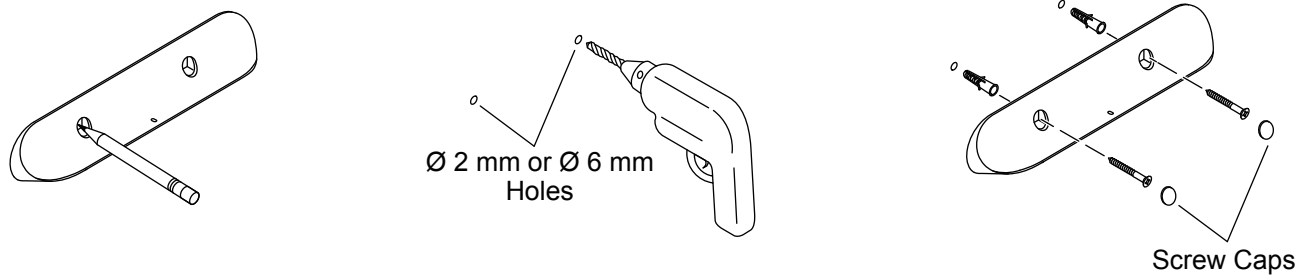

**⚠ CAUTION: Risk of product damage.** Do not place the remote control in a location that could be splashed with water. Do not immerse the remote control into liquids.

**IMPORTANT!** To avoid interference from other devices, install the remote control in a location far enough away from the electrical appliances such as hand dryer or hair dryer.

**NOTE:** The remote control docking station should be mounted in a location that is easily accessible from a seated position on the toilet.

- ☐ Position the docking station at the desired mounting location.
- ☐ Confirm that the docking station is level.
- ☐ Using a pencil, mark the two mounting-hole locations.
- ☐ **For installation into a density board or other wood surface:** Drill a 2 mm hole at each of the marked locations.
- ☐ **For installation using wall anchors:** Drill a 6 mm hole with the depth greater than 45 mm at each of the marked locations. Install the provided wall anchors into the holes.
- ☐ Position the docking station over the anchors or marks. Secure with the provided screws.
- ☐ Install the provided screw caps.
- ☐ Press down around the arrow area and slide as shown to remove the cover to the battery compartment.
- ☐ Install the four provided AA batteries in the orientation shown.
- ☐ Reinstall the cover to the battery compartment.

- ☐ Place the remote control on the docking station.
- ☐ **For anti-loss installation:** Install the provided screw to secure the remote control onto the docking station.

## 11. Installation Checkout

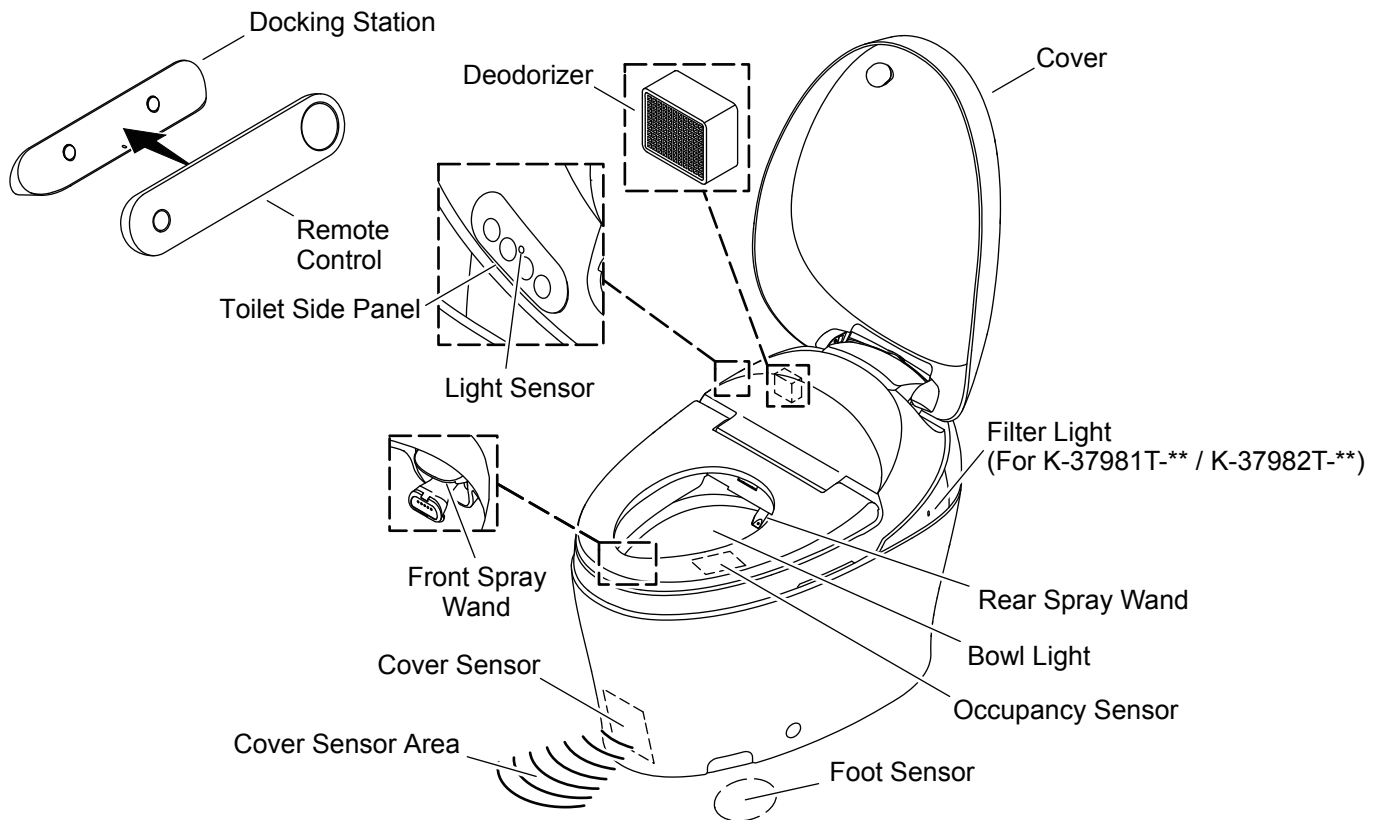

**NOTE:** When electrical power is connected to the toilet, the toilet will automatically go through a start-up sequence. The sequence includes wand movement, waterline purge, and nightlight blinks. The toilet will go silent when the start-up sequence is complete.

**NOTE:** The toilet cleansing features will not function without an occupant. To test cleansing features, the occupancy sensor area must be covered.

**NOTE:** Before testing the toilet features, remove the plastic film wrapping around the product.

**NOTE:** When testing the cleansing features, cover the seat with plastic wrap or cover the wand with your hand.

- ☐ Confirm that the water inlet valve is ON.
- ☐ Confirm that the power supply is connected.
- ☐ Confirm that the remote control batteries have been installed correctly.
- ☐ Confirm that there is no obstacle in front of the toilet.
- ☐ Confirm that the toilet has completed the start-up sequence.
- ☐ Cover the cleansing wand with your hand or span plastic wrap across the seat.
- ☐ Use your hand or a wet cloth to apply pressure to the occupancy sensor area located on the front right side of the seat.
- ☐ Use the remote control to test the toilet features.
- ☐ Refer to the Homeowners Guide packed with the product for general troubleshooting aid.

[kohler.com.cn](http://kohler.com.cn)

THE BOLD LOOK  
OF **KOHLER**®

©2025 Kohler Co.



1627832-T2

1627832-T2-C