

BEFORE YOU BEGIN

安装之前

- Please read these instructions carefully to familiarize yourself with the required tools, materials, and installation sequences. Follow the sections that pertain to your particular installation. This will help you avoid costly mistakes. In addition to proper installation, read all operating and safety instructions.
- All information in these instructions is based upon the latest product information available at the time of publication. Kohler China reserves the right to make changes in product characteristics, packaging, or availability at any time without notice.
- These instructions contain important care, cleaning, and warranty information-**please leave instructions for the consumer.**
- E SERIES LIFE cabinet adopts E0 grade wood-based panel of high quality, and with further processing, its harmful emissions will be less than 0.5mg/L.
- Turn off the water supply.
- The plumbing installation must comply with Water Supply Regulations/Bye-laws, Building Regulations or any particular regulations and practices, specified by the local water company or water undertakers. The installation should be carried out by a plumber.
- Before installation carefully inspect the new fixture for any signs of damage.
- This product complies with GB 24977-2010.
- Before installation, make sure to reserve the upper and lower water holes on the wall and floor. Refer to the image 2 below.

- 请仔细阅读本指引，以便熟悉所需工具、物料及安装程序。请遵照适用的章节来安装本产品，以免安装失当导致不必要的损失。除了有关正确的安装方法之外，还务请详阅所有操作及安全指引。
- 本指引所载之一切资料，均以印刷时所有之最新产品情况为基础，科勒中国保留权利随时更改产品特性、包装或供应情况，恕不另行通知。安装家具之前，请先确认所有必需的电气工作均已完成。
- 本指引也包含了有关保养、清洁及担保等重要资料-请交予用户保存。
- 珀玥浴室柜选用E0级优质饰面人造板精心加工而成，其有害气体释放量少于0.5mg/L。
- 关闭供水。
- 管道安装必须遵循当地所有给排水、建筑或者其他的特别规定。管道安装人员必须具备相应资格。
- 安装之前，仔细检查新产品是否有损伤。
- 本产品符合GB 24977-2010。
- 安装之前请确认安装墙面和地面预留好上下水孔。参考下图2。

ORDERING INFORMATION

This installation covers the following products in the E SERIES range:

E SERIES Vanity S 1 Drawer 800mm	K-34915T
E SERIES Vanity S 2 Drawers 800mm	K-34930T
E SERIES Vanity S 1 Drawer 900mm	K-34920T
E SERIES Vanity S 2 Drawers 900mm	K-34931T
E SERIES Vanity S 1 Drawer 1000mm	K-34928T
E SERIES Vanity S 2 Drawers 1000mm	K-34932T
E SERIES Top S UC 800mm	K-34996T
E SERIES Top S UC 900mm	K-34998T
E SERIES Top S UC 1000mm	K-35008T
E SERIES Top S UC W/2889T-ZU 800mm	K-35009T
E SERIES Top S UC W/2889T-ZU 900mm	K-35013T
E SERIES Top S UC W/2889T-ZU 1000mm	K-35015T
E SERIES Top S UC W/2215T-ZU 800mm	K-35295T
E SERIES Top S UC W/2215T-ZU 900mm	K-35297T
E SERIES Top S UC W/2215T-ZU 1000mm	K-35300T

订购信息

此安装说明书适用于以下珀玥系列家具的安装：

珀玥 浴室柜 超薄 单抽 800mm	K-34915T
珀玥 浴室柜 超薄 双抽 800mm	K-34930T
珀玥 浴室柜 超薄 单抽 900mm	K-34920T
珀玥 浴室柜 超薄 双抽 900mm	K-34931T
珀玥 浴室柜 超薄 单抽 1000mm	K-34928T
珀玥 浴室柜 超薄 双抽 1000mm	K-34932T
珀玥 台面 台下盆 800mm	K-34996T
珀玥 台面 台下盆 900mm	K-34998T
珀玥 台面 台下盆 1000mm	K-35008T
珀玥 台面 台下盆无缝拼接 2889T-ZU 800mm	K-35009T
珀玥 台面 台下盆无缝拼接 2889T-ZU 900mm	K-35013T
珀玥 台面 台下盆无缝拼接 2889T-ZU 1000mm	K-35015T
珀玥 台面 台下盆无缝拼接 2215T-ZU 800mm	K-35295T
珀玥 台面 台下盆无缝拼接 2215T-ZU 900mm	K-35297T
珀玥 台面 台下盆无缝拼接 2215T-ZU 1000mm	K-35300T

CHANGSHU KOHLER LTD., SOUTHEAST ECONOMIC DEVELOPMENT ZONE,
CHANGSHU, JIANGSU PROVINCE, CHINA POST CODE 215500
常熟科勒有限公司 江苏省常熟市东南经济开发区 邮编：215500

ROUGHING-IN

尺寸图

Reference
参考值

UNIT : mm
单位: 毫米

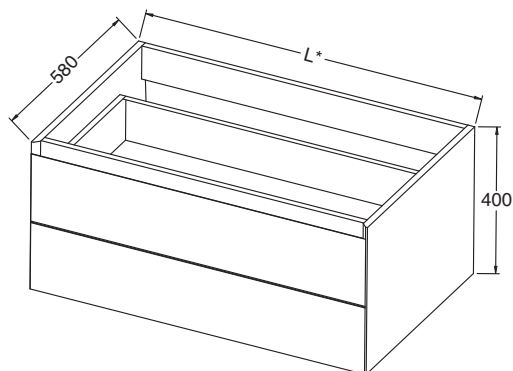

E SERIES 珀玥
K-34915T 800*580*400mm
K-34920T 900*580*400mm
K-34928T 1000*580*400mm

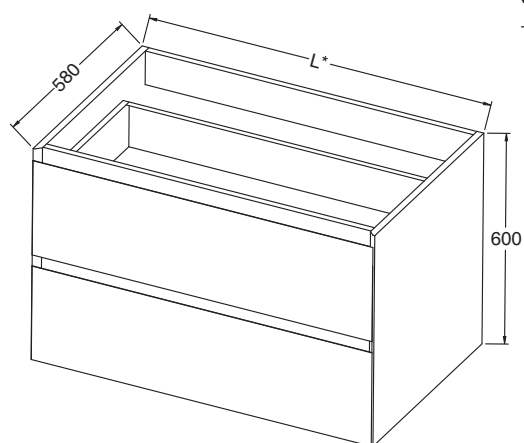

E SERIES 珀玥
K-34930T 800*580*600mm
K-34931T 900*580*600mm
K-34932T 1000*580*600mm

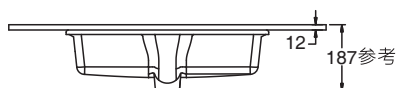
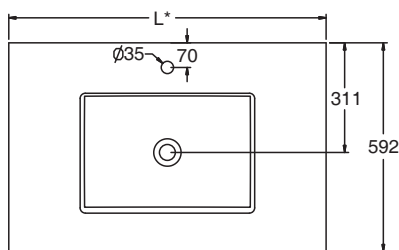

E SERIES 珀玥
K-34996T 824*592mm
K-34998T 924*592mm
K-35008T 1024*592mm
注: SKU仅台面, 台盆请另外购买。

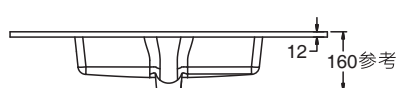
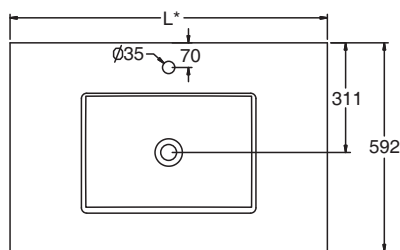

E SERIES 珀玥
K-35009T 824*592mm
K-35013T 924*592mm
K-35015T 1024*592mm
K-35295T 824*592mm
K-35297T 924*592mm
K-35300T 1024*592mm
注: SKU包含台面和台盆。

Fig.1
图1

Kohler reserves the right to change marked dimensions without prior notice.
科勒公司保留随时变更图中标示尺寸的权利, 无需另行通知。

RECOMMENDED DRAIN AND ANGLE VALVE POSITIONS

建议的排水和 角阀位置

Mark the position of hanged bracket and back panel according to dimensions as illustrated, and loosen the suspension hook of bathroom cabinet.
(The recommended counter height after installation is 800-900 mm)

根据图示尺寸在墙壁上标示出挂墙托片和背板挂螺栓的位置, 并将浴室柜吊码的挂钩伸长。

(建议安装后台面高度800-900mm)



Caution! Avoid the cables and pipes inner set when drilling in the wall.



小心! 在墙壁上钻孔时请务必小心避开内设的缆线和管道。

Note: Different types of bolts are required for different decoration boards. Please apply suitable bolts and plugs.

注意: 不同的装饰墙面需要不同型号的螺钉。请使用合适的螺钉和入墙胶塞。

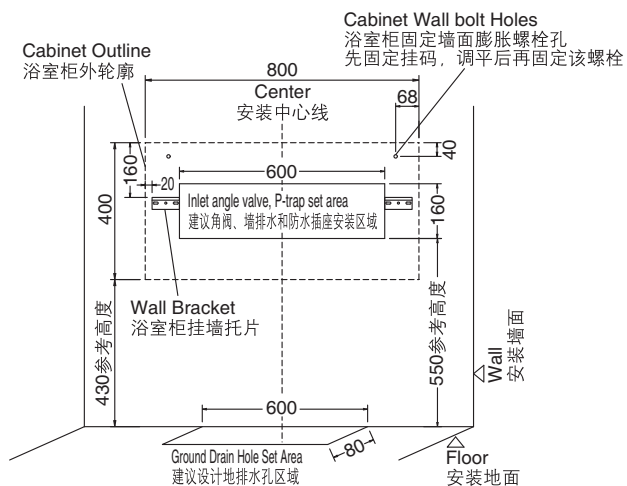

K-34915T

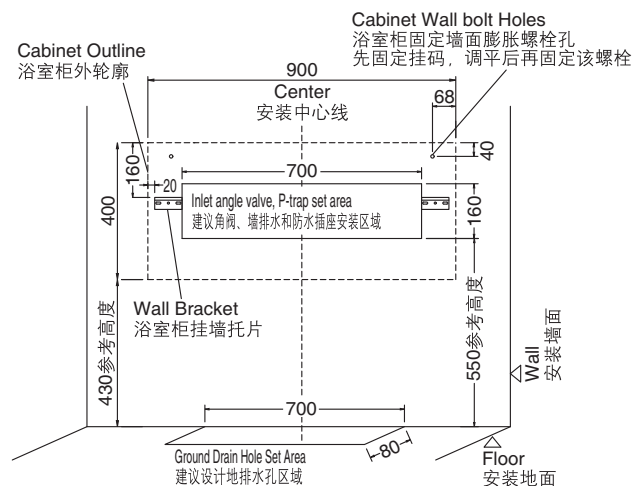

K-34920T

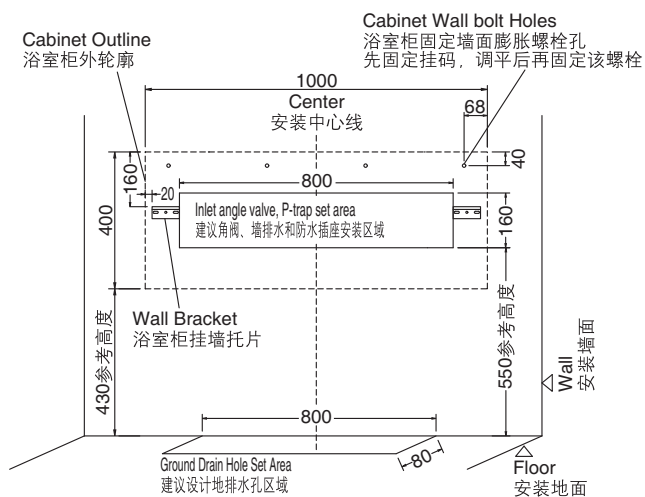

K-34928T

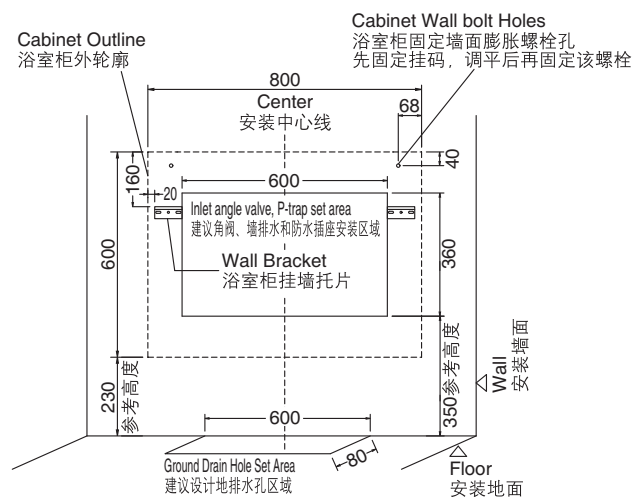

K-34930T

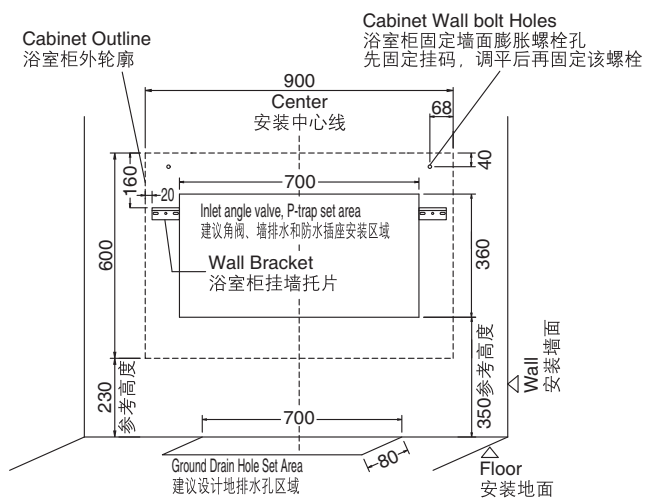

K-34931T

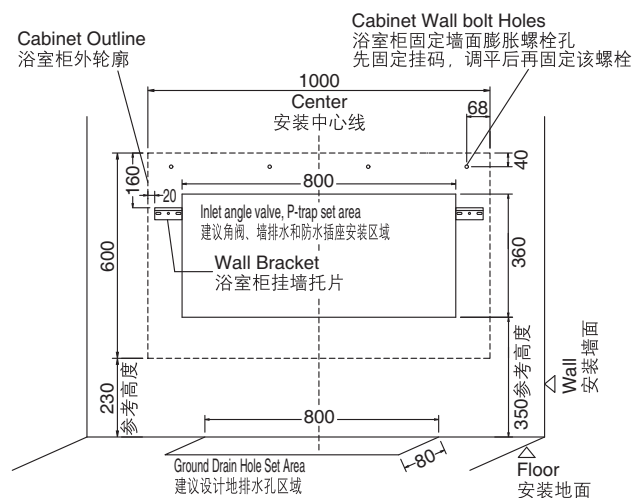

K-34932T

Fig.2
图2

INSTALLATION

安装

A. Install Washbasin Cabinet

Install the services.
Hot (H) and Cold (C) inlets must be connected to the correct inlet pipes.
Install the drain in accordance with the manufacturer's instructions.

Caution! Make sure a watertight seal exists on all washbasin drain connections.

Caution! Provide access to the plumbing connections for future plumbing maintenance.

The hot and cold water supplies must be installed with isolating valves.

Open the package, take out the bathroom cabinet, and remove the door panels and hardware packs from the case.

A. 安装脸盆柜

安装管道
热水(H)及冷水(C)入口必须连接至正确的进水管。

根据制造商说明书安装排水。

小心! 请确保所有脸盆排水的连接处都装有防水密封圈。

小心! 管道连接处需留有检修空间, 以备日后管道维护之用。

注意! 安装冷热供水管时必须使用隔离阀。

打开包装, 取出浴室柜, 再从柜体上拆下抽屉和五金安装包。

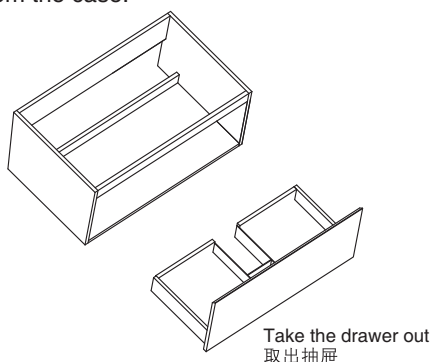

Fig.3
图3

- 1) Drill the installation hole for the wall bracket.
- 2) Fix the wall bracket on the wall with suitable plugs and bolts.

- 1) 钻好挂墙托片的安装孔。
- 2) 使用合适的入墙胶塞和螺钉, 将挂墙托片固定在墙上。

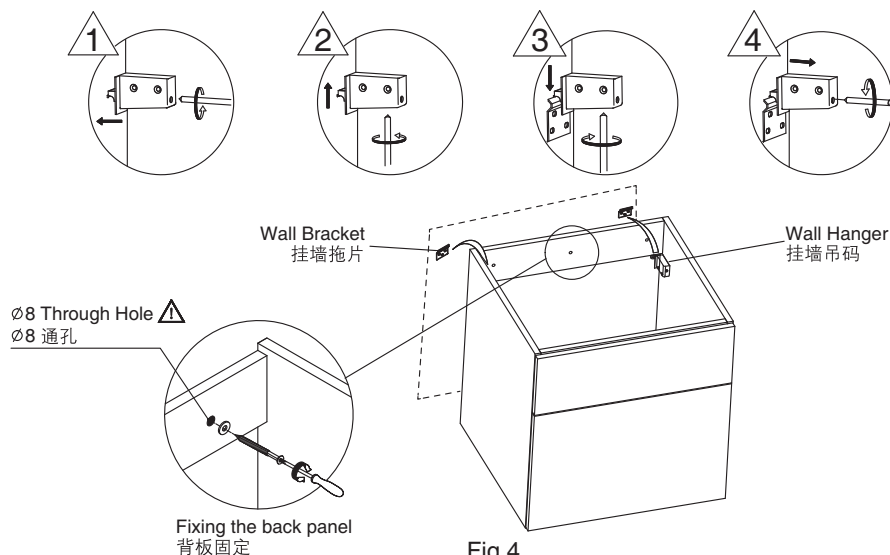

Fig.4
图4

- 3) Adjust the wall hanger on the side panel of the bathroom cabinet by following the steps shown in Fig. 4 so that the bathroom cabinet keeps level and its back panel presses closely against the wall.

- 3) 按图中 1 2 3 4 步骤调节浴室柜侧板上的挂墙吊码, 使浴室柜保持水平并使其背板紧贴墙壁。

- 4) Mark the positions of the round hole of the back panel on the wall.
- 5) Remove the bathroom cabinet and put it aside. Then drill holes into the wall at the marked positions.
- 6) Push the plugs into the wall.
- 7) Place the bathroom cabinet on the wall bracket and adjust the cabinet so that it is level. Adjust the bolts of the wall hanger so that the back panel of the bathroom cabinet presses closely against the wall.
- 8) Secure gaskets on the bolts through the back panel. Fix the bathroom cabinet firmly to the wall.

- 4) 通过背板圆孔在墙壁上相应位置做记号。
- 5) 将浴室柜取下放在一边，并在墙上记号处钻孔。
- 6) 将入墙胶塞打入墙壁。
- 7) 将浴室柜放置到挂墙托片上，将浴室柜调节到水平状态，使浴室柜背板紧贴墙壁。
- 8) 在螺钉上套上垫片穿过背板拧紧。将浴室柜牢固地固定在墙壁上。

B. Installation of L-shaped angle bracket (Optional)

- 1) When the width of a single cabinet >850mm, select L-shaped angle bracket.
- 2) Before installing the whole set of hanging cabinets, first determine the height line H to be installed on the wall.
- 3) According to the diagram between the hanging pieces and the top side of the cabinet, drill 3 holes of depth 5.5mm in the corresponding position on the wall, knock in the embedded expansion pipe, and install the L-shaped angle bracket on the wall.

B. L型角架安装说明(选装件)

- 1) 单个柜体宽度>850mm时，选装L型角架。
- 2) 整套悬挂柜安装前，先在墙面上确定好需安装的高度线H。
- 3) 根据吊码挂片与柜顶边的关系图，在墙上相应位置钻3个Φ8，深度5.5mm的孔，敲入预埋膨胀管，安装好L型角架于墙上。

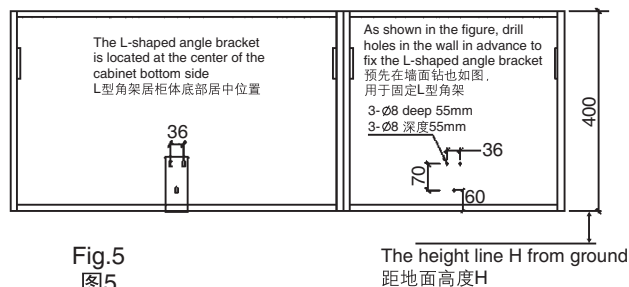
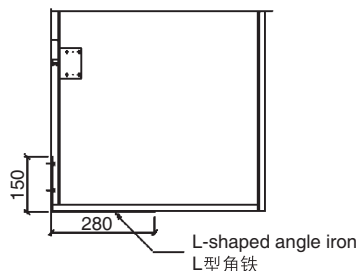

Fig.5
图5

C. Installation of under counter washbasin

Note:

- a. Install the basin by following the instructions. The following steps are for reference only.
- b. The outlet of the faucet should be more than 125mm away from the center of the installation hole.
- c. Do not fully tighten the bolts before adjusting the washbasin to the center of the installation hole.

C. 台下盆安装

注意:

- a. 请按照台盆安装指导，以下步骤仅供参考。
- b. 台下盆所选用的龙头出水嘴至龙头开孔中心距离应大于125mm。
- c. 请在固定脸盆时不要一次就完全拧紧螺栓，把脸盆位置调整到开孔中心位置后再完全拧紧螺栓。

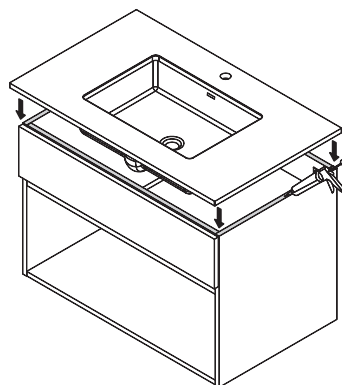
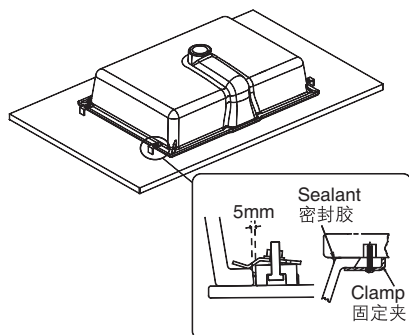

Fig.6
图6

- 1) Fix the washbasin at the preset position under the counter with bolts.
- 2) Continuously and evenly apply sealant onto the washbasin edge in contact with the counter.

- 1) 将脸盆用螺栓固定在台面下预置的位置。
- 2) 在与台面接触的脸盆边缘上，连续均匀地涂上密封胶。

D. Connection of supply and drainage pipes

Install the supply and drainage pipes. Open the cabinet door (remove the drawers, if any) and allow licensed plumbers to connect the supply and drainage pipes from inside the cabinet. The hot water and cold water inlets must be correctly connected with the supply pipes. We recommend installing the drainage pipe inside the wall.

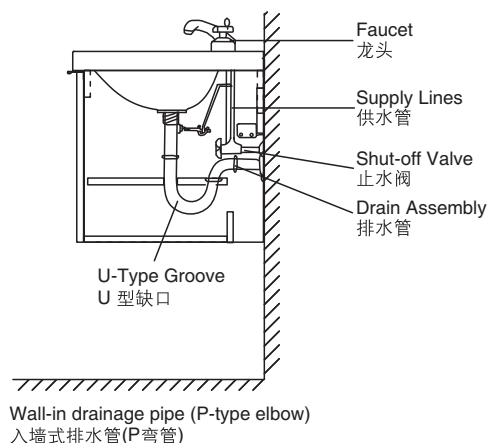

D. 连接进排水管

安装上下水，打开柜门(有抽屉的请取下)从柜体里由专业的水电工连接上下水管，热水及冷水入口必须连接至正确的进水管。我们建议采用墙排水方式。

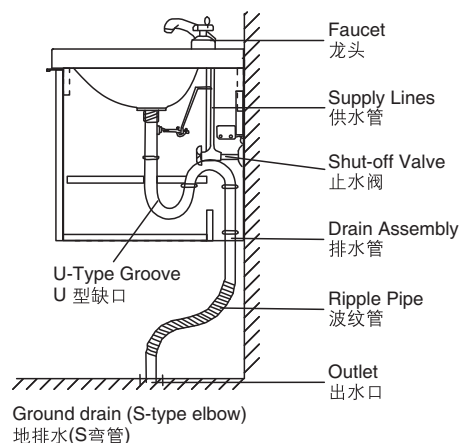
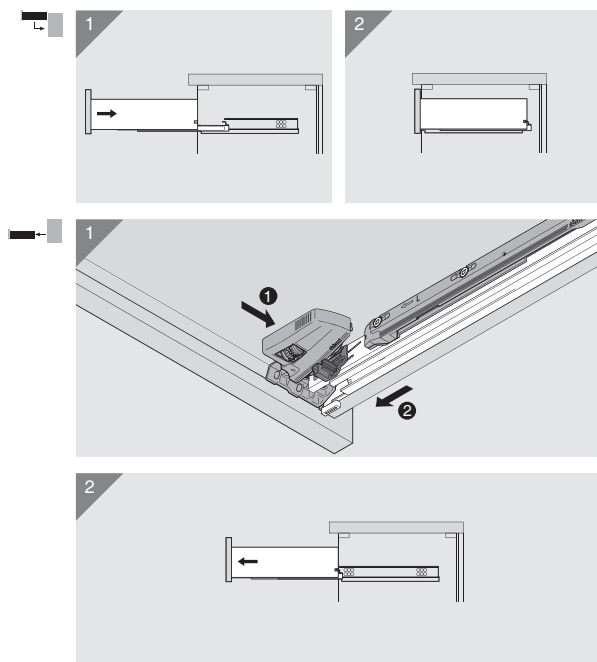

Fig.7
图7

DISASSEMBLY AND REGULATION

- Installation, disassembly and adjustment of drawers.



Installation and Disassembly
安装和拆卸

拆卸和调节

- 抽屉的安装拆卸和调节。

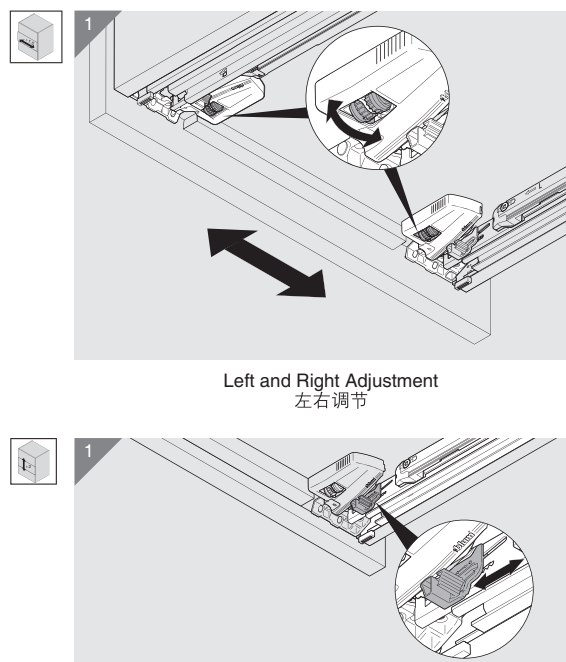

High and Low Adjustment
高低调节

Fig.8
图8

USER MAINTENANCE

日常维护



Warning! Risk of product damage.

1. Many cleansers contain abrasive and chemical substance which is not suitable for cleaning stainless steel, enamel, plating or plastic products. You may use mild cleansers or soaps to clean the surfaces. Wipe any splashes of cleaner solutions from the surface with clean soft cloth.
2. Maintain ventilation in the bathroom, and separate the dry area from the damp one if conditions permit. Try to open the door and windows of the bathroom and maintain good ventilation.
3. Kohler bathroom cabinet are dealt with strict procedures for damp-proof, whose good damp-proof function ensures good performance even in bathroom of huge humidity. Yet do not splash and pour water directly on the bathroom cabinet. Make sure that the bathroom is not over damp and wipe any splashes from surfaces immediately.
4. Maintenance of door board: Clean and wipe door board regularly, and wipe the condensation vapor with dry and soft cloth.
5. Ensure that electrical connections for appliances such as head lamp is insulated wipe mirror surface with chamois regularly to guarantee the persistent excellent performance.
6. Please do not sit, lean or step on the basin cabinet.
7. If any fixtures caused by abnormal reasons, Kohler China can supply paid replacement for service parts caused by abnormal reasons as shown in the Service Parts Page in the limited duration of warranty.



警告！小心产品受损。

1. 许多清洁剂都含有研磨剂及化学物质，不可用于清洁不锈钢、搪瓷、镀层或塑料制品。这些表面须使用温和的清洁剂或皂液进行清洁，将残余洗涤剂洗干净，然后用干净的软布擦干。
2. 卫生间请保持良好的通风状态，有条件的可以干、湿分离，平常尽量保持浴室空气畅通，养成开窗开门的习惯。
3. 科勒浴柜都经过严格的防潮处理，但防潮并不是防水，使用时不可随意任浴柜被水浇、溅。良好的防潮性能可以保证在高相对湿度时仍有良好使用性，所以请避免卫生间过于潮湿，遇有水迹要及时擦干。
4. 门板的保养：经常用软布定期清洁、擦拭，洗浴后的冷凝水蒸气应用干布擦净，保持门板的干爽。
5. 照明灯等电器连接要确保绝缘、防潮镜面最好用麂皮经常擦拭，可以保障使用质量经久如一。
6. 日常使用时，请勿坐、倚、靠、踩踏在脸盆柜上。
7. 科勒公司确保在担保期内，可以提供因非正常原因造成的如维修零件图中零件的有偿更换。