

BEFORE YOU BEGIN

- Please read these instructions carefully to familiarize yourself with the required tools, materials, and installation sequences. Follow the sections that pertain to your particular installation. This will help you avoid costly mistakes. In addition to proper installation, read all operating and safety instructions.
- All information in these instructions is based upon the latest product information available at the time of publication. Kohler China reserves the right to make changes in product characteristics, packaging, or availability at any time without notice.
- These instructions contain important care, cleaning, and warranty information-**please leave instructions for the consumer.**
- Kohler quartz top is mainly made from good quality natural quartz sand mixed with other auxiliary materials. It uses high-molecular polymer as adhesive and is manufactured with special process.
- Turn off the water supply.
- The plumbing installation must comply with Water Supply Regulations/Bye-laws, Building Regulations or any particular regulations and practices, specified by the local water company or water undertakers. The installation should be carried out by a plumber.
- Kohler cabinets use agglomerated quartz top. The radioactivity is lower than national standard of class A interior decoration material ($I_{Ra} \leq 1.0$, $I_r \leq 1.3$).
- Before installation carefully inspect the new fixture for any signs of damage.

安装之前

- 请仔细阅读本指引，以便熟悉所需工具、物料及安装程序。请遵照适用的章节来安装本产品，以免安装失当导致不必要的损失。除了有关正确的安装方法之外，还务请详细阅读所有操作及安全指引。
- 本指引所载之一切资料，均以印刷时所有之最新产品情况为基础，科勒中国保留权利随时更改产品特性、包装或供应情况，恕不另行通知。
- 本指引也包含了有关保养、清洁及担保等重要资料-请交予用户保存。
- 科勒石英石台面是以优质天然石英砂为主要原料再加其他辅料按一定比例混合，用高分子聚合物为粘合剂，经特定的工艺加工而成的人造石饰面板材。
- 关闭供水。
- 管道安装必须遵循当地所有给排水、建筑或者其他的特别规定。管道安装人员必须具备相应资格。
- 科勒浴室家具配套人造石英石台面，其放射性均低于国标A类装修材料标准($I_{Ra} \leq 1.0$, $I_r \leq 1.3$)。
- 安装之前，仔细检查新产品是否有损伤。

SAFETY WARNINGS

Kohler products are precision-engineered and should give continued superior and safe performance, provided:

1. They are installed, commissioned, operated and maintained in accordance with the recommendations given in this Manual.
2. Periodic attention is given, as necessary, to maintain the product in good functional order. Recommended guidelines are given in the **MAINTENANCE** section.

Carefully inspect the new fixture for any signs of damage.

When installing Kohler products, manufacturer's guide lines for power tool safety must be followed.

安全警告

科勒产品经过精确制造，性能卓越，经久耐用。为保证产品品质，您必须：

- 1.按照此手册中推荐的方法进行安装、起动、操作及维护。
- 2.如有需要，定期检查，令产品保持良好性能状态。日常维护章节中列有推荐方法。

仔细检查新产品是否有损伤。

在安装科勒产品时，必须遵循制造商相关电动工具的安全的指令。

TOOLS AND MATERIALS (NOT SUPPLIED) 所需工具及物料(不随货供应)

- Silicone Sealant
- Silicone Sealant Gun
- Rag

- 硅胶
- 硅胶枪
- 抹布

INSTALLATION

安装

NOTE: Please lift and place the agglomerated quartz top carefully and avoid it rubbing with hard articles.

注意：安装石英石台面轻拿轻放，受力均匀，避免与坚硬物品摩擦。

Please lift the stone top upright.

务必竖直搬运，切勿平抬。

1. Please make sure that the cabinet has been pre-installed.
2. Install the VC lavatory
 - a) For countertop lavatory, please first fix the agglomerated quartz top. Refer to installation instructions of the countertop lavatory for detailed information.
 - b) For undercounter lavatory, please install it before fixing the agglomerated quartz top. Refer to installation instructions of the undercounter lavatory for detailed information. Then install them both onto the cabinet.
3. Apply silicone sealant of good quality around the area where the cabinet contact the stone top.
4. Lift the agglomerated quartz top upright by at least three people. To place the agglomerated quartz top onto the cabinet, please first lean the front end of the agglomerated quartz top against the cabinet, and then slowly lay down the rear end of the agglomerated quartz top (as shown in the picture).

1. 安装之前请确认柜子已经安装到位并完成。
2. 安装陶瓷台盆
 - a) 台上盆请在安装好石英石台面后再安装，具体安装方法请参考台上盆的安装说明书。
 - b) 台下盆请在安装好石英石台面前安装，具体安装方法请参考台下盆的安装说明书。最后将两者一起安装在柜子上。
3. 在柜体与台面接触面如珠串般滴上优质硅胶。
4. 由3人以上竖直抬起台面，先将台面前端倚靠着柜子，再慢慢放下后端部分(图示)，使之整体置于柜子上。

NOTE: The center of the stone top must be supported by a third person and laid down slowly.

注意：在放下过程中，台面中间部位需要有人支撑住慢慢下。

The cabinet shown in the picture is for reference only and may differ from actual products.
图示柜子仅为示意，请以实际产品为准。

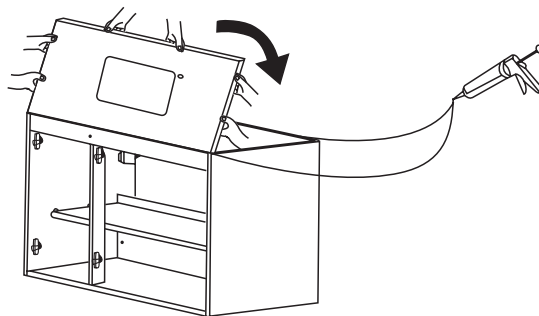

5. Wipe away the excessive silicone sealant with the rag.

5. 用抹布擦掉柜子边缘溢出的硅胶。

DAILY MAINTENANCE

日常维护

- a) In order to ensure integrity of the stone structure and prevent cracking, please do not stand on the stone top.
- b) Avoid metal articles hitting the stone top to prevent the surface from being scratched.
- c) Wipe the stone top with soft and dry rag to keep it clean.
- d) Avoid common chemical substances touching the stone top to prevent it from being stained.
- e) If there is any chemical substances on the stone top (such as lipsticks or toning lotion), please instantly wipe it with wet rag.

- a) 禁止站在石材台面上，以保证台面结构的整体性，防止裂开。
- b) 避免金属品砸到台面，以免刮伤石材表面。
- c) 使用材质较软的干抹布擦拭台面，以保持台面的日常整洁。
- d) 避免日常使用的化学物质接触台面，以免污染台面。
- e) 发现台面上粘有含化学成份的物质（如口红/化妆水等），立即可用蘸上水的湿抹布来擦拭。