

## BEFORE YOU BEGIN

- Please read these instructions carefully to familiarize yourself with the required tools, materials, and installation sequences. Follow the sections that pertain to your particular installation. This will help you avoid costly mistakes. In addition to proper installation, read all operating and safety instructions.
- All information in these instructions is based upon the latest product information available at the time of publication. Kohler China reserves the right to make changes in product characteristics, packaging, or availability at any time without notice.
- Ensure all electric work has completed before furniture installation.
- Make sure the finished wall is straight and plumb, and the floor is flat and perpendicular to the finished wall.
- Remove any moldings that may inhibit the vanity from being flush against the finished wall.
- It is recommended that the drawer, door(s), and shelf be removed from the cabinet before beginning the cabinet installation. Doing so will ease the installation process. Refer to the sections contained in this guide for proper removal.
- PROVINTY cabinet mainly adopts platane wood, poplar wood and high quality E1 grade MDF. Its harmful gas emission is less than 1.5mg/L.
- Turn off the water supply.
- The plumbing installation must comply with Water Supply Regulations/Bye-laws, Building Regulations or any particular regulations and practices, specified by the local water company or water undertakers. The installation should be carried out by a plumber.
- Before installation carefully inspect the new fixture for any signs of damage.

## 安装之前

- 请仔细阅读本指引，以便熟悉所需工具、物料及安装程序。请遵照适用的章节来安装本产品，以免安装失当导致不必要的损失。除了有关正确的安装方法之外，还务请详阅所有操作及安全指引。
- 本指引所载之一切资料，均以印刷时所有之最新产品情况为基础，科勒中国保留权利随时更改产品特性、包装或供应情况，恕不另行通知。
- 安装家具之前，请先确认所有必需的电气工作均已完成。
- 确保安装墙面是垂直平面，地板平坦且与墙面垂直。
- 清除所有障碍物，使柜体与紧靠墙面平齐。
- 强烈建议在柜体安装前拆下抽屉、门和搁板，使安装过程较为安全，拆除步骤参考后续指导。
- 帕蒂系列浴室脸盆柜主要选用梧桐木和白杨实木以及优质E1级密度板等精心加工而成，其有害气体排放量小于1.5mg/L。
- 关闭供水。
- 管道安装必须遵循当地所有给排水、建筑或者其他的特别规定。管道安装人员必须具备相应资格。
- 安装之前，仔细检查新产品是否有损伤。

## ORDERING INFORMATION

This installation covers the following products in the PROVINTY range:  
Basin Cabinet.....K-2559T

## 订购信息

此安装说明书适用于以下帕蒂系列家具的安装：  
脸盆柜.....K-2559T

## SAFETY: WARNINGS

Kohler products are precision-engineered and should give continued superior and safe performance, provided:

1. They are installed, commissioned, operated and maintained in accordance with the recommendations given in this Manual.
2. Periodic attention is given, as necessary, to maintain the product in good functional order. Recommended guidelines are given in the **MAINTENANCE** section.

Carefully inspect the new fixture for any signs of damage.

When installing Kohler Products, manufacturers guidelines for power tool safety should be followed.

## 安全：警告

科勒产品经过精确制造，性能卓越，经久耐用。为保证产品品质，您必须：

1. 按照此手册中推荐的方法进行安装、启动、操作及维护。
2. 如有需要，定期检查，令产品保持良好性能状态。日常维护章节中列有推荐方法。

仔细检查新产品是否有损伤。

在安装科勒产品时，必须遵循制造商相关电动工具的安全的指令。

科勒(中国)投资有限公司  
上海市闸北区江场三路158号 邮编：200436

## TOOLS AND MATERIALS

- Pencil
- Measuring Tape
- Level
- Safety Glasses
- Drill
- Screwdrivers
- Hole Saw

## 工具及材料

- 铅笔
- 卷尺
- 水平尺
- 安全眼镜
- 手枪钻
- 螺丝刀
- 孔锯

## ROUGHING-IN

## 尺寸图

Reference Value  
参考值

UNIT : mm  
单位: 毫米

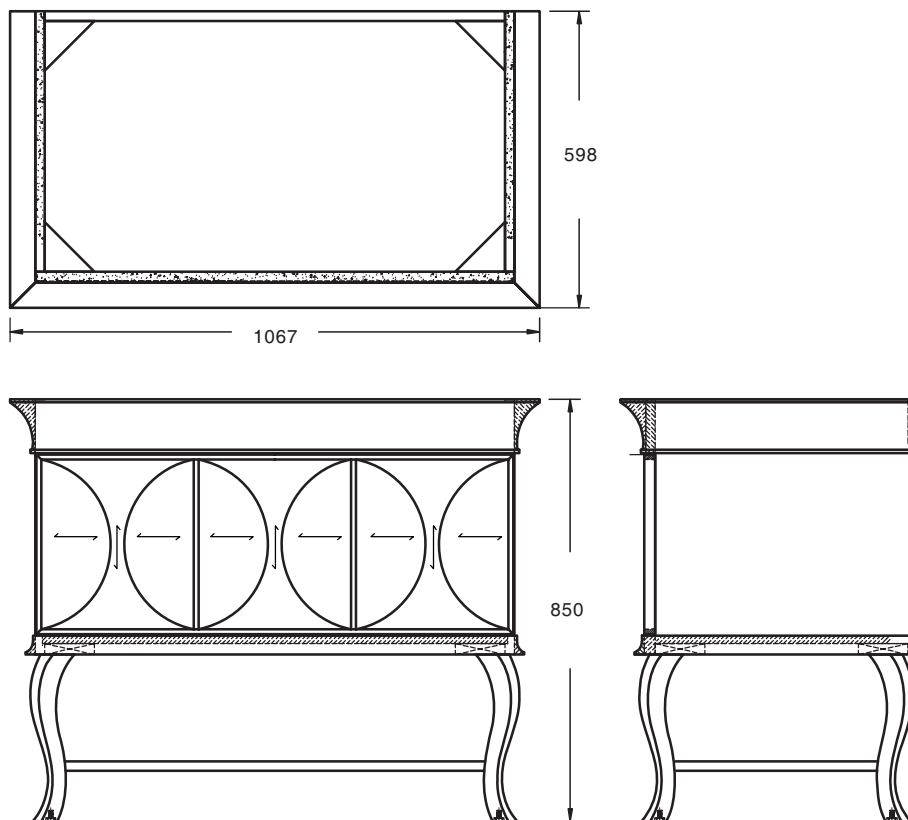

科勒公司保留随时变更图中标示尺寸的权利，无需另行通知。  
Kohler reserves the right to change marked dimensions without prior notice.

## INSTALLATION

## 安装

### 1. Install Supplies

Install the services.

Hot (H) and Cold (C) inlets must be connected to the correct inlet pipes.

Install the drain in accordance with the manufacturer's instructions.

We suggest using P-trap drain. Connect P-trap pipe with washbasin drain.



**Caution!** Make sure a watertight seal exists on all washbasin drain connections.



**Caution!** Provide access to the plumbing connections for future plumbing maintenance.

**Note:** The hot and cold water supplies must be installed with isolating valves.

### 1. 安装进水管

安装管道

热水(H)及冷水(C)入口必须连接至正确的进水管。

根据制造商说明书安装排水。

我们建议采用墙排水方式，使用P弯管连接脸盆去水。



**小心！** 请确保所有脸盆排水的连接处都装有防水密封圈。



**小心！** 管道连接处需留有检修空间，以备日后管道维护之用。

**注意！** 安装冷热进水管时必须使用隔离阀。

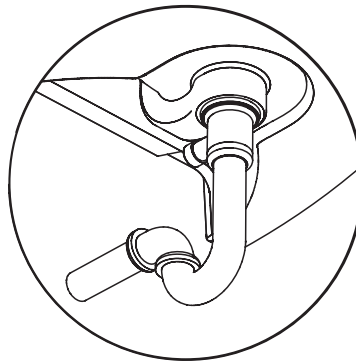

### 2. Wall Preparation

- Install the water supply and drain lines according to the roughing-in information provided with your lavatory. The water supply nipples must extend at least 76mm beyond the finished wall material.
- Complete the finished wall. Make sure the finished wall is straight and plumb, and the floor is flat and perpendicular to the finished wall.

**IMPORTANT!** Do not install any moldings that may inhibit the vanity from being plumb against the finished wall.

### 2. 墙面准备

- 根据脸盆的尺寸图信息安装进水管和排水管。水管接头必须至少超出墙面76mm。
- 确保完工墙面水平和垂直方向的平直。确保与墙面垂直的地面水平。

**重要！** 清除墙面与柜体之间的所有障碍物，使柜体与紧靠墙面平齐。

### 3. Install the Legs

**IMPORTANT!** Be sure the drawer has been removed before turning the vanity over. Refer to the "Remove/Adjust the Drawer" section of this guide.

- Turn the vanity over so the bottom faces up.

**NOTE:** The legs must be installed opposite one another. Begin with the back left corner, then to the front right corner for installation.

- Insert a hex screw with a washer through the hole in back left leg, then through the pre-drilled outer hole on the back left corner.
- Tighten the hex screw until there is no movement of the leg.
- Install the front right leg to the front right corner in the same manner.
- Insert the shelf into the groove of each installed leg.
- Install the two remaining legs in the same manner. Ensure the shelf is positioned into the groove of each leg before securing the hex screws.
- Secure an L-bracket at each leg location, as illustrated, using the screws provided.
- Turn the vanity over onto its legs.

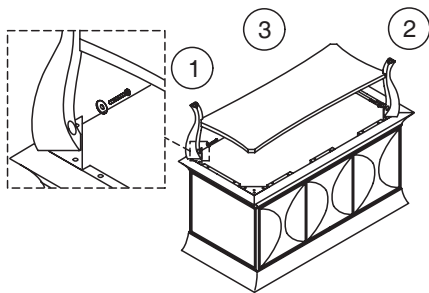

### 3. 安装柜体支撑脚

**重要！** 请确保翻转柜体之前抽屉已经移除。请参考本说明书中的“拆卸/调节抽屉”章节。

- 将柜体翻转，确保地面朝上。

**注意：** 支撑脚安装时必须遵循对角原则。首先安装左后方的支撑脚，然后安装右前方的支撑脚。

- 将一个六角螺丝套上垫圈插入左后方的支撑脚孔中，然后将其插入柜体左后角预先钻好的安装孔中。
- 紧固六角螺丝，直到支撑脚不再移动。
- 用同样的方式将右前方的支撑脚安装至柜体的右前角。
- 将搁板插入已安装支撑脚的凹槽中。
- 按上述步骤安装剩余的两个支撑脚。确保在紧固六角螺丝之前搁板已经放入支撑脚的凹槽中。
- 如图所示，在每个支撑脚的位置使用随附的螺丝固定一个L型支架。
- 将柜体翻转，以支撑脚支撑。

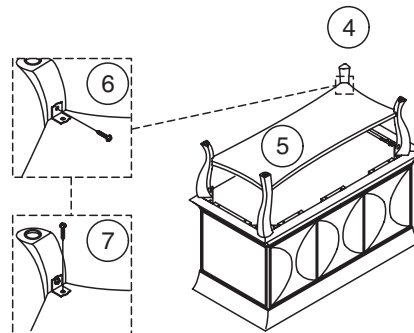

## 4. Install the Vanity

- Position the cabinet against the finished wall.
- Verify the cabinet is level. If necessary, turn the levelers on the bottom of the cabinet to achieve level.
- Mark the supply and drain locations on the inside of the cabinet back wall. Move the cabinet away from the wall.
- Cut the marked supply and drain locations from inside of the cabinet using a hole saw.
- Position the cabinet against the wall, aligning the supply and drain locations with the cut holes on the cabinet back wall.

**NOTE:** The cabinet could be installed in Floor drainage or Inwall drainage.

**NOTE:** If possible and applicable, install the faucet to the lavatory before installing the lavatory to the vanity.

- Install the lavatory at this time. Refer to the lavatory manufacturer's instructions for proper installation.
- Reinstall the drawer and doors.
- Make adjustments to the door(s), hinges, and drawer as needed. Refer to the sections to follow for proper

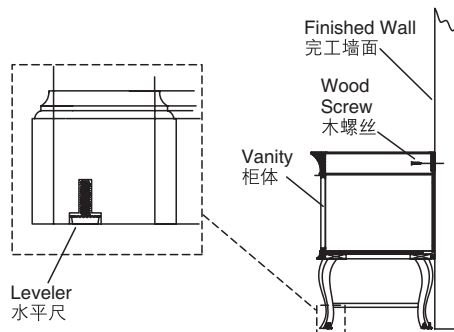

## 5. Install Counter Top

**Attention:** Handle with care when install the countertop. Avoid scrubbing with hard objects.

## 4. 安装柜体

- 把柜子安置在墙边。
- 检查柜子是否水平。如果需要，把调整脚调到底来达到水平。
- 在柜子背板上相应标出进排水管的位子，把柜子从墙边移开。
- 用孔锯在背板上切除相应部分。
- 重新放置回柜子在墙边，对齐孔与进排水管的位位置。

注意：浴室柜可安装成墙排水或地排水。

注意：如果可能，将脸盆安装至柜体前请先将龙头安装至脸盆。

- 此时安装脸盆。请参考脸盆说明书进行安装。
- 重新安装抽屉及柜门。
- 如有需要，对柜门、铰链和抽屉进行调整。请参考之后的章节进行调整。

## 5. 安装台面

注意：安装台面轻拿轻放，避免与坚硬物品摩擦。

## Undercounter Lavatory

1. Position the cabinet board with pre-opened washbasin hole upside down on the soft underlay.



**Caution!** Do not lay hard or extrusive articles on the placement of cabinet board, lest scratches on the cabinet board.

2. Fix the washbasin to the pre-set position under the cabinet board with bolts.

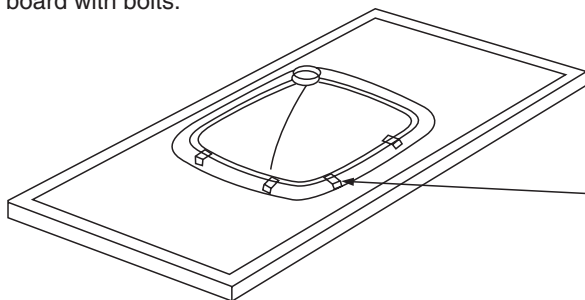

**Note:** The faucet used on undercounter lavatory should ensure the distance between the spout and the center of faucet hole more than 125mm.

**Note:** Do not tighten the bolts completely at the first time. Adjust the washbasin position to the center of the pre-opened hole and tighten the bolts completely.

3. Apply some sealant equably as bead to the washbasin edge tangent to cabinet board.

## 台下盆台面

1. 将开好脸盆孔的台面正面朝下倒置在软垫上。



**小心！** 在台面的放置平台上不要垫置坚硬或有突出的物品，以免将台面划伤。

2. 将脸盆用螺栓固定在台面下预置的位置。

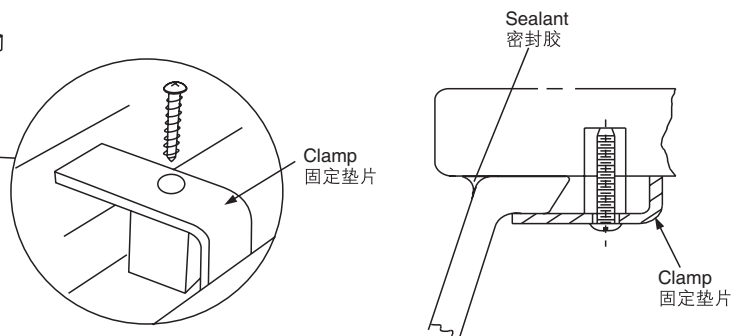

**注意：** 台下盆所选用的龙头出水嘴至龙头开孔中心距离应大于125mm。

**注意：** 请在固定脸盆时不要一次就完全拧紧螺栓，把脸盆位置调整到开孔中心位置后再完全拧紧螺栓。

3. 在与台面接触的脸盆边缘上，连续均匀地涂上密封胶。

## Fixed Cabinet Board

1. Use plastic connector to connect the countertop and cabinet as shown in the illustration.

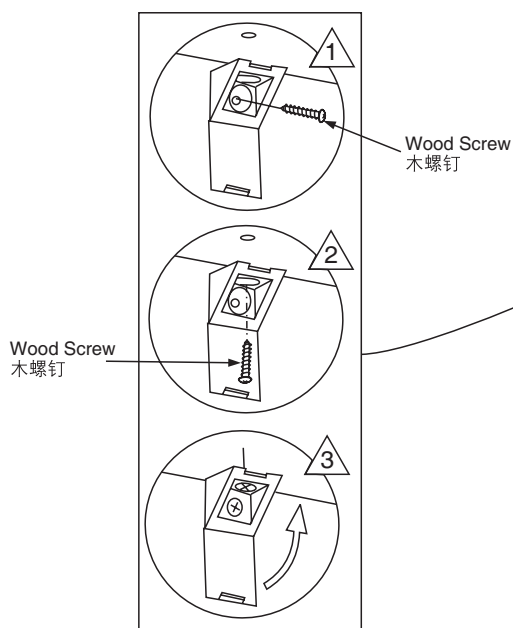

## 固定台面

1. 使用柜角连接器按图示将台面和柜体连接在一起。

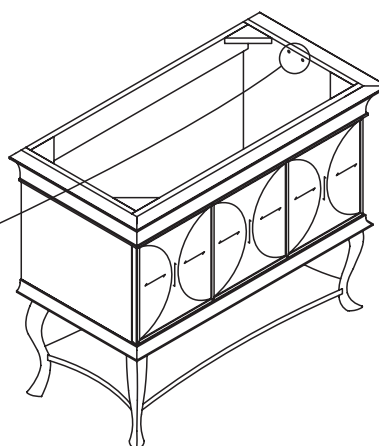

## 6. Remove/Adjust the Drawer

**NOTE:** A drawer height adjustment wheel and release latch are located underneath the front of the drawer at each corner.

### Removal

- Slide the drawer out on the rails until fully extended.
- Pull both release latches toward you, then pull the front of the drawer up off of the rails.
- Lift the drawer out from the cabinet.
- Set the drawer aside.

### Reinstallation

- Fully extend the rails.
- Align the grooves on the underside of the drawer with the rails and set into place.
- Hold the drawer in place on the rails with one hand. With your other hand, pull the tab on the bottom front of the rail toward you until you hear the rail "snap" into place. Repeat this step for the remaining rail.
- Ensure the drawer is locked into place by lightly lifting the front of the drawer upward. If the drawer does not lift up, it is engaged. If the drawer lifts up, repeat the above procedure.
- Slide the drawer in and out of the cabinet to ensure smooth operation.

### Adjustment

- Slide the drawer out on the rails until fully extended.
- Turn the drawer height adjustment wheels to adjust the drawer height. To lower the drawer, turn the wheel on the left side of the drawer clockwise and/or the wheel on the right side of the drawer counterclockwise. Turn the wheel(s) in the opposite direction to raise the drawer.

## 6. 拆除/调整抽屉

注意：抽屉的高度调整轮和松销把手位于抽屉底面的前角。

### 拆除：

- 完全拉出抽屉。
- 向自己方向拉松销把手，然后往前拉出抽屉。
- 举起抽屉。
- 把抽屉放置一边。

### 重新安装

- 完全拉出抽屉滑轨。
- 对准抽屉后板的孔位于滑轨上的钩片。
- 一只手抓住抽屉，用另一只手拉滑轨的前凸缘直至听到“咔嚓”一声，重复此步骤安装另一滑轨。
- 确保抽屉被紧紧锁住。如果抽屉不能被向上提起，说明可工作。如果能被向上提起，则重复上步直至完全锁住。
- 推动抽屉使其向内外移动平滑。

### 调整：

- 将抽屉沿滑轨拉出直至完全伸展。
- 调节抽屉高度调节滑轮以调节抽屉的高度，在抽屉的左边，将滑轮以顺时针方向，以及(或者)在抽屉的右边将滑轮以逆时针方向拨动，则抽屉下降，将滑轮向反方向拨动，则抽屉上升。

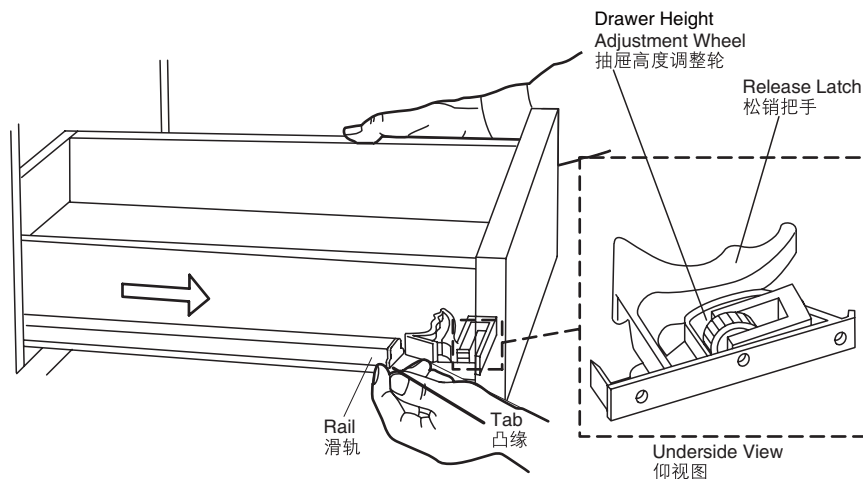

## USER MAINTENANCE

## 日常维护



### **WARNING! Risk of product damage.**

1. Many cleansers contain abrasive and chemical substance which is not suitable for cleaning stainless steel, enamel, plating or plastic products. You may use mild cleansers or soaps to clean the surfaces. Wipe any splashes of cleaner solutions from the surface with clean soft cloth.
2. Maintain ventilation in the bathroom, and separate the dry area from the damp one if conditions permit. Try to open the door and windows of the bathroom and maintain good ventilation.
3. Kohler bathroom cabinet are dealt with strict procedures for damp-proof, whose good damp-proof function ensures good performance even in bathroom of huge humidity. Yet do not splash and pour water directly on the bathroom cabinet. Make sure that the bathroom is not over damp and wipe any splashes from surfaces immediately.
4. Maintenance of door board: Clean and wipe door board regularly, and wipe the condensation vapor with dry and soft cloth.
5. Ensure that electrical connections for appliances such as head lamp is insulated; wipe mirror surface with chamois regularly to guarantee the persistent excellent performance.
6. Please do not sit, lean or step on the cabinet.
7. If any fixtures caused by abnormal reasons, Kohler China can supply paid replacement for service parts caused by abnormal reasons as shown in the service parts page in the limited duration of warranty.



### **警告！小心产品受损。**

1. 许多清洁剂都含有研磨剂及化学物质，不可用于清洁不锈钢、搪瓷、镀层或塑料制品。这些表面须使用温和的清洁剂或皂液进行清洁，将残余洗涤剂洗干净，然后用干净的软布擦干。
2. 卫生间请保持良好的通风状态，有条件的可以干、湿分离，平常尽量保持浴室空气畅通，养成开窗开门的习惯。
3. 科勒浴柜都经过严格的防潮处理，其良好的防潮性能可以保证在相对湿度很大的浴室里有良好的使用性，但使用时仍然不可以随意任浴柜被水浇、溅。所以请避免卫生间过于潮湿，遇有水迹要及时擦干。
4. 门板的保养：经常定期清洁、擦拭，洗浴后的冷凝水蒸气应用干燥的软干布擦净，保持门板的干爽
5. 照明灯电器连接要确保绝缘、防潮；镜面最好用麂皮经常擦拭，可以保障使用质量经久如一。
6. 请勿坐、倚靠、踩踏在浴柜上。
7. 科勒公司确保在担保期内，可以提供因非正常原因造成的如零件图中零件的有偿更换。