

安装步骤

如何安装淋浴杆

根据安装尺寸，在垂直面的墙壁选一合适的位置来安装淋浴柱。

根据胀塞(1)直径在垂直面的墙壁上钻孔，用于安装下方胀塞。将胀塞塞入孔中，用自攻钉(2)带垫片(3)固定底座(4)。

试装滑杆组件(5)，以确定上方胀塞安装位置。将底座(6)套在连接件(7)上，连接件伸入底座26毫米。用六角扳手(8)将螺钉(9)装入底座(6)，并锁紧。

将切换阀体(10)套在底座(4)上。将切换阀体和底座(6)紧贴墙壁放置。用铅笔标记底座(6)直径。拆下滑杆组件，用六角扳手旋松螺钉(9)(注意：切勿弄丢螺钉。)，拆下底座(6)。用铅笔标记底座(6)直径中心点位置。

根据胀塞(1)直径在中心点位置钻孔。将胀塞塞入孔中，用自攻钉(2)带垫片(3)固定底座(6)，确保底座(6)的两螺钉孔铅垂向下。

取下弯管组件(11)的保护套并扔掉，将弯管组件装入滑杆组件。用软布垫在螺母(12)的里孔和弯管组件之间，将螺母套入弯管组件。然后用带状扳手或用软布垫在普通扳手和螺母之间，将螺母旋紧到滑杆组件上。

将连接件(7)和切换阀体(10)同时装在底座上，使切换阀体紧贴墙面放置，连接件伸入底座(6)26毫米。

用六角扳手将螺钉(13)旋入切换阀体并锁紧。用六角扳手将螺钉(9)锁紧。

用软管(14)带垫片(15)连接混合水源与接头(16)。接头(17)用于接手持花洒。

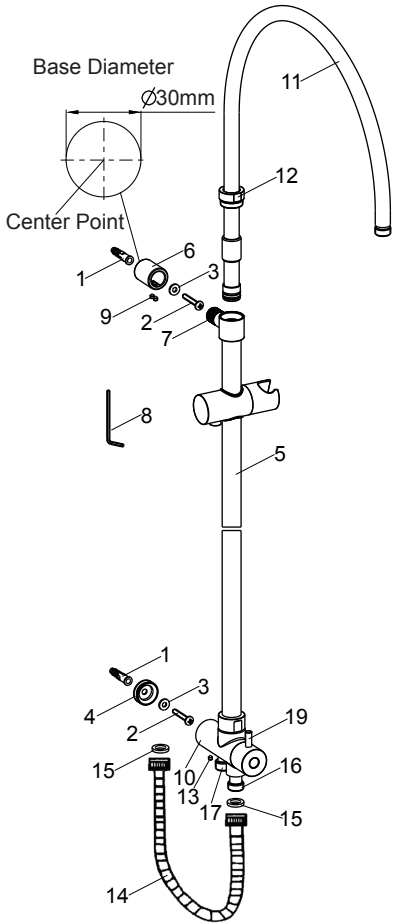

INSTALLATION

How To Install The Slide Bar

Select a location in vertical wall to install shower column according to rough-in dimensions.

Drill the lower hole to install a anchor as anchors(1) diameter in the vertical position in the finished wall. Press a anchor into the hole. Secure the base(4) by the self-tapping screw(2) with the washer(3).

Rehearse the slide bar kit(5) installation for the upper anchor mounting location determination. Slide the base(6) onto the connector(7) that insert into the base about 26mm. Screw the screws(9) into the base(6) with the hex wrench(8), and tighten them.

Install the diverter body(10) onto the base(4). Place the diverter body and the base(6) against the finished wall. Mark the diameter of the base(6) with a pencil. Remove the slide bar kit. Loosen the screws(9) with the hex wrench (**NOTE:** Don't lose the screws.), remove the base(6). Mark the center point of the base(6) diameter with a pencil.

Drill a hole on the center point as anchors(1) diameter. Press a anchor into the hole. Secure the base(6) by the self-tapping screw(2) with the washer(3), and make sure two screw holes of the base(6) vertically downwards.

Remove and discard the guard from the tube kit(11), then install it into the slide bar kit. Install the nut(12) onto the tube kit with soft cloth between internal hole of the nut and the tube kit. Then screw the nut onto the slide bar kit with strap wrench or soft cloth between the nut and regular wrench.

Install the connector(7) and the diverter body(10) to the base, and place the diverter body against the finished wall, and the connector insert into the base(6) about 26mm.

Screw the screw(13) into the diverter body with the hex wrench, and tighten it. Tighten the screws(9) with the hex wrench.

Connect the hose(14) to the mixer water supply, and to the connector(16) with the washers(15). The connector(17) will connect to handspray.

如何安装花洒头

装花洒头(18)之前使切换手柄(19)处于竖直向下位置，打开水源冲掉管路中的杂质。

将花洒头旋到弯管组件出水口上，用带状扳手锁紧。对于12966T、12967T和12969T，安装前需取出垫片(20)，按图示方向放入限流器(21)，然后装回垫片(20)。

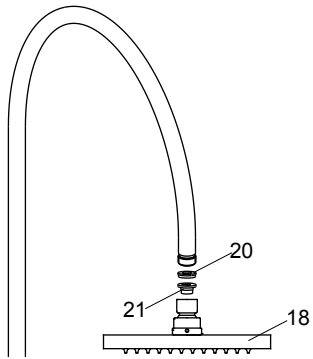

How To Install The Showerhead

Turn the diverter handle(19) to the vertical downwards and run hot and cold water for one minute to remove any debris before the showerhead(18) is installed.

Tighten the showerhead onto the tube kit outlet with strap wrench. For 12966T, 12967T and 12969T, before installation, take out the washer(20) and install the restrictor(21) as the figure shown, then reinstall the washer(20).

清洗说明

适用于所有加工处理过的表面：以中性肥皂水清洗镀层表面，再以干净的软布彻底擦干整个表面，许多清洁剂，比如氨水、去污粉及洁厕灵等，会对电镀表面造成伤害，切忌使用。

有磨损性的清洁用具或清洁剂也不可使用于科勒牌的水龙头及其配件上。

CLEANING INSTRUCTIONS

All Finishes: Clean the finish with mild soap and warm water. Wipe entire surface completely dry with clean soft cloth. Many cleaners may contain chemicals, such as ammonia, chlorine, toilet cleaner etc. which could adversely affect the finish and are not recommended for cleaning.

Do not use abrasive cleaners or solvents on Kohler faucets and fittings.